

MAINTENANCE- PUBLIC LAND SURVEY MONUMENT RECORD

TIE SHEET UPDATE-21605010000 (LA CROSSE COUNTY INDEX 50D)

I performed maintenance work for this corner on April 23, 2015. I found the Harrison marker of record at the corner in Kale road. I found 2 of W. Jung's ties and established 1 new tie as shown below.

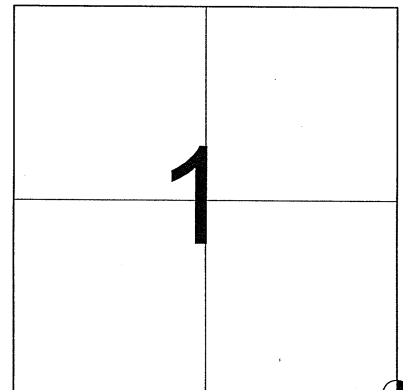



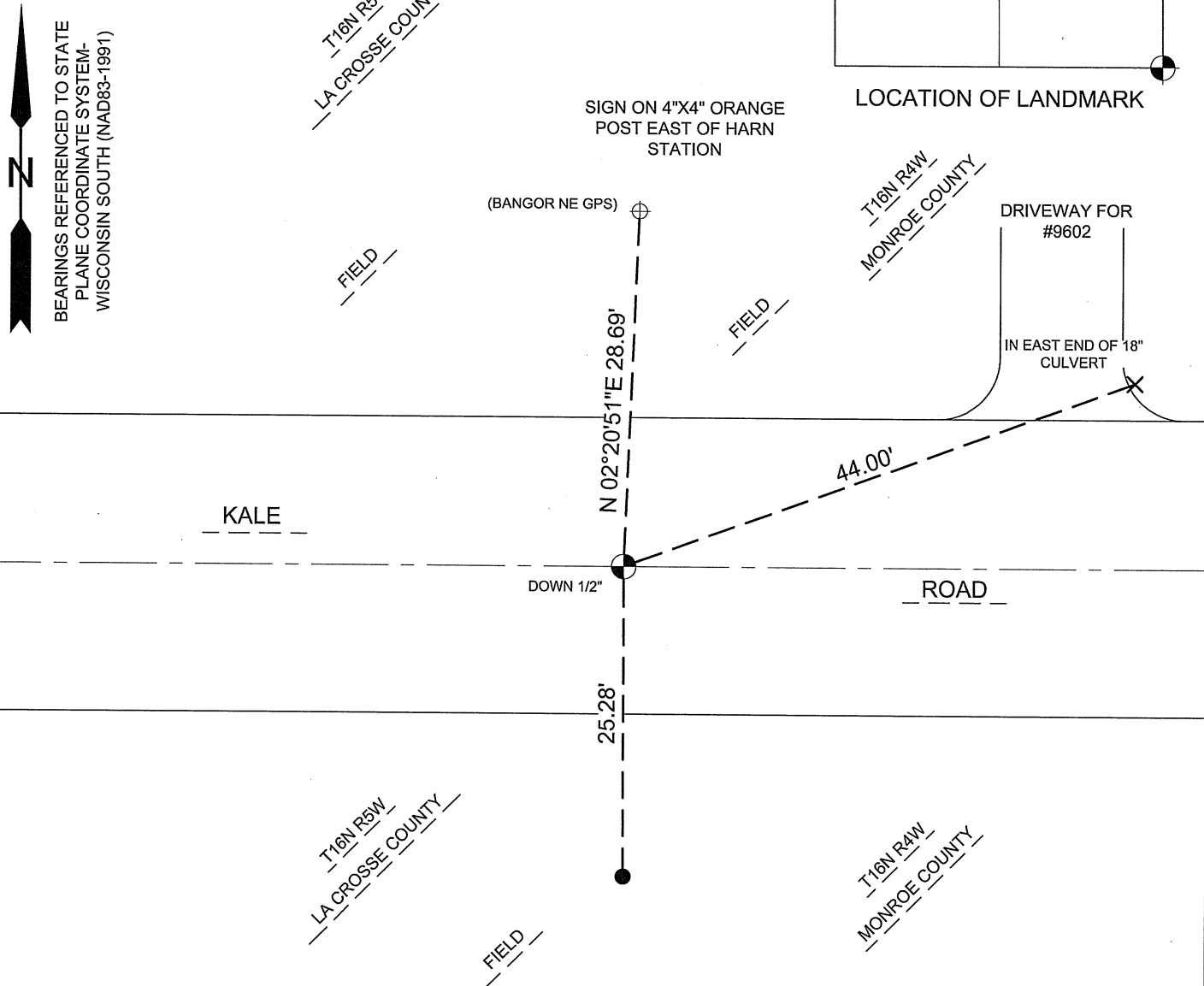

LOCATION OF LANDMARK

BEARINGS REFERENCED TO STATE
PLANE COORDINATE SYSTEM-
WISCONSIN SOUTH (NAD83-1991)



LEGEND

-  HARRISON MARKER
-  FOUND 3/4" IRON BAR
-  SET 3/8" DRILL HOLE
-  HARN STATION (BANGOR NE GPS)

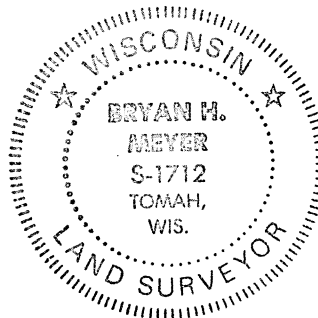

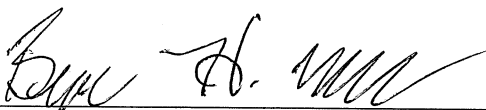
Bryan H. Meyer
La Crosse County Surveyor

4/30/2015
Date

U. S. PUBLIC LAND SURVEY MONUMENT RECORD

SECTION 1 T 16 N, R 5 W, TOWN OF BANGOR

LA CROSSE COUNTY

SW corner, Sec. 6 - T16N-R4W

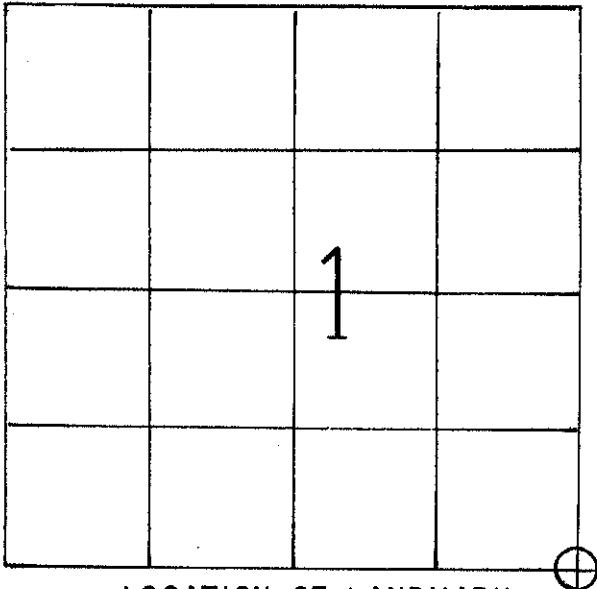

LOCATION OF LANDMARK

WISCONSIN COORDINATE SYSTEM
North
East
Theta Angle
Horiz. Order
Vert. Order
TYPE OF LANDMARK
Exist. Harrison marker.
BEARINGS ARE REFERENCED TO

Crew: William C. Jung
Peter F. Follansbee

Date: 10/12/93

Describe any record evidence, monument evidence, testimonial evidence or any other material evidence you considered and whether the monument was found or restored through acceptance of an obliterated evidence location.

I found a Harrison marker set by me in previous survey work and took new ties.

Describe or show any material discrepancy between the location of the restored corner and that of the corner previously restored or reestablished.

None Known.

11/3

I, William C. Jung, do hereby certify that on the 17th day of November 1981, I found (evidence) ~~(no evidence)~~ of the Southwest corner of Section 6, T16 N, R 4 W Fourth Principal Meridian, and I re-established said corner according to the Wisconsin Statutes as shown and described hereon.

Dated this 19th day of Nov. 1981.

William C. Jung

R. L. S. 1323
Title

William C. Jung

Description of corner and witness monuments, references and accessories used to perpetuate the original or re-established location of this corner:

Witnesses to corner location:

Jung
Dechant
Pietz

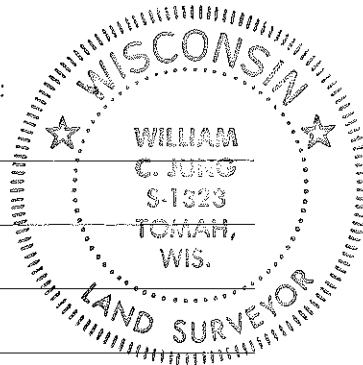

History of corner establishment since Original Government Survey

I used this point as the section corner in a survey done by myself in August of 1980.

Description of corner evidence found:

Found a railroad spike set by me at the occupied corner in August of 1980. Measurements to the North, West, and East indicate that this point fits the existing conditions very well. I accepted this occupied corner as the best available evidence of the original government corner.

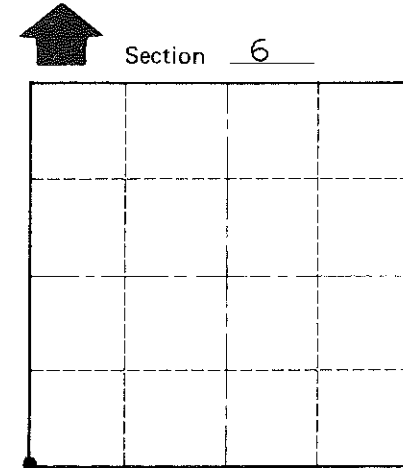
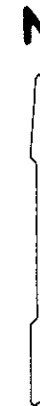
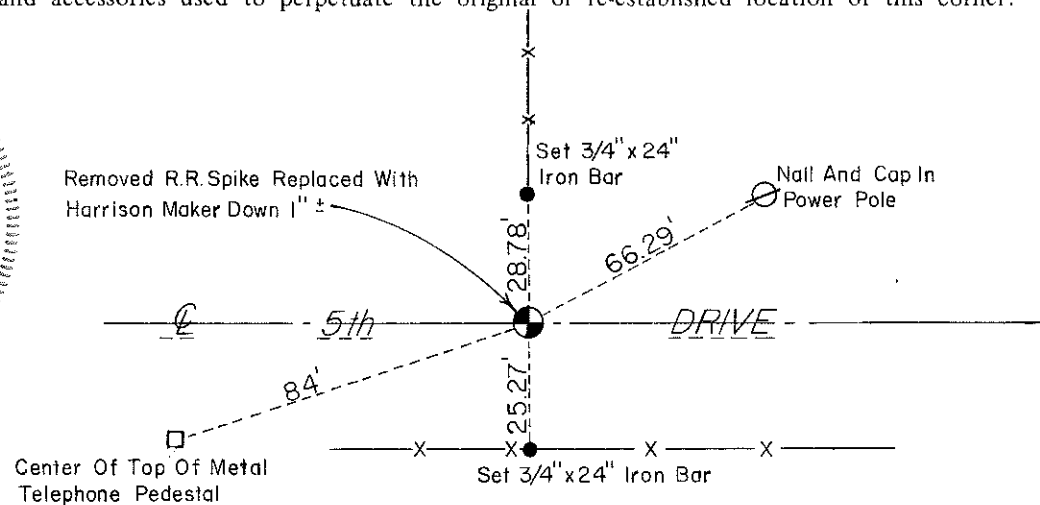

Section 6
T 16 N R 4 W
WISCONSIN

Approved: **HARLEY A. SIME**
MONROE CO. SURVEYOR

SURVEY CONTROL ORDER

Horizontal	_____
Vertical	_____

WISCONSIN COORDINATE SYSTEM

Corner	East (X)	North (Y)	Elevation (Z)	Zone
Control Sta. Name				

~~City Village~~ Town Leon
County of Monroe
Wisconsin

COUNTY SURVEYOR FORM NO. 1