

21604350000

I, Gary L. Dechant, do hereby certify that on the 12th day of December 1984, I found (evidence) (~~no evidence~~) of the NW corner of Section 1, T 15 N, R 4 W Fourth Principal Meridian, and I re-established said corner according to the Wisconsin Statutes as shown and described hereon.

Dated this 21st day of Dec. 1984.

Gary L. Dechant

Registered Land Surveyor, 1744
Title

History of corner establishment since Original Government Survey

A.S. Ingalls was here in April of 1873 when surveying in Section 2 and again in May of 1873 while working in Section 1.

Henry Schroeder found a stone at this corner in May of 1915.

Description of corner evidence found:

We found two stones that could have possibly have been the Stone Henry Schroeder found. One was lying on top of the ground approximately 10'± west of the fence corner, while the other was at the fence corner in the ground but lying flat. Both had the size and shape a surveyor would have set, but could not positively identify either of them as being the one and same stone Schroeder was referring too as they were not properly set as a surveyor would. Therefore, accepted the fence corner as the best available evidence as it fits conditions to the south well. The distance is about 50'± short of the Original Survey to the N¼ corner, either they dropped a chain or the steep hills gave them trouble.

Description of corner and witness monuments, references and accessories used to perpetuate the original or re-established location of this corner:

Witnesses to corner location:

Larry Feddersen, S-1226

Gary L. Dechant

COUNTY SURVEYOR FORM NO. 1

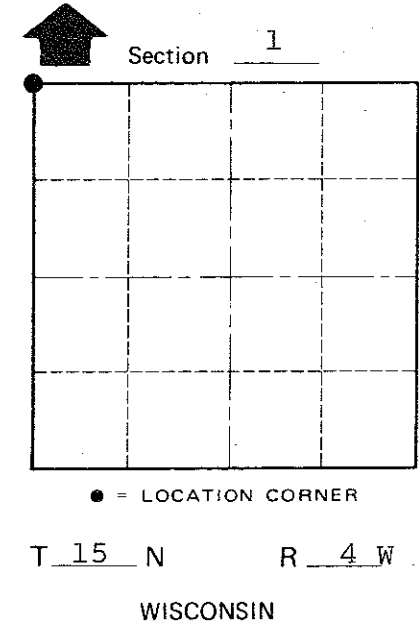
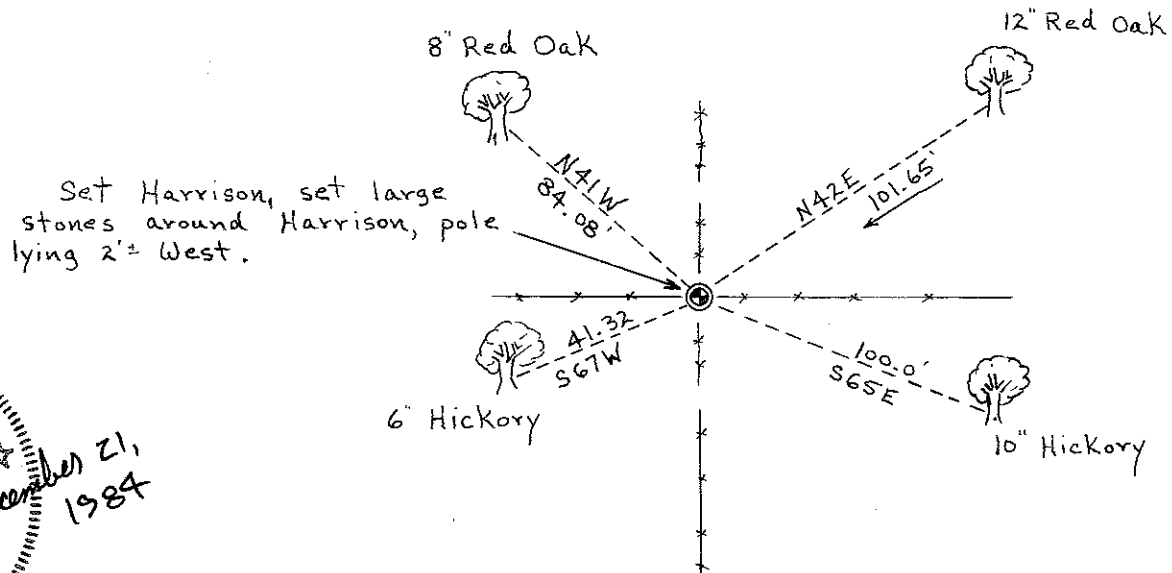

Gary L. Dechant
 WISCONSIN
 GARY L. DECHANT
 S-1744
 CAMP DOUGLAS, WI
 December 21, 1984
 LAND SURVEYOR

SURVEY CONTROL ORDER

Horizontal	_____
Vertical	_____

WISCONSIN COORDINATE SYSTEM

Corner	East (X)	North (Y)	Elevation (Z)	Zone
Control Sta. Name				

(Trees double blazed with N&C's)

City, Village or Town Portland

County of Monroe