

21604290020

I, Garold A. Sime, do hereby certify that on the 20<sup>th</sup> day of May 1983, I found (evidence) ~~(no evidence)~~ of the S/4 corner of Section 29, T 16 N, R 4W Fourth Principal Meridian, and I re-established said corner according to the Wisconsin Statutes as shown and described hereon.

Dated this 27<sup>th</sup> day of Jan. 1984.

Garold A. Sime  
Deputy County Surveyor  
Title

History of corner establishment since Original Government Survey

No recorded history since the Original Govt. Survey  
Town Road records call for the centerline of road to be 523 feet east of old road which was suppose to be on the forty line.

Description of corner evidence found:

I set this corner on line with the existing fence line to the east and in the centerline of the old road bed which is also the centerline of the power line.

Description of corner and witness monuments, references and accessories used to perpetuate the original or re-established location of this corner:

Witnesses to corner location:

Garold A. Sime  
Dallas Wilhite  
Bryan Meyer

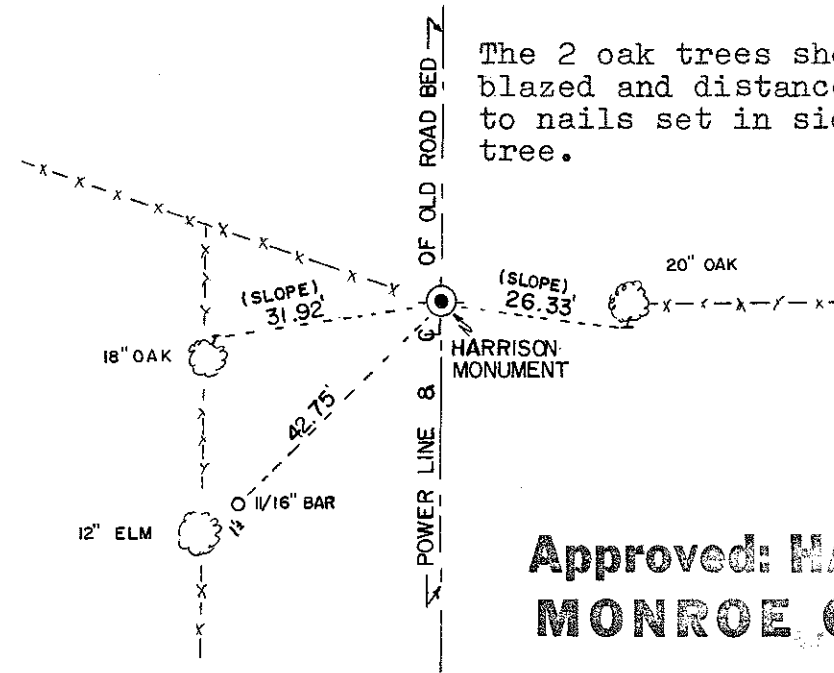
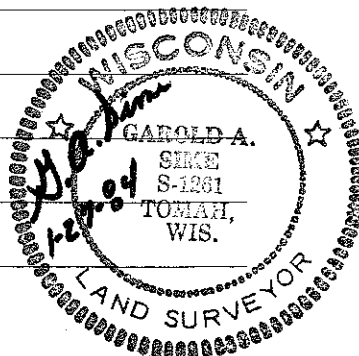

The 2 oak trees shown are blazed and distances are to nails set in side of tree.

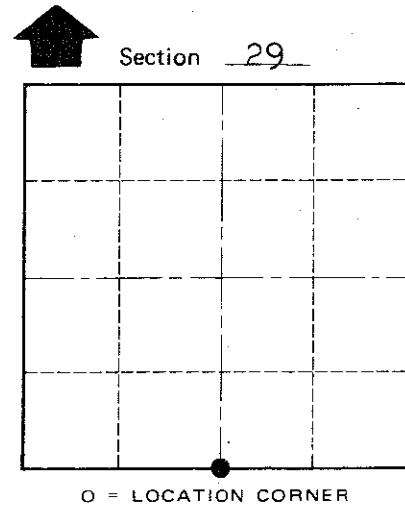
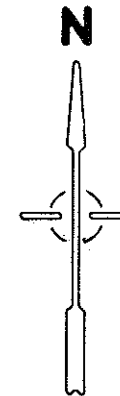

T 16 N R 4 W  
WISCONSIN

Approved: **HARLEY A. SIME**  
**MONROE CO. SURVEYOR**

COUNTY SURVEYOR FORM NO. 1

SURVEY CONTROL ORDER

Horizontal \_\_\_\_\_  
Vertical \_\_\_\_\_

WISCONSIN COORDINATE SYSTEM

Corner	East (X)	North (Y)	Elevation (Z)	Zone
Control Sta. Name				

City, Village or Town of Leon  
County of Monroe