

21604280000

I, William C. Jung, do hereby certify that on the 11th day of February 1982, I found (evidence) ~~(no evidence)~~ of the S.W. Cor. corner of Section 27, T 16 N, R 4 W Fourth Principal Meridian, and I re-established said corner according to the Wisconsin Statutes as shown and described hereon.

Dated this 17th day of Feb. 1982.

William C. Jung, R.L.S. 1323

County Surveyor's Office

Title

*William C. Jung*

Description of corner and witness monuments, references and accessories used to perpetuate the original or re-established location of this corner:

Witnesses to corner location:

W. Jung

G. Dechant

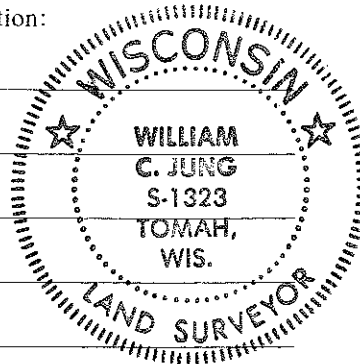

History of corner establishment since Original Government Survey  
Schroeder (Kenyon) was at this corner in June of 1886 and found the corner to be existing. Fred Holden found the original corner at this point in December of 1906. Duke Marten set a 1 1/4" I.B. at the occupied corner in Sept. of 1974. Larry Feddersen's map of Oct., 1978 shows that he set an I.B. at this corner. Greg Hofmeister used an I.B. for the corner in a survey of Dec., 1981.

Description of corner evidence found:

Found a 1 1/4" round I.B. at the occupied section corner. Accepted this monument and the fence corner as the best available evidence of the original govt. corner.

Distance to tree face just above lower blaze

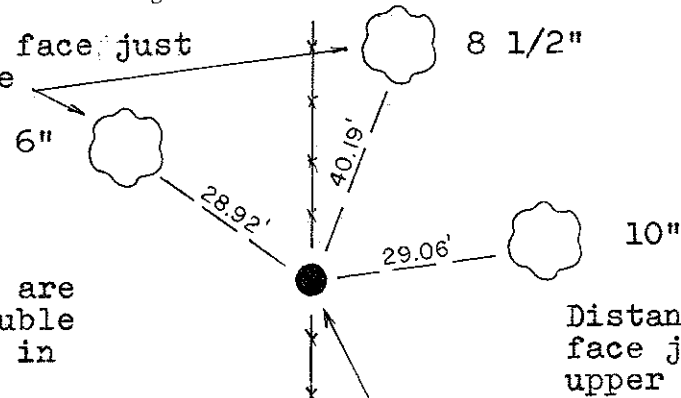

Note: All B.T.'s are hickories and double blazed with nail in lower blaze.

Distance to tree face just below upper blaze

Good Fence

Found 1 1/4" round I.B., up 1/2", 6"+ south of large post used to tie the north-south fence together. Ground was frozen so could not set Harrison.

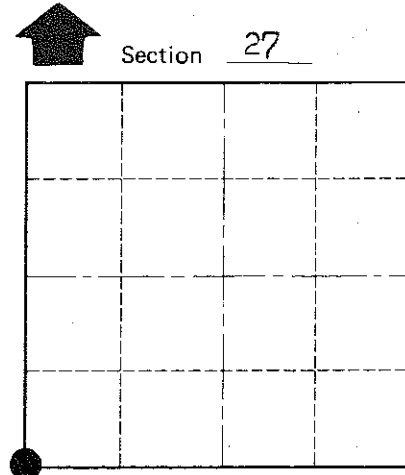

O = LOCATION CORNER

T 16 N R 4 W

WISCONSIN

SURVEY CONTROL ORDER

Horizontal	_____
Vertical	_____

Approved by: Harley A. Sime  
County Surveyor

WISCONSIN COORDINATE SYSTEM

Corner	East (X)	North (Y)	Elevation (Z)	Zone
Control Sta. Name				

City, Village or Town Leon

County of Monroe

COUNTY SURVEYOR FORM NO. 1