

CERTIFICATE

I, Lawrence A. Feddersen, do hereby certify that on the 30th day of September 1982, I found (evidence) (~~removed~~) of the S $\frac{1}{4}$  corner of Section 25, T 16 N, R 4 W Fourth Principal Meridian, and I re-established said corner according to the Wisconsin Statutes as shown and described hereon.

Dated this 20th day of Oct. 1982.

*Lawrence A. Feddersen*

Registered Land Surveyor #1226  
Title

CERTIFIED LAND CORNER

No. 102

**21604250020**

History of corner establishment since Original Government Survey

Henry F. Schroeder was here in May of 1915.

Description of corner evidence found:

Set corner by Henry F. Schroeder's recorded bearings and distances from his White Oak bearing trees which we found.

Approved: **HARLEY A. SIME**  
**MONROE CO. SURVEYOR**

Description of corner and witness monuments, references and accessories used to perpetuate the original or re-established location of this corner:

Witnesses to corner location:

Lawrence A. Feddersen

Gary L. Dechant  $\frac{D}{A}$

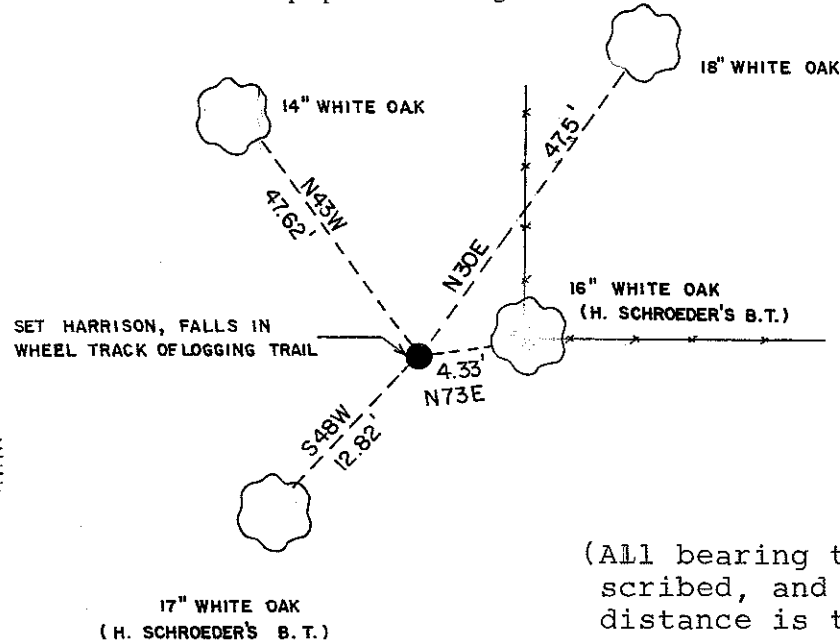
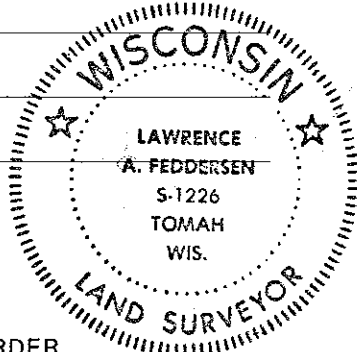

(All bearing trees are double blazed, scribed, and with N&C in side of tree, distance is to N&C)

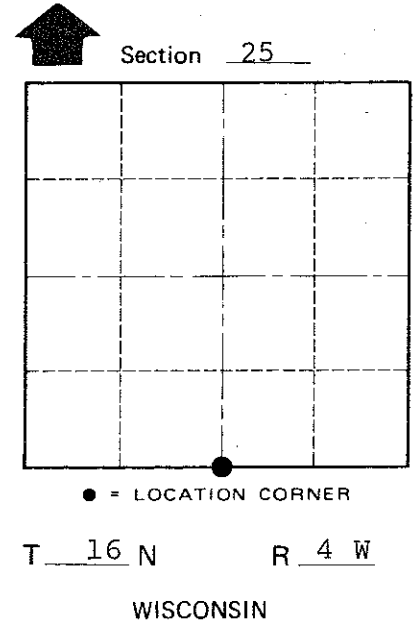

COUNTY SURVEYOR FORM NO. 1

SURVEY CONTROL ORDER

Horizontal	_____
Vertical	_____

WISCONSIN COORDINATE SYSTEM

Corner	East (X)	North (Y)	Elevation (Z)	Zone
Control Sta. Name				

~~City, Village~~ Town Leon  
County of Monroe