

CERTIFICATE

CERTIFIED LAND CORNER

No. 79

21604232000

I, William C. Jung, do hereby certify that on the 13th day of April 1978, I found (evidence) (~~no evidence~~) of the W^{1/4} corner of Section 24, T16 N, R4 W Fourth Principal Meridian, and I re-established said corner according to the Wisconsin Statutes as shown and described hereon.

History of original corner establishment:

Fred Holden set a stone here in May of 1903.

Description of corner evidence found:

Found stone, as Duane Marten, R.L.S. 1029, also did in October of 1972. Placed iron bar over stone.

Dated this 5th day of Jan. 1979.

William C. Jung, R.L.S. 1323
Crew Chief, County Surveyor's
Office

COUNTY SURVEYOR FORM NO. 1

Description of corner and witness monuments, references and accessories used to perpetuate the original or re-established location of this corner:

Witnesses to corner location:

W. Jung

G. Dechant

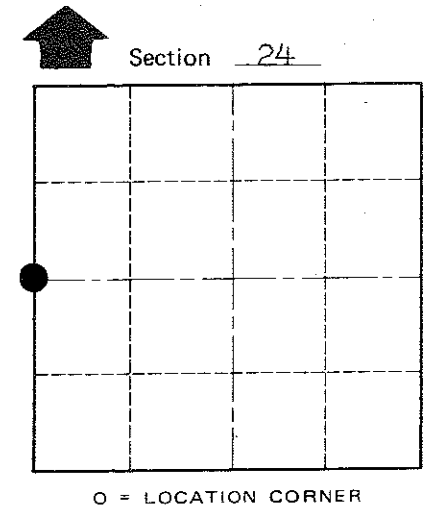
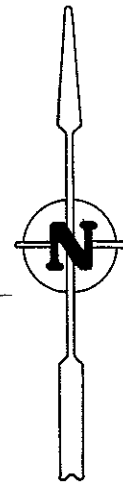
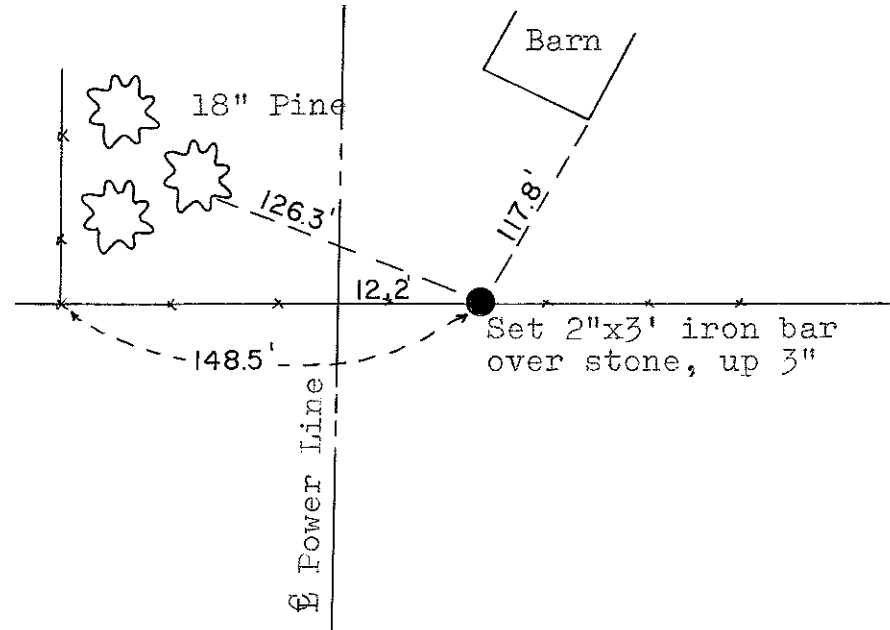
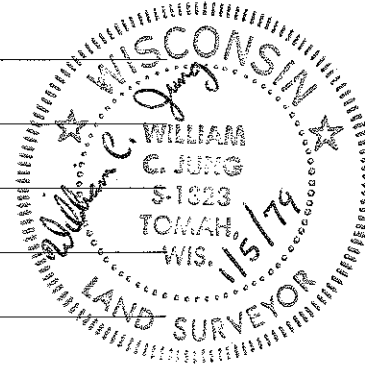

T 16 N R 4 W
WISCONSIN

SURVEY CONTROL ORDER

Horizontal	_____
Vertical	_____

Approved by: Harley A. Sime
County Surveyor

WISCONSIN COORDINATE SYSTEM

Corner	East (X)	North (Y)	Elevation (Z)	Zone
Control Sta. Name				

City, Village or Town Leon

County of Monroe