

CERTIFICATE

I, Bryan H. Meyer, do hereby certify that on the 21st day of May 19 93, I found (evidence) ~~(no evidence)~~ of the South 1/4 corner of Section 22, T 16 N, R 4 W Fourth Principal Meridian, and I re-established said corner according to the Wisconsin Statutes as shown and described hereon.

Dated this 24th day of May 19 93.

Bryan H. Meyer

Deputy County Surveyor
Title

CERTIFIED LAND CORNER

History of corner establishment since Original Government Survey

Webster Kenyon was here in April of 1888. Fred Holden was here in July of 1901.

Description of corner evidence found:

I accepted the occupied fence corner as the best available evidence.

No. 86

21604220020

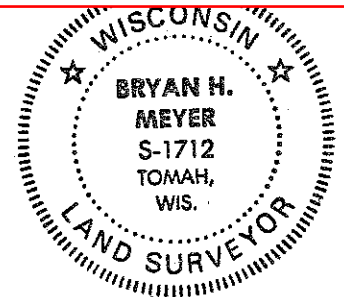

Bryan H. Meyer
H. A. Sime and Associates
P. O. Box 705
Tomah, Wisconsin 54660
Phone: (608)-372-5392

COUNTY SURVEYOR FORM NO. 1

Description of corner and witness monuments, references and accessories used to perpetuate the original or re-established location of this corner:

Crew: Meyer, Lobe
Date: May 21, 1993
Weather: Partly Cloudy, 65°±.
Witnesses to corner location:

Bryan H. Meyer

Rick Lobe

Set pipe in wet ground, up 2.3 feet. Set sign 1'± South of pipe facing North.

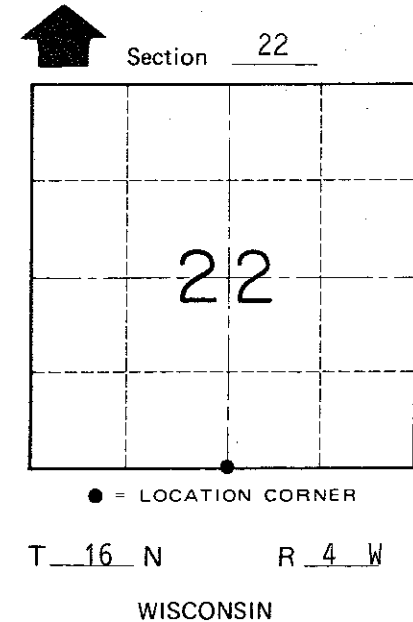
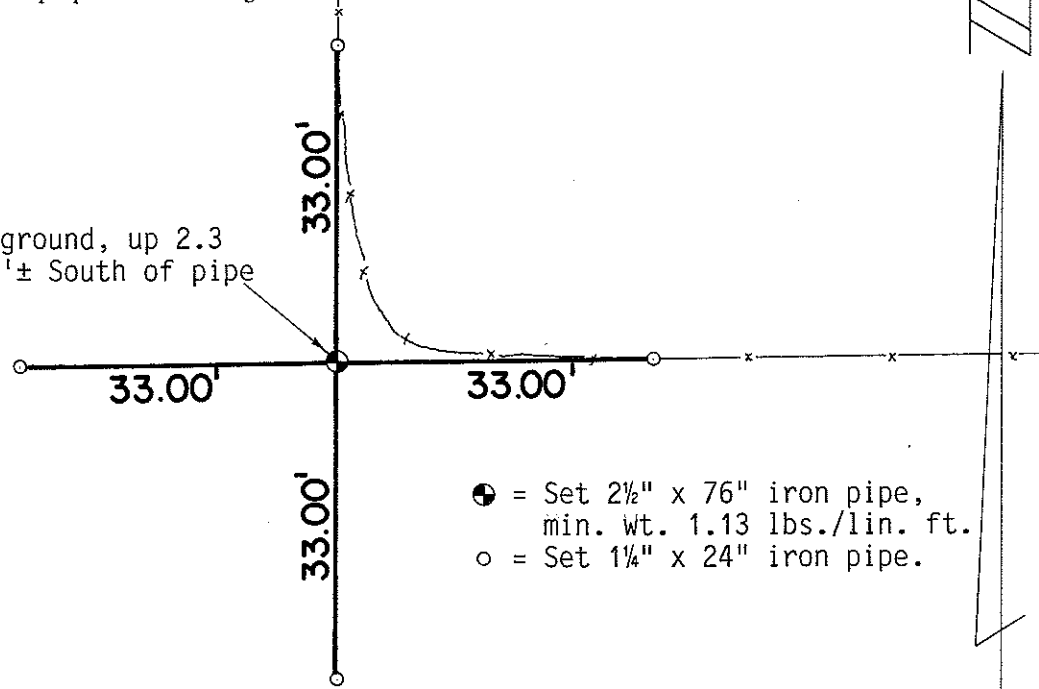

SURVEY CONTROL ORDER

Horizontal	_____
Vertical	_____

WISCONSIN COORDINATE SYSTEM

Corner	East (X)	North (Y)	Elevation (Z)	Zone
Control Sta. Name				

~~Village of~~ Town of Leon
County of Monroe