

CERTIFICATE

CERTIFIED LAND CORNER

No. 56

**21604172000**

I, Gary L. Dechant, do hereby certify that on the 26th day of March 1986, I found (evidence) ~~(no evidence)~~ of the W<sup>1</sup>/<sub>4</sub> corner of Section 16, T 16 N, R 4 W Fourth Principal Meridian, and I re-established said corner according to the Wisconsin Statutes as shown and described hereon.

Dated this 31st day of MARCH 1986.

Gary L. Dechant  
Registered Land Surveyor-1744  
Title

History of corner establishment since Original Government Survey

Fred Holden was here in Nov. of 1906. He was here again in Dec. of 1909 and set a stone at this corner.

O. Bergman was here in May of 1930 and found Holden's bearing tree of record and states corner falls in fence corner. He makes no mention of finding Holden's stone.

Description of corner evidence found:

We could not find Holden's stone nor his B.T.

Since Bergman makes no mention of finding the stone in his survey of 1930, assume the stone is no longer.

Accepted fence corner as best available evidence, judging by the wire it is probable it could be the same fence when Bergman was here.

Description of corner and witness monuments, references and accessories used to perpetuate the original or re-established location of this corner:

Cloudy & Warm

Witnesses to corner location:

Claire Noble

Gary Dechant

COUNTY SURVEYOR FORM NO. 1

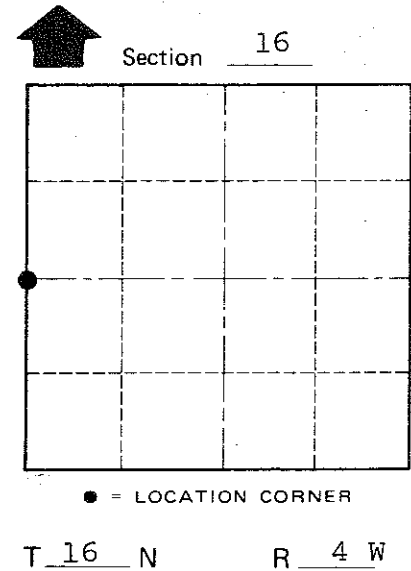
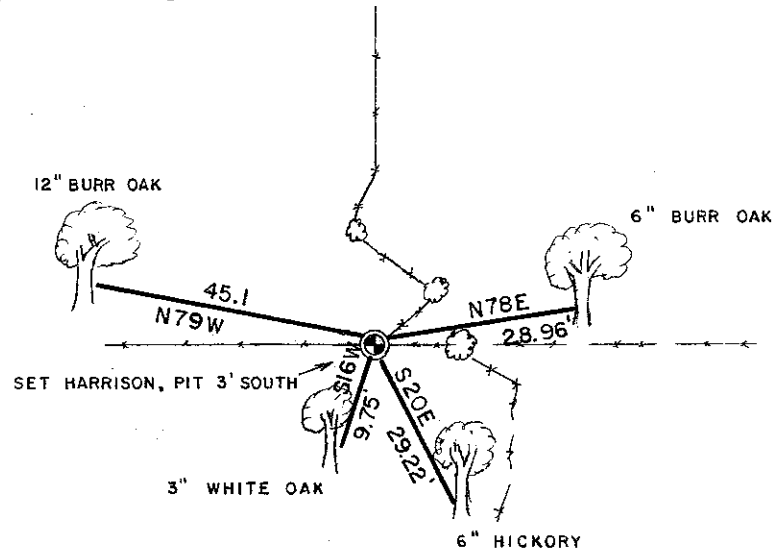
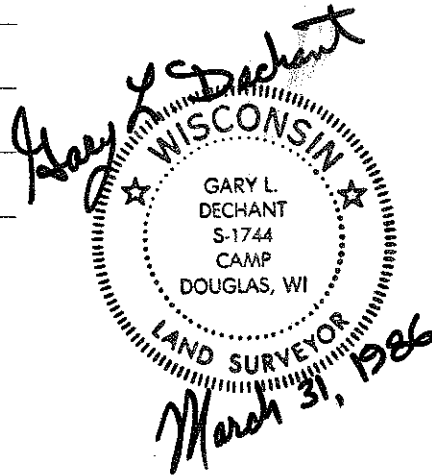

● = LOCATION CORNER

T 16 N R 4 W

(Trees double blazed with N&C's set)

SURVEY CONTROL ORDER

Horizontal \_\_\_\_\_  
Vertical \_\_\_\_\_

WISCONSIN COORDINATE SYSTEM

| Corner            | East (X) | North (Y) | Elevation (Z) | Zone |
|-------------------|----------|-----------|---------------|------|
| Control Sta. Name |          |           |               |      |

~~City/Village~~ Town Leon

County of Monroe