

21604162000

I, Lawrence A. Feddersen, do hereby certify that on the Fourteenth day of November 1990, I found (evidence) (no evidence) of the E 1/4 corner of Section 16, T 16 N, R 4W Fourth Principal Meridian, and I re-established said corner according to the Wisconsin Statutes as shown and described hereon.

Dated this 28th day of Nov. 1990.

Lawrence A. Feddersen

Registered Land Surveyor, S-1226

History of corner establishment since Original Government Survey

Fred Holden was here in November of 1906. O. Bergman was here in May of 1930. In his notes, states corner falls in center of road and in line with a fence.

Description of corner evidence found:

Set corner in line with the fence to the East and on line with the NE corner of Section 16 and the SE corner of the NE 1/4-SE 1/4 where we found Fred Holden's bearing tree of record. The corner falls 1.2' West of the present road as traveled.

Description of corner and witness monuments, references and accessories used to perpetuate the original or re-established location of this corner:

Witnesses to corner location:

- Claire Noble
Gary Dechant
Larry Feddersen
Tim Jeatran
Brian Bertram

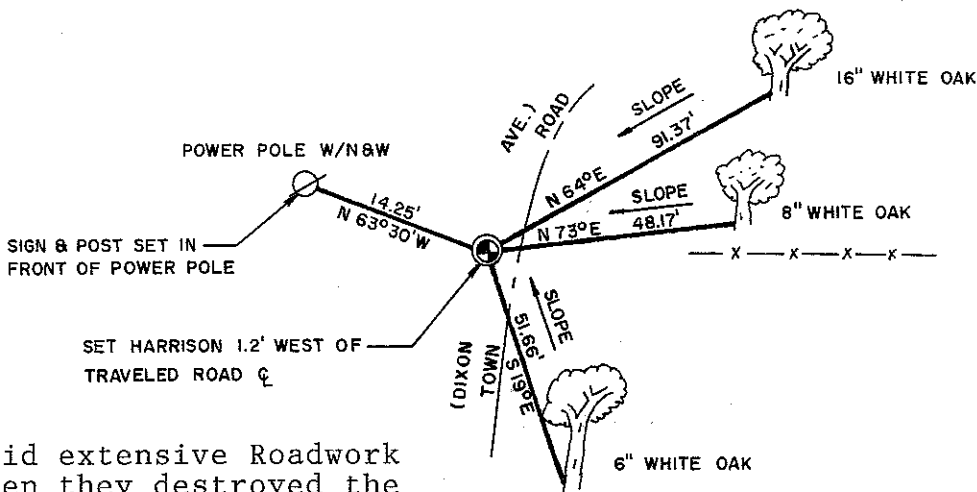

NOTE:

Town did extensive Roadwork in 1988, when they destroyed the Harrison Monument. Harrison was in 3 pieces, lying nearly horizontal. The new Harrison Monument was set by using the distances to the 3 existing bearing trees and from previous survey points.

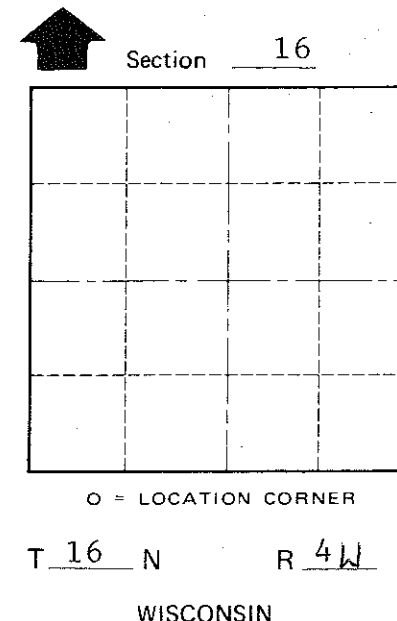

WISCONSIN COORDINATE SYSTEM

SURVEY CONTROL ORDER

Table with 2 rows: Horizontal, Vertical

Table with 5 columns: Corner, East (X), North (Y), Elevation (Z), Zone

(Trees double blazed with N&C set in Root)
City, Village or Town Leon
County of Monroe

COUNTY SURVEYOR FORM NO. 1

CERTIFICATE

CERTIFIED LAND CORNER

No. 57

Sec 2 Pg. 2

I, Gary L. Dechant, do hereby certify that on the 26th day of March 1986, I found (evidence) (~~no evidence~~) of the E¹/₄ corner of Section 16, T 16 N, R 4 W Fourth Principal Meridian, and I re-established said corner according to the Wisconsin Statutes as shown and described hereon.

Dated this 31st day of March 1986.

Gary L. Dechant

Registered Land Surveyor, S-1744
Title

History of corner establishment since Original Government Survey

Fred Holden was here in Nov. of 1906.
O. Bergman was here in May of 1930. In his notes states corner falls in center of road and in line with a fence.

Description of corner evidence found:

Set corner in line with the fence to the East and on line with the NE corner of Section 16 and the SE corner of the NE¹/₄-SE¹/₄ where we found Fred Holden's bearing tree of record. The corner falls 2'± West of the present road as travelled.

Description of corner and witness monuments, references and accessories used to perpetuate the original or re-established location of this corner:

Cloudy & Warm
MUDDY!

Witnesses to corner location:

Claire Noble

Gary Dechant

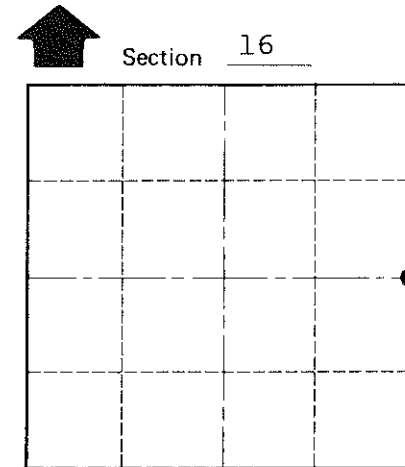
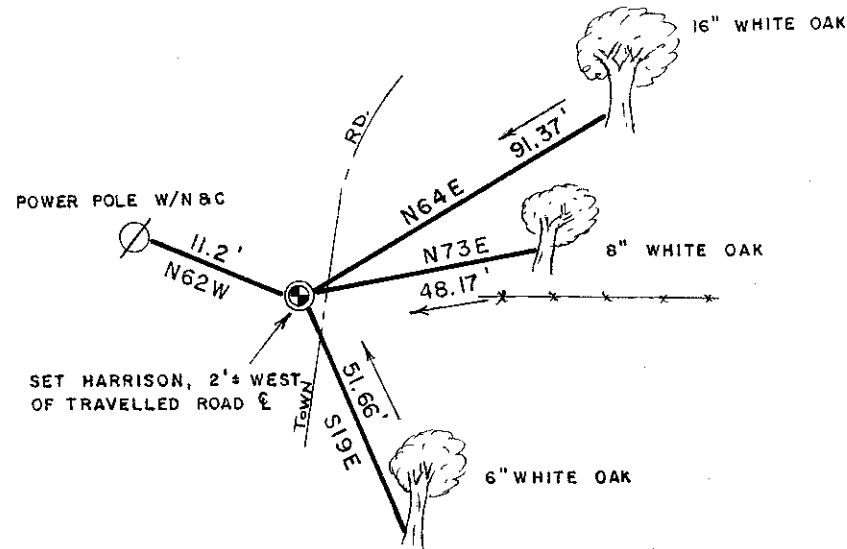
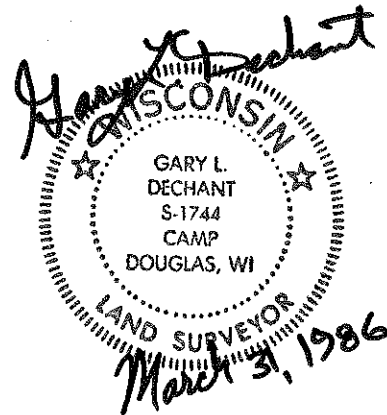

● = LOCATION CORNER

T 16 N R 4 W

WISCONSIN

(Trees double blazed with N&C set)

SURVEY CONTROL ORDER

Horizontal	_____
Vertical	_____

WISCONSIN COORDINATE SYSTEM

Corner	East (X)	North (Y)	Elevation (Z)	Zone
Control Sta. Name				

City, Village or Town Leon

County of Monroe

COUNTY SURVEYOR FORM NO. 1