

CERTIFICATE

CERTIFIED LAND CORNER

No. 61

21604130000

I, William C. Jung, do hereby certify that on the 21st day of April 1978, I found ~~(evidence)~~ (no evidence) of the NE corner of Section 24, T 16 N, R 4 W, Fourth Principal Meridian, and I re-established said corner according to the Wisconsin Statutes as shown and described hereon.

History of original corner establishment:

F. A. Holden was at this corner in December of 1899 and in May of 1906.

Dated this 5th day of Jan. 1979.

Description of corner evidence found:

Set the corner in the existing N-S fence, 2640 feet North of the E $\frac{1}{4}$ corner. Set as such, the corner best fits the overall conditions found in the NE $\frac{1}{4}$ of Section 24 after retracing the old occupied lines.

William C. Jung, R.L.S. 1323

Crew Chief, County Surveyor's
Title Office

COUNTY SURVEYOR FORM NO. 1

Description of corner and witness monuments, references and accessories used to perpetuate the original or re-established location of this corner:

Witnesses to corner location:

W. Jung

G. Dechant

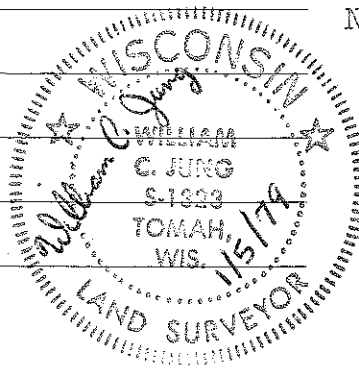

N&C in double blazed
14" Black Oak



N 72° W ±
SLOPE DIST. = 200.56'

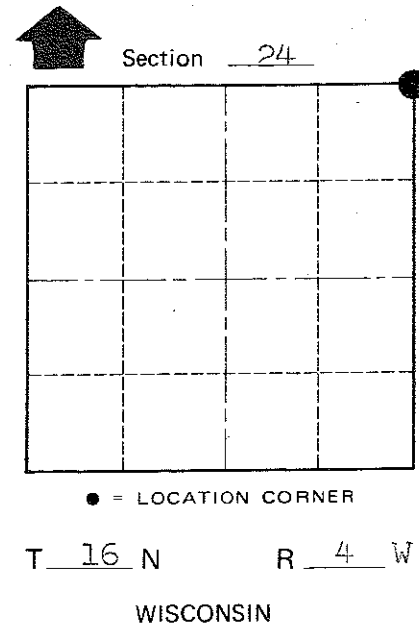
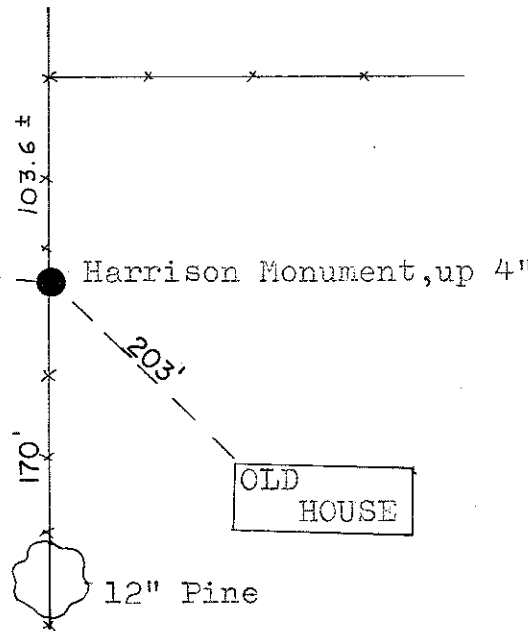

● = LOCATION CORNER

SURVEY CONTROL ORDER

Horizontal	_____
Vertical	_____

Approved by: Harley A. Sime
County Surveyor

WISCONSIN COORDINATE SYSTEM

Corner	East (X)	North (Y)	Elevation (Z)	Zone
Control Sta. Name				

City, Village or Town Leon
County of Monroe