

21604110000

I, Mark R. Heidecke, do hereby certify that on the 29th day of May 19 80, I found ~~evidence~~ (no evidence) of the Southwest corner of Section 12, T 16 N, R 4 W Fourth Principal Meridian, and I re-established said corner according to the Wisconsin Statutes as shown and described hereon.

Dated this 6th day of June 1980.

Mark R Heidecke

Registered Land Surveyor  
Title

History of corner establishment since Original Government Survey

After the Original U.S. Government Survey, Holden ran the East line of Section 11-T16N-R4W and found a tree at the corner in January of 1910.

Description of corner evidence found:

The tree which was mentioned by Holden no longer exists, and a Harrison monument was set over an old rotten fence cornerpost at the intersection of old fence lines to the North and West.

COUNTY SURVEYOR FORM NO. 1

Description of corner and witness monuments, references and accessories used to perpetuate the original or re-established location of this corner:

Witnesses to corner location:

Mark R. Heidecke

Lawrence Feddersen

HARRISON MONUMENT SET AT  
SOUTHWEST CORNER  
SECTION 12-T16N-R4W

Nail and Washer in Blaze  
in 7" Black Cherry

Nail and Washer in Blaze  
in 3" Burr Oak

Nail and Washer in Blaze  
in 6" Burr Oak

Nail and Washer in Blaze  
in 4" Burr Oak

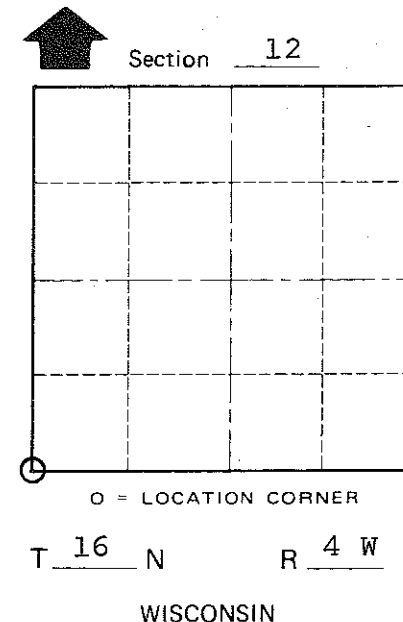
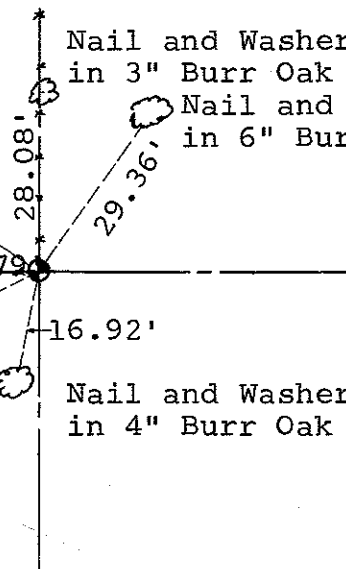

SURVEY CONTROL ORDER

Horizontal	_____
Vertical	_____

WISCONSIN COORDINATE SYSTEM

Corner	East (X)	North (Y)	Elevation (Z)	Zone
Control Sta. Name				

~~XXXXXX~~ Town OF LEON

County of MONROE