

21604010000

I, Mark R. Heidecke, do hereby certify that on the 29th day of May 19 80, I found ~~XXXXXX~~ (no evidence) of the Northeast corner of Section 12, T 16 N, R 4 W Fourth Principal Meridian, and I re-established said corner according to the Wisconsin Statutes as shown and described hereon.

Dated this 5th day of June 1980.

*Mark R. Heidecke*

Registered Land Surveyor

Title

History of corner establishment since Original Government Survey

After the Original U. S. Government Survey in Monroe County, Fred Holden ran the East line of Section 12-T16N-R4W and reestablished the corner.

Description of corner evidence found:

A Harrison monument was set on a straight line at a pro-rated distance between a Harrison monument found at the Northeast Corner of Section 1-T16N-R4W and a plow-moldboard found at the East Quarter Corner of Section 12. The corner mentioned by Holden was not found. It is assumed that it was graded out when the road was constructed.

Description of corner and witness monuments, references and accessories used to perpetuate the original or re-established location of this corner:

Witnesses to corner location:

Mark Heidecke

Lawrence Feddersen

Nail and Washer in Blaze in 8" Jack Pine

Nail and Washer in Blaze in 17" Red Oak

Nail and Washer in Blaze in 11" Red Oak

Nail and Washer in Blaze in 10" Red Oak

HARRISON MONUMENT SET AT NORTHEAST CORNER OF SECTION 12-T16N-R4W IN CENTERLINE

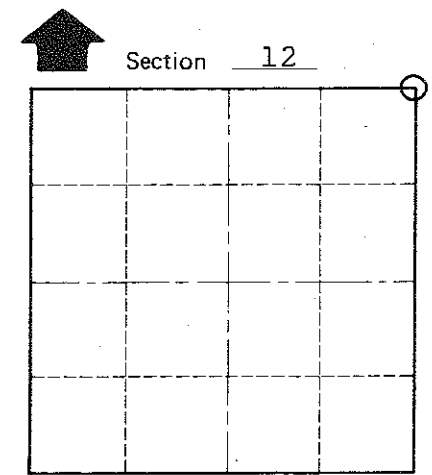
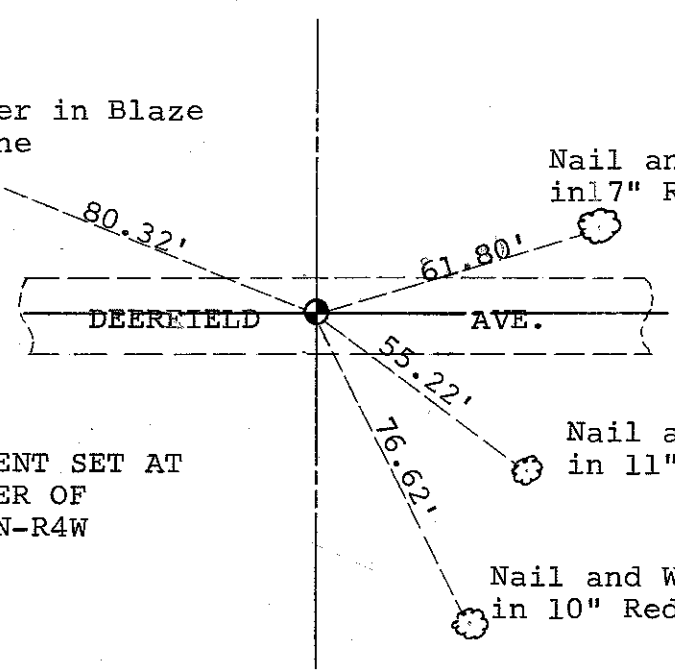

O = LOCATION CORNER

T 16 N R 4 W

WISCONSIN

COUNTY SURVEYOR FORM NO. 1

SURVEY CONTRL ORDER

Horizontal	_____
Vertical	_____

WISCONSIN COORDINATE SYSTEM

Corner	East (X)	North (Y)	Elevation (Z)	Zone
Control Sta. Name				

~~City of Leon~~ Town OF LEON  
County of MONROE