

21603340000

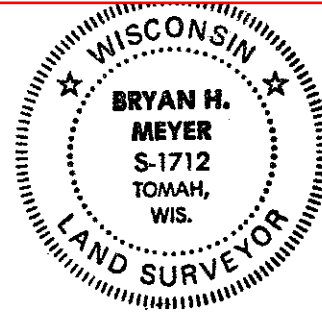

H. A. Sime and Associates
P. O. Box 705
Tomah, Wisconsin 54660
Phone: (608)-372-5392

I, Bryan H. Meyer, do hereby certify that on the 2nd day of May 19 91, I found (evidence) ~~to evidence~~ of the Northeast corner of Section 3, T 15 N, R 3 W Fourth Principal Meridian, and I re-established said corner according to the Wisconsin Statutes as shown and described hereon.

Dated this 22nd day of Aug. 19 91.

Bryan H. Meyer

Deputy County Surveyor
Title

History of corner establishment since Original Government Survey

Nothing recorded.

Description of corner evidence found:

I set this corner on line between the North 1/4 corner of Section 3 and the North 1/4 corner of Section 2 and on line with the fenceline projection from the South.

Description of corner and witness monuments, references and accessories used to perpetuate the original or re-established location of this corner:

Crew: Kenworthy, Forsythe

Date: May 2, 1991

Weather: Sunny, 70°±

Witnesses to corner location:

John Kenworthy

Brian Forsythe

Set cast iron Harrison marker 10'± West of fenceline. Set sign next to Harrison.

The four trees shown are double blazed; the distance to each is to a nail set in a hack in the side of each tree.

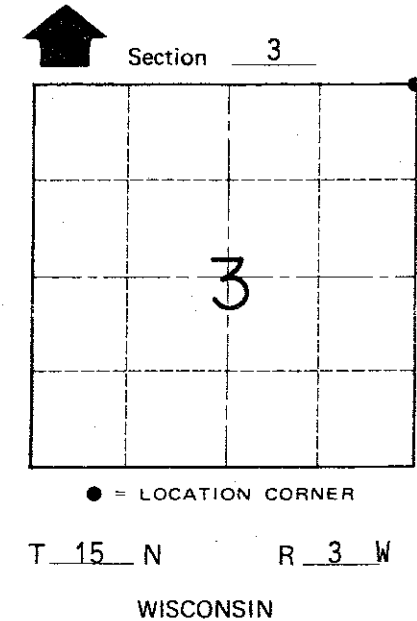
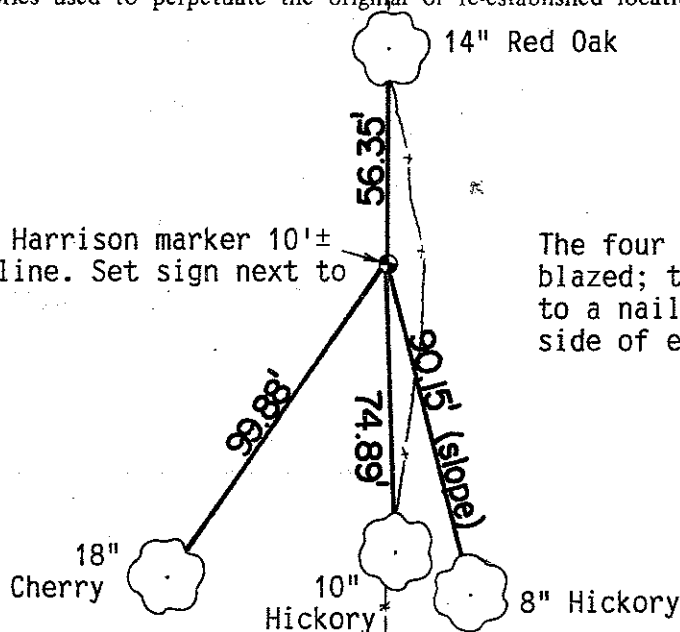

COUNTY SURVEYOR FORM NO. 1

SURVEY CONTROL ORDER

Horizontal _____
Vertical _____

WISCONSIN COORDINATE SYSTEM

Corner	East (X)	North (Y)	Elevation (Z)	Zone
Control Sta. Name				

~~City, Village or~~ Town of Jefferson

County of Monroe