

CERTIFICATE

CERTIFIED LAND CORNER

No. 116

21603322000

I, Garold A. Sime, do hereby certify that on the 12th day of November 1984, I found (evidence) (~~no evidence~~) of the E/4 corner of Section 32, T 16 N, R 3 W Fourth Principal Meridian, and I re-established said corner according to the Wisconsin Statutes as shown and described hereon.

Dated this 15th day of Nov. 1984.

Garold A. Sime

Garold A. Sime R.L.S. 1261
Title

History of corner establishment since Original Government Survey

Fred Holden was here in Oct. of 1911 and set a 3/4" pipe near the corner.

Description of corner evidence found:

I could not find Holdens pipe. I accepted the fence corner as best available evidence.

COUNTY SURVEYOR FORM NO. 1

Description of corner and witness monuments, references and accessories used to perpetuate the original or re-established location of this corner:

Set Harrison Monument at corner

Witnesses to corner location:

G.A. Sime

Jim Lund

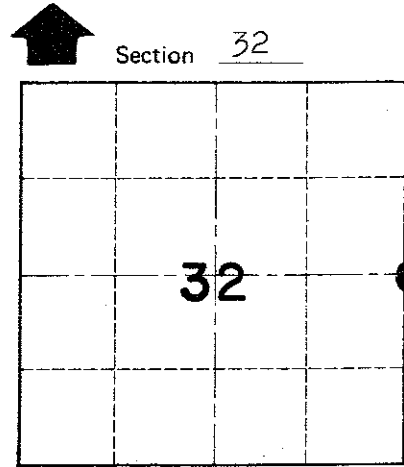
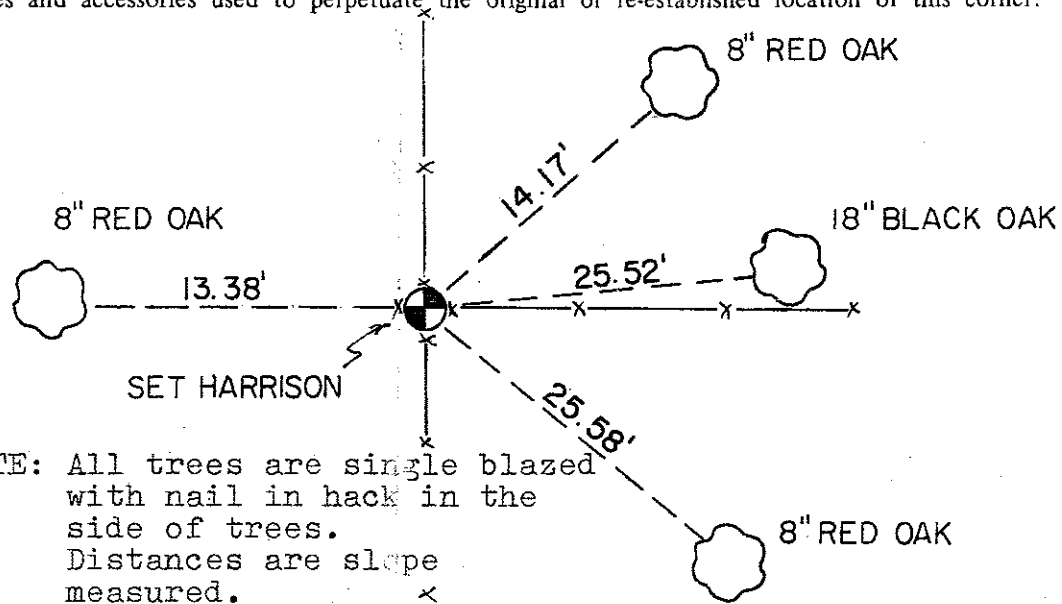
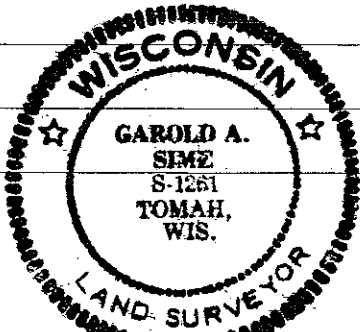

O = LOCATION CORNER
T 16 N R 3 W
WISCONSIN

SURVEY CONTROL ORDER

Horizontal	_____
Vertical	_____

WISCONSIN COORDINATE SYSTEM

Corner	East (X)	North (Y)	Elevation (Z)	Zone
Control Sta. Name				

City, Village or Town Wells
County of Monroe