

CERTIFICATE

CERTIFIED LAND CORNER

21603302000

No. 95

I, Bryan H. Meyer, do hereby certify that on the 16th day of November 1994, I found (no evidence) of the East 1/4 corner of Section 30, T 16 N, R 3 W Fourth Principal Meridian, and I re-established said corner according to the Wisconsin Statutes as shown and described hereon.

Dated this 30th day of Nov. 1994.

*Bryan H. Meyer*

Deputy County Surveyor  
Title

History of corner establishment since Original Government Survey

No recorded history.

Description of corner evidence found:

I re-established this corner on line with an existing fence line to the South and equidistant between the Northeast and Southeast corners of Section 30.

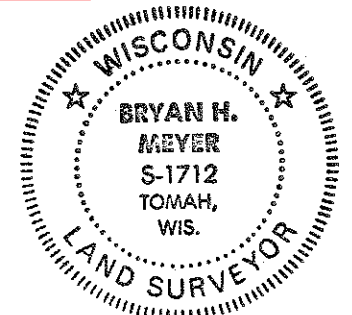

Bryan H. Meyer  
H. A. Sime and Associates  
P. O. Box 705  
Tomah, Wisconsin 54660  
Phone: (608)-372-5392

COUNTY SURVEYOR FORM NO. 1

Description of corner and witness monuments, references and accessories used to perpetuate the original or re-established location of this corner:

Crew: Meyer, Haberlin  
Date: November 16, 1994  
Weather: Overcast, 30°±

Witnesses to corner location:

Bryan H. Meyer

Harold Haberlin

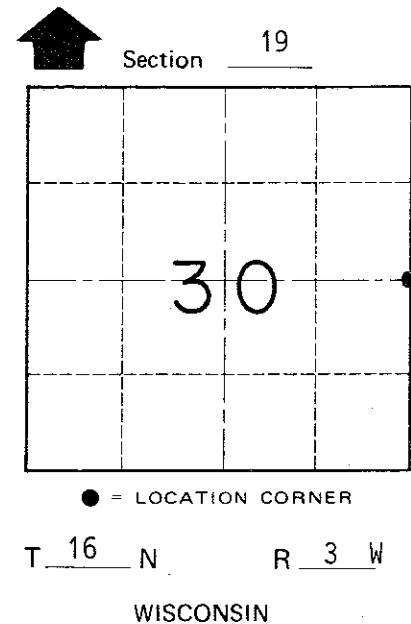
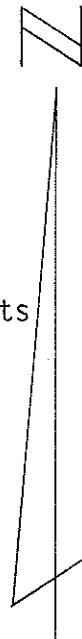
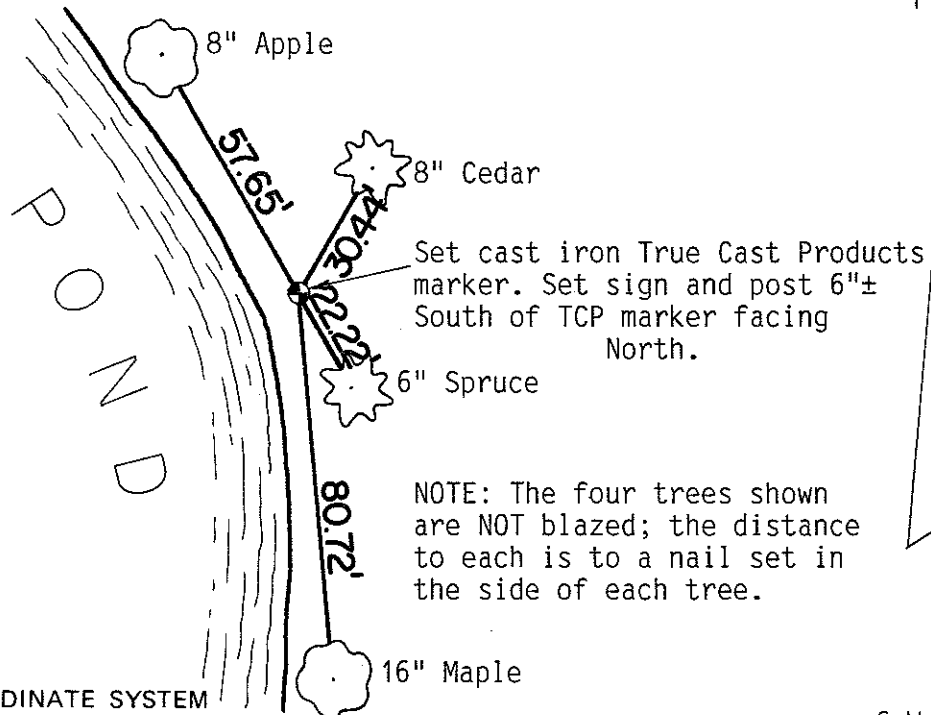

SURVEY CONTROL ORDER

Horizontal	_____
Vertical	_____

WISCONSIN COORDINATE SYSTEM

Corner	East (X)	North (Y)	Elevation (Z)	Zone
Control Sta. Name				

~~City/Village of~~ Town of Wells  
County of Monroe