

CERTIFICATE

CERTIFIED LAND CORNER

No. 110

21603290020

I, Garold A. Sime, do hereby certify that on the 1st day of May 1984, I found ~~(evidence)~~ (no evidence) of the NW corner of Section 32, T 16 N, R 3 W. Fourth Principal Meridian, and I re-established said corner according to the Wisconsin Statutes as shown and described hereon.

Dated this 28th day of Sept. 1984.

Garold A. Sime

Garold A. Sime, R.L.S. 1261
Title

History of corner establishment since Original Government Survey

H. A. Sime was at this corner in Aug. of 1961 and set an iron pipe at this corner.

Description of corner evidence found:

I could not find the iron pipe of record. I set this corner on line and at proportionate distance between the NW corner of Sec.32 and the NE corner of the NW $\frac{1}{4}$ -NE $\frac{1}{4}$

Description of corner and witness monuments, references and accessories used to perpetuate the original or re-established location of this corner:

Set Harrison Monument at corner

Witnesses to corner location:

G.A. Sime

Bryan Meyer

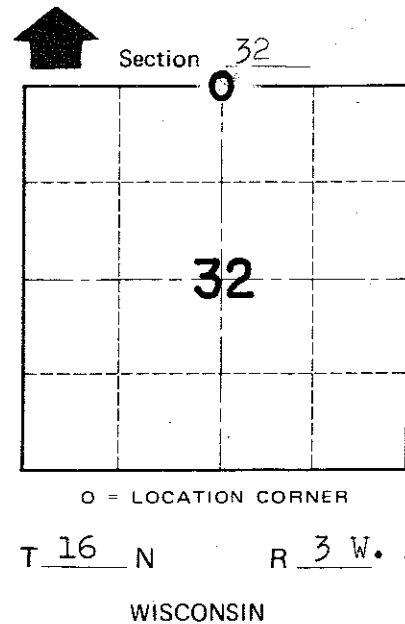
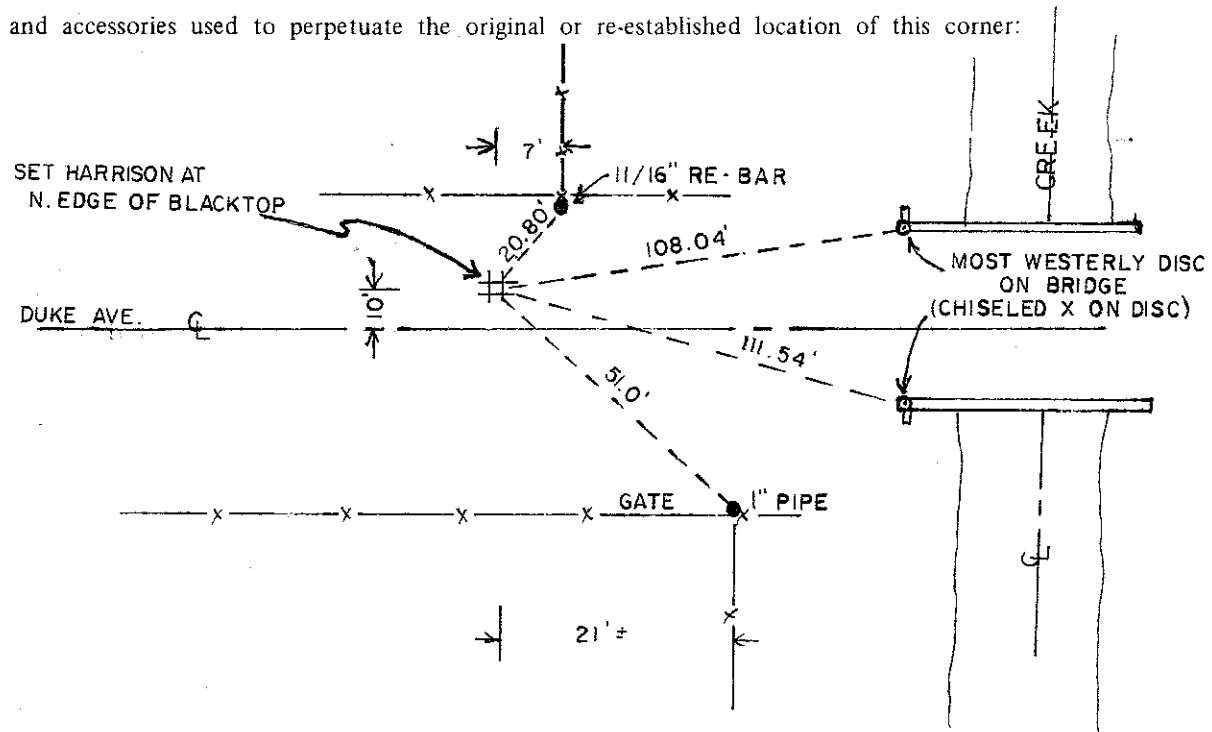

COUNTY SURVEYOR FORM NO. 1

SURVEY CONTROL ORDER

Horizontal _____
Vertical _____

WISCONSIN COORDINATE SYSTEM

Corner	East (X)	North (Y)	Elevation (Z)	Zone
Control Sta. Name				

City, Village or Town Wells
County of Monroe