

CERTIFICATE

CERTIFIED LAND CORNER

No. 97

21603282000

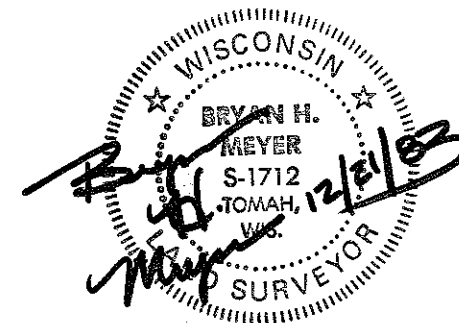

I, Bryan H. Meyer, do hereby certify that on the 1st day of April 1983, I found (evidence) ~~no evidence~~ of the West 1/4 corner of section 27, T 16 N, R 3 W Fourth Principal Meridian, and I re-established said corner according to the Wisconsin Statutes as shown and described hereon.

History of corner establishment since Original Government Survey

Nothing Recorded.

Description of corner evidence found:

Accepted intersection of fences as the best available evidence.

Dated this 21st day of Dec. 1983.

Bryan H. Meyer
Deputy County Surveyor
Title

COUNTY SURVEYOR FORM NO. 1

Description of corner and witness monuments, references and accessories used to perpetuate the original or re-established location of this corner:

Witnesses to corner location:

William C. Jung
Dallas Wilhite
Bryan H. Meyer

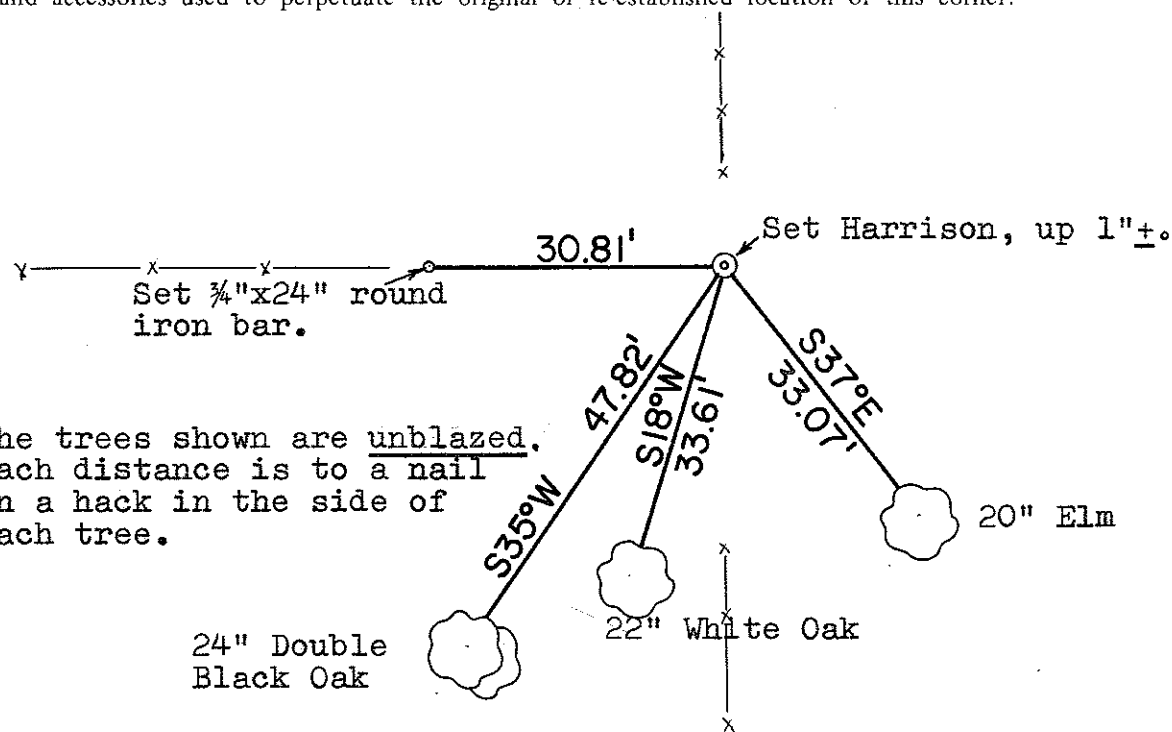

The trees shown are unblazed. Each distance is to a nail in a hack in the side of each tree.

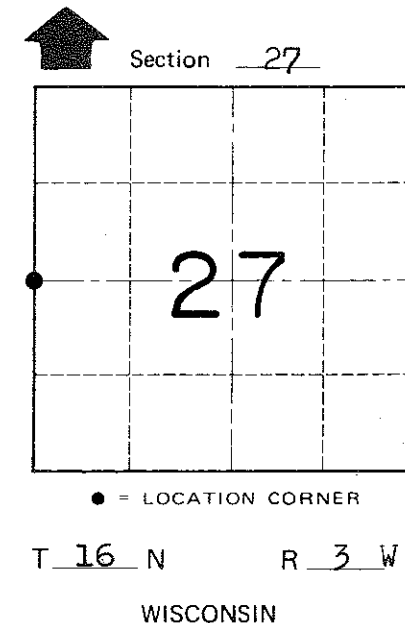

APPROVED: Harley A. Sime
Monroe County Surveyor

SURVEY CONTROL ORDER

Horizontal	_____
Vertical	_____

WISCONSIN COORDINATE SYSTEM

Corner	East (X)	North (Y)	Elevation (Z)	Zone
Control Sta. Name				

~~City, Village or~~ Town of Wells
County of Monroe