

21603272000

I, Bryan H. Meyer, do hereby certify that on the 1st day of April 19 83, I found (evidence) ~~XXXXXXXXXX~~ of the East 1/4 corner of Section 27, T 16 N, R 3 W Fourth Principal Meridian, and I re-established said corner according to the Wisconsin Statutes as shown and described hereon.

History of corner establishment since Original Government Survey

Henry Schroeder was here in October of 1893.

Description of corner evidence found:

Accepted 5"x7" treated post @ tie point in N-S fence as the best available evidence.

Dated this 21st day of Dec. 19 83.

Bryan H. Meyer
Deputy County Surveyor
Title

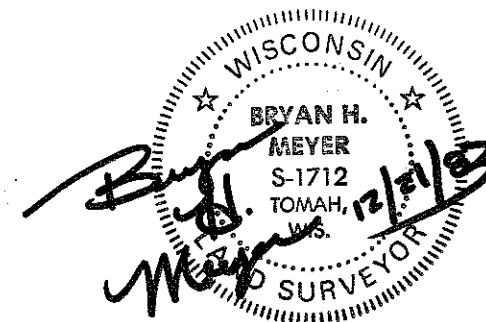

COUNTY SURVEYOR FORM NO. 1

Description of corner and witness monuments, references and accessories used to perpetuate the original or re-established location of this corner:

Witnesses to corner location:

Bryan H. Meyer
William C. Jung
Dallas Wilhite

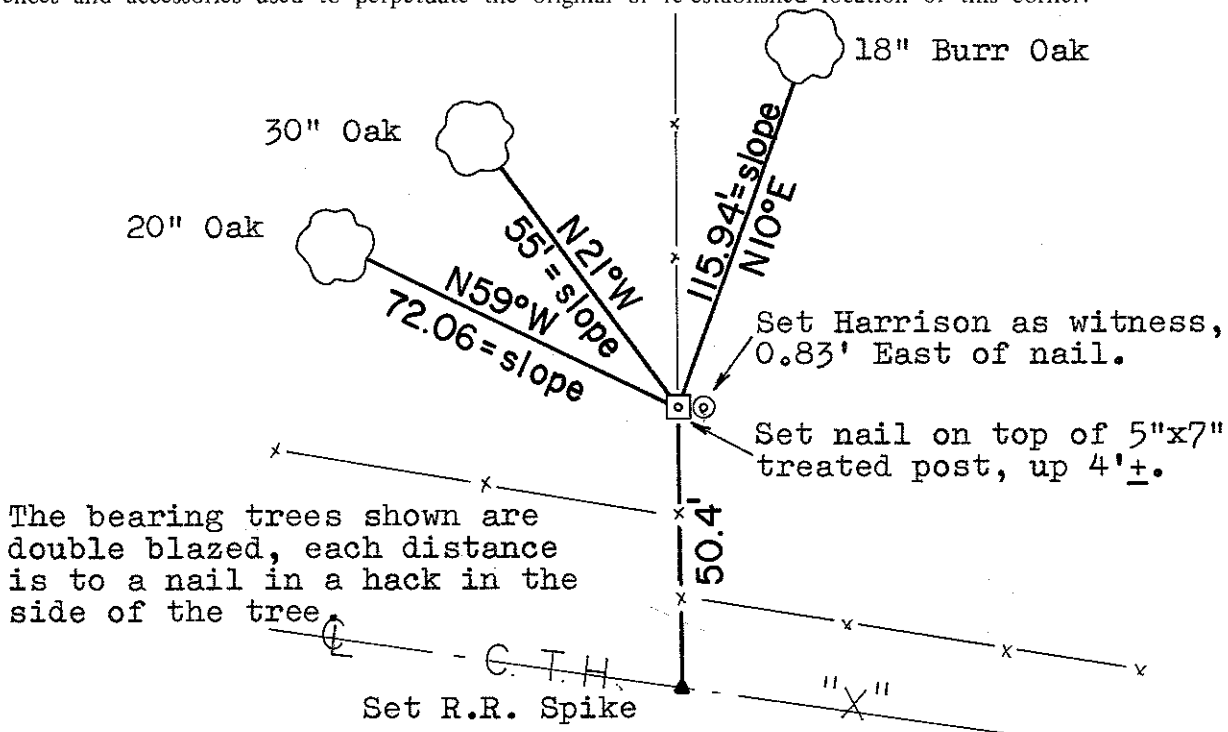

The bearing trees shown are double blazed, each distance is to a nail in a hack in the side of the tree

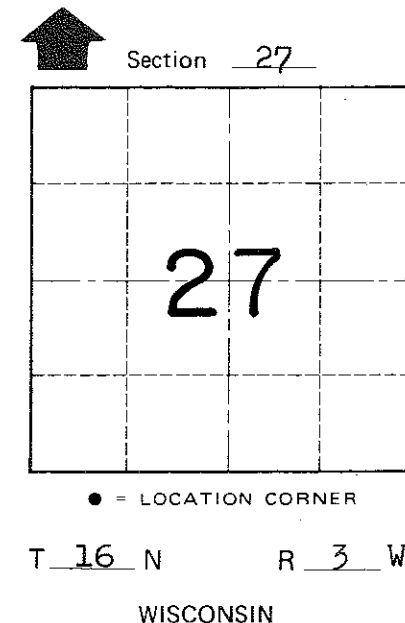

APPROVED: Harley A. Sime
Monroe County Surveyor

SURVEY CONTROL ORDER

Horizontal	_____
Vertical	_____

WISCONSIN COORDINATE SYSTEM

Corner	East (X)	North (Y)	Elevation (Z)	Zone
Control Sta. Name				

~~City/Village~~ Town of Wells
County of Monroe