

21603260020

I, Garold A. Sime, do hereby certify that on the 11th day of December 1990, I found (evidence) (~~XXXXXXXX~~) of the N¹ corner of Section 35, T 16 N, R 3 W Fourth Principal Meridian, and I re-established said corner according to the Wisconsin Statutes as shown and described hereon.

Dated this 21st day of Dec. 1990.

Garold A. Sime

Monroe County Surveyor
Title

History of corner establishment since Original Government Survey

No history of corner location since the Original Government Survey

Description of corner evidence found:

Accepted the existing fence corner as the best available evidence of corner location.

Description of corner and witness monuments, references and accessories used to perpetuate the original or re-established location of this corner:

- Set cast iron Harrison Monument at corner
- Set guard sign next to monument

Witnesses to corner location:

Garold A. Sime, R.L.S.

Bryan H. Meyer, R.L.S.

John Kenworthy

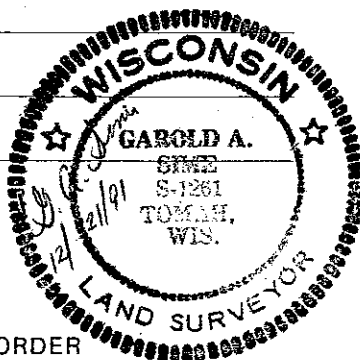
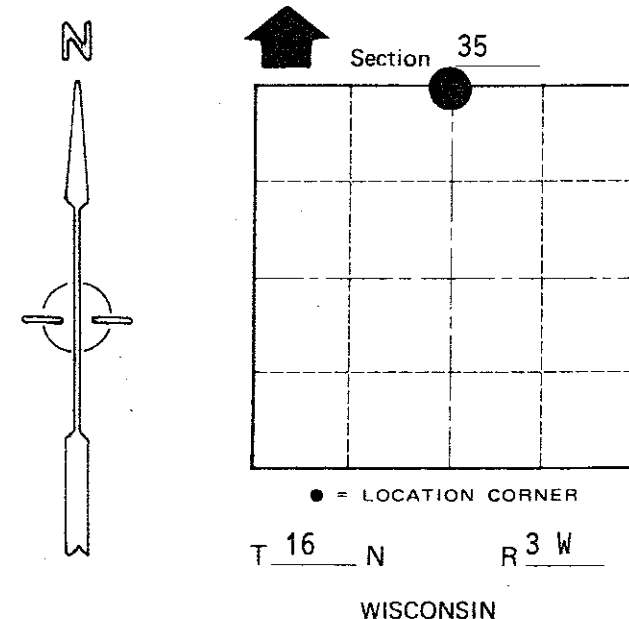
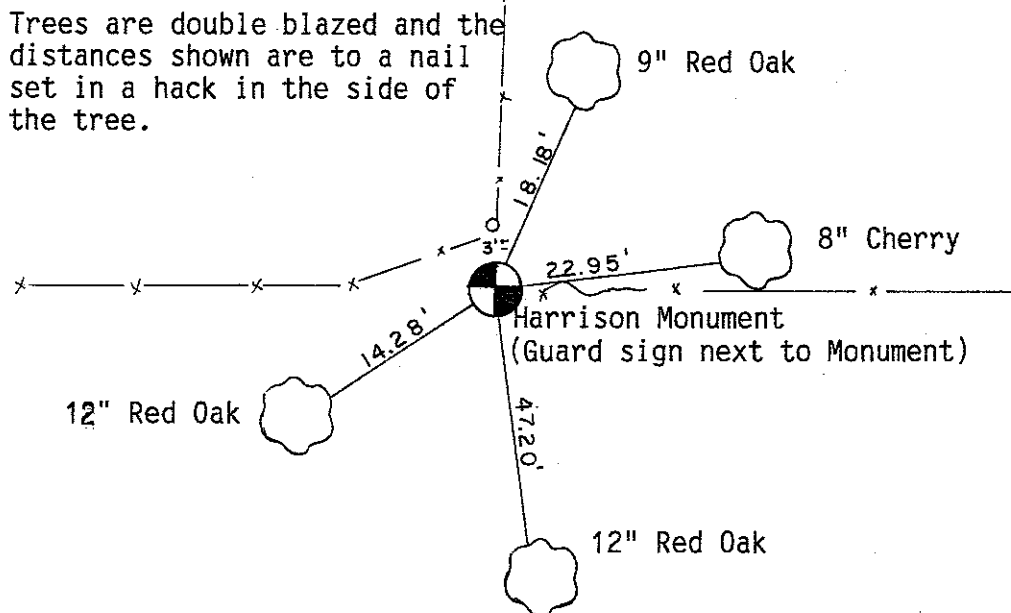

SURVEY CONTROL ORDER

Horizontal	_____
Vertical	_____

WISCONSIN COORDINATE SYSTEM

Corner	East (X)	North (Y)	Elevation (Z)	Zone
Control Sta. Name				

City, Village or Town of Wells
County of Monroe

COUNTY SURVEYOR FORM NO. 1