

CERTIFICATE

CERTIFIED LAND CORNER

No. 100

21603252000

I, Garold A. Sime, do hereby certify that on the 7th day of November 1990, I found (evidence) (~~xxxxxxx~~) of the E 1/4 corner of Section 25, T 16 N, R 3 W Fourth Principal Meridian, and I re-established said corner according to the Wisconsin Statutes as shown and described hereon.

History of corner establishment since Original Government Survey

No History of corner location since the Original Government Survey.

Description of corner evidence found:

Accepted the existing fence corner as the best available evidence of corner location.

Dated this 21st day of Dec. 1990

Garold A. Sime

Monroe County Surveyor
Title

Description of corner and witness monuments, references and accessories used to perpetuate the original or re-established location of this corner:

- Set cast iron Harrison Monument at corner.
- Set guard sign next to monument

Witnesses to corner location:

- Garold A. Sime, R.L.S.
- Bryan H. Meyer, R.L.S.
- John Kenworthy

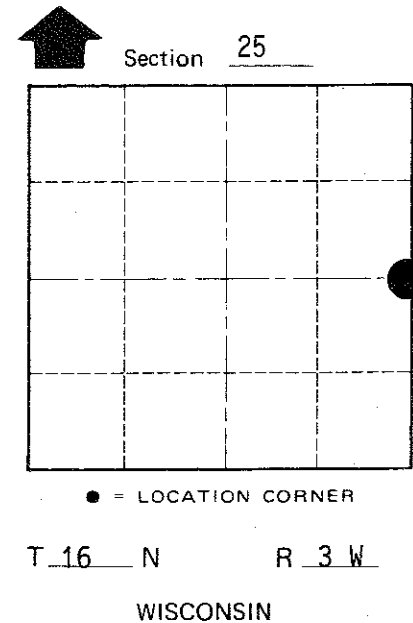
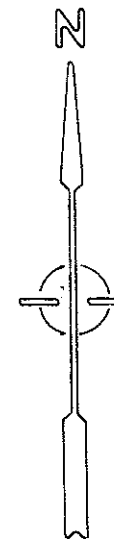
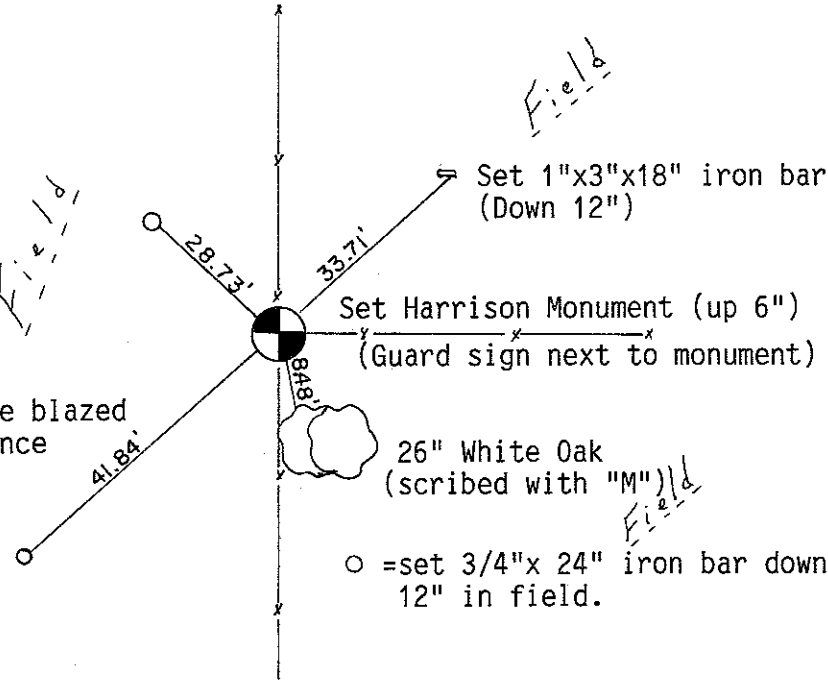
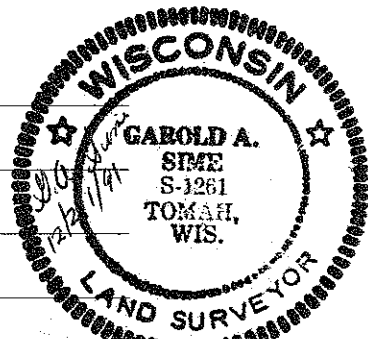

COUNTY SURVEYOR FORM NO. 1

SURVEY CONTROL ORDER

Horizontal	_____
Vertical	_____

WISCONSIN COORDINATE SYSTEM

Corner	East (X)	North (Y)	Elevation (Z)	Zone
Control Sta. Name				

City, Village or Town of Wells
County of Monroe