

CERTIFICATE

CERTIFIED LAND CORNER

No. 101

21603250000

I, Garold A. Sime, do hereby certify that on the 7th day of November, 1990, I found (evidence) (~~XXXXXXX~~) of the Southeast corner of Section 25, T 16 N, R 3 W Fourth Principal Meridian, and I re-established said corner according to the Wisconsin Statutes as shown and described hereon.

Dated this 21st day of Dec. 1990.

Garold A. Sime

Monroe County Surveyor  
Title

History of corner establishment since Original Government Survey

No history of corner location since the Original Government Survey

Description of corner evidence found:

Accepted the existing fence corner as the best available evidence of corner location.

Description of corner and witness monuments, references and accessories used to perpetuate the original or re-established location of this corner:

- Set cast iron Harrison Monument at corner
- Set guard sign next to monument

Witnesses to corner location:

- Garold A. Sime, R.L.S.
- Bryan H. Meyer, R.L.S.
- John Kenworthy

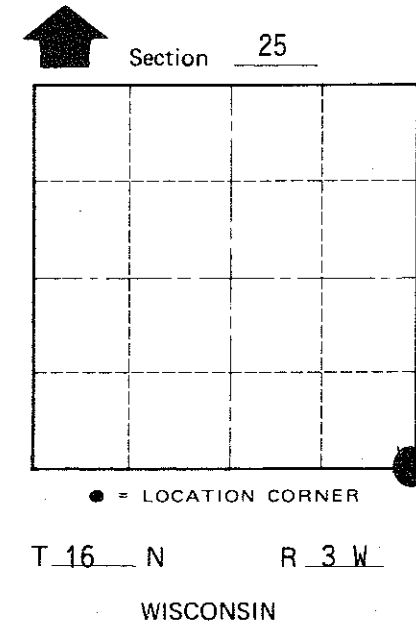
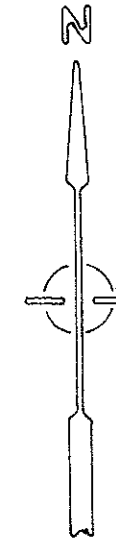
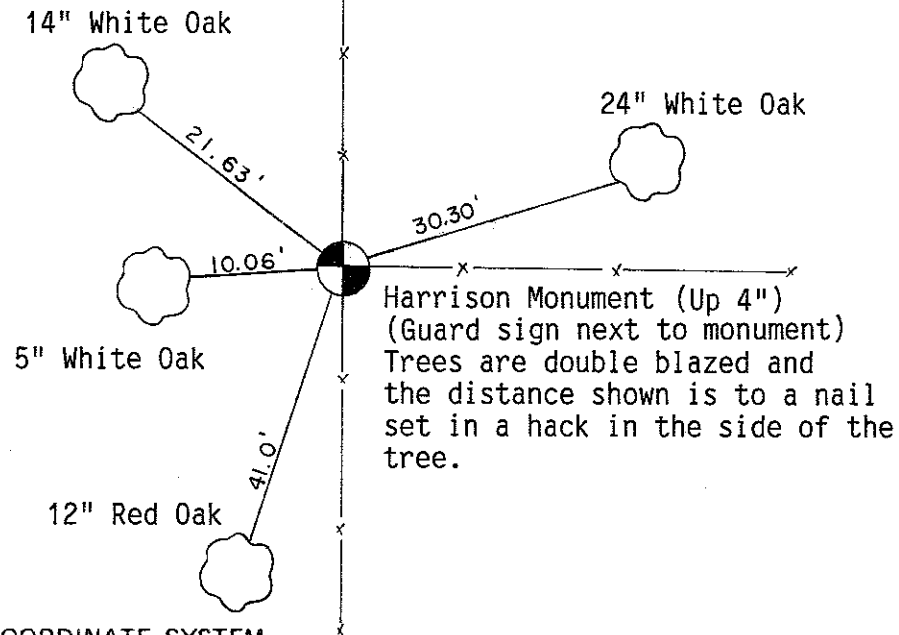
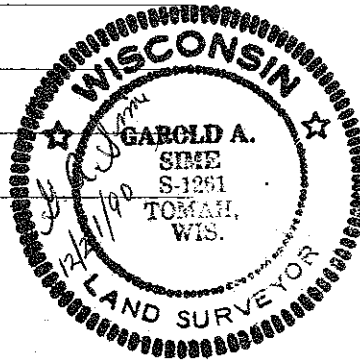

COUNTY SURVEYOR FORM NO. 1

SURVEY CONTROL ORDER

Horizontal	_____
Vertical	_____

Corner	East (X)	North (Y)	Elevation (Z)	Zone
Control Sta. Name				

WISCONSIN COORDINATE SYSTEM

City, Village or Town of Wells

County of Monroe