

CERTIFICATE

CERTIFIED LAND CORNER

No. 89

2160320000

I, Harley A. Sime, do hereby certify that on the 19th day of July 1974, I found (evidence) (~~no evidence~~) of the NE corner of Section 29, T 16 N, R 3 W, Fourth Principal Meridian, and I re-established said corner according to the Wisconsin Statutes as shown and described hereon.

History of original corner establishment:

No known history recorded since the original government survey.

Description of corner evidence found:

Projected the North fence south and intersected it with the West fence. Set Harrison Monument.

Dated this 1st day of Dec. 1977.

Harley A. Sime
County Surveyor
Title

Approved: HARLEY A. SIME
MONROE CO. SURVEYOR

Description of corner and witness monuments, references and accessories used to perpetuate the original or re-established location of this corner:

Witnesses to corner location:

D. Marten

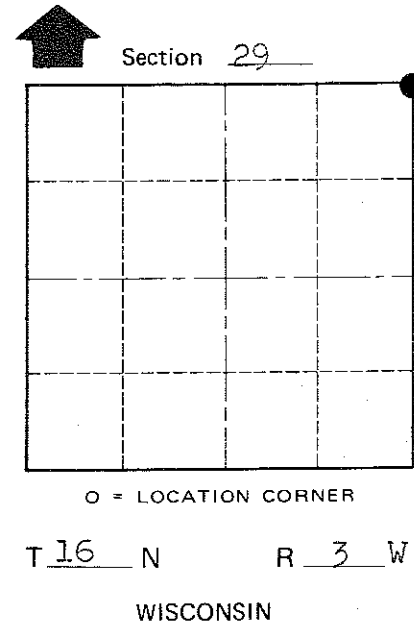
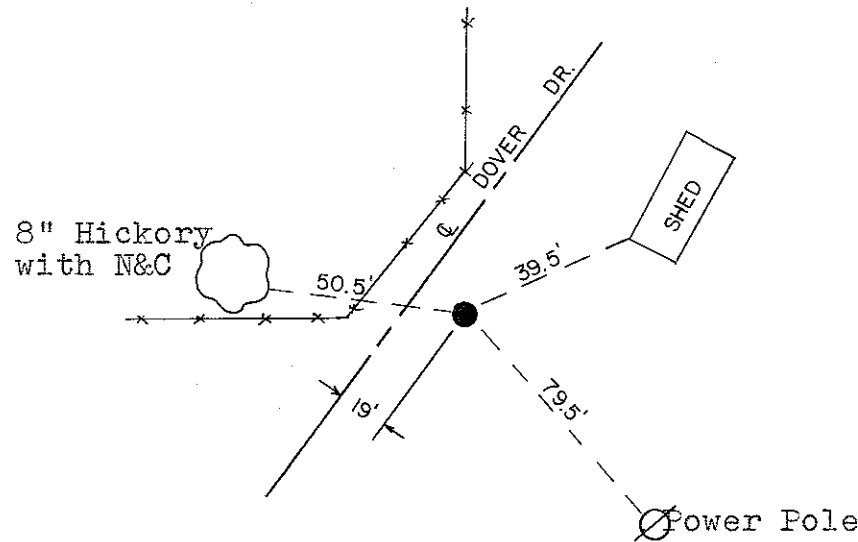

COUNTY SURVEYOR FORM NO. 1

SURVEY CONTROL ORDER

Horizontal	_____
Vertical	_____

WISCONSIN COORDINATE SYSTEM

Corner	East (X)	North (Y)	Elevation (Z)	Zone
Control Sta. Name				

City, Village or Town Wells
County of Monroe

o.k.