

I, Bryan H. Meyer, do hereby certify that on the 16th day of November 1994, I found ~~(no evidence)~~ (no evidence) of the East 1/4 corner of Section 19, T. 16 N., R. 3 W. Fourth Principal Meridian, and I re-established said corner according to the Wisconsin Statutes as shown and described hereon.

Dated this 18th day of Nov. 1994.

Bryan H. Meyer
Deputy County Surveyor
Title

History of corner establishment since Original Government Survey

I can find no recorded documentation regarding perpetuation of this corner.

Description of corner evidence found:

I re-established this corner on line with an old existing fence line from the North and at a distance of 20 rods (330') South of a fence corner which is the Northeast corner of a parcel of lands as described in Vol. 123 Records, Page 196.



Bryan H. Meyer
H. A. Sime and Associates
P. O. Box 705
Tomah, Wisconsin 54660
Phone: (608)-372-5392

COUNTY SURVEYOR FORM NO. 1

Description of corner and witness monuments, references and accessories used to perpetuate the original or re-established location of this corner:

Crew: Meyer, Haberlin
Date: November 16, 1994 - 12:00 Noon
Weather: Clear, Breezy, 40°±
Witnesses to corner location:

Bryan H. Meyer

Harold Haberlin

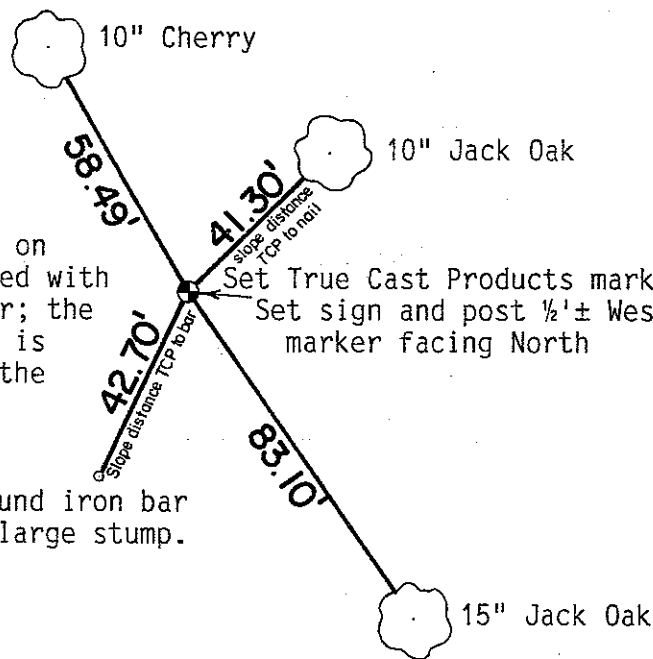

NOTE: The three trees shown on this sketch are double blazed with the blazes facing the corner; the distance shown to each tree is to a nail set in a hack in the side of each tree.

Set 3/4" x 24" round iron bar on North side of large stump.

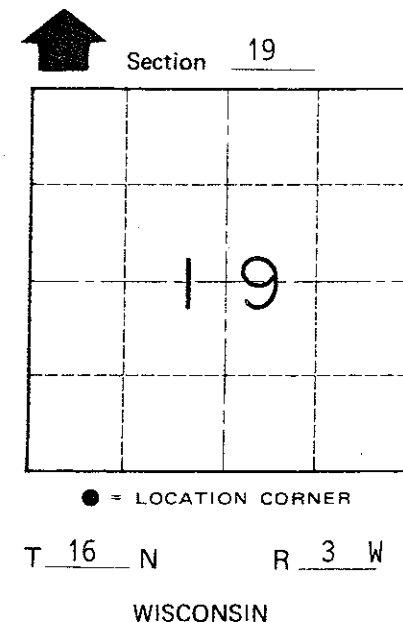

SURVEY CONTROL ORDER

Horizontal	_____
Vertical	_____

WISCONSIN COORDINATE SYSTEM

Corner	East (X)	North (Y)	Elevation (Z)	Zone
Control Sta. Name				

~~any village in~~ Town of Wells
County of Monroe