

CERTIFIED LAND CORNER

CERTIFICATE

I, JONATHAN SCHMITZ, do hereby certify that on the 9th day of MARCH, 2006, I found (evidence) (no evidence) of the N.1/4 corner of Section 20, T.16N., R.3W., Fourth Principle Meridian, and I re-established said corner according to the Wisconsin Statutes as shown and described hereon.

History of corner establishment since Original Government Survey
NO KNOWN HISTORY SINCE THE ORIGINAL GOVERNMENT SURVEY

Dated, this 9th day of MARCH, 2006.

Description of corner evidence found:

No evidence of the original corner found set corner at existing four way fence intersection

[Signature]
JONATHAN SCHMITZ, RLS 2465
POINT SURVEYING
519 LINCOLN ST., SPARTA, WI

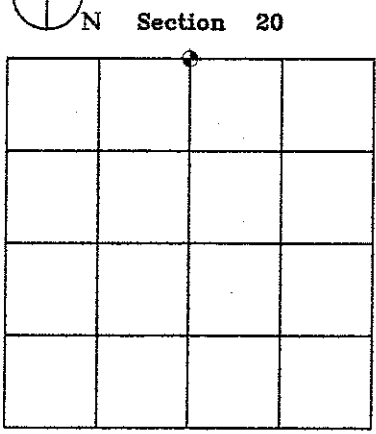

⊕ = LOCATION CORNER
T.16N. R.3W.
WISCONSIN

Description of corner and witness monuments, references and accessories used to perpetuate the original or re-established location of this corner:

- Legend
- 3/4" X 24" Rebar set weighing 1.5 lbs per lin.ft.
 - ⊕ TCP Monument set
 - Fence line

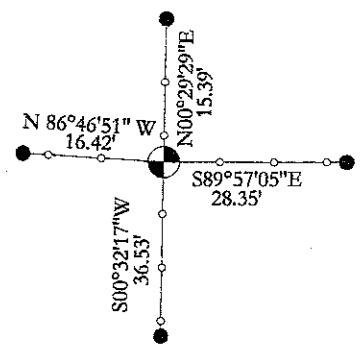

Witness to corner location:

JONATHAN SCHMITZ

STEVE NICHOLS

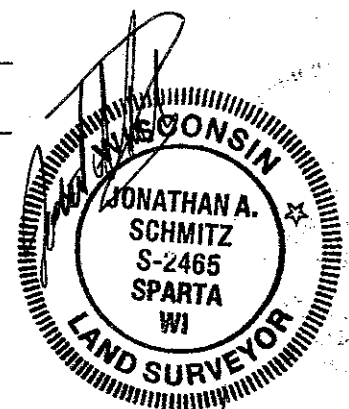

3/9/6

BEARING AND DISTANCE FROM NORTH CORNER TO
NE CORNER-S89°22'07"E 2660.27'
NW CORNER-N88°22'57"W 2645.28'
SOUTH 1/4 CORNER S00°03'16"W 5295.77'

MONROE COUNTY COORDINATE SYSTEM

North (Y)	East (X)
N:347831.526	E:639442.632

City, Village or Town WELLS

County of Monroe

COUNTY SURVEYOR FORM NO. 1