

CERTIFICATE

CERTIFIED LAND CORNER

No. 57

21603162000

I, Ronald D. Parish, do hereby certify that on the 31st day of August 19 87, I found (evidence) (no evidence) of the E 1/4 corner of Section 16, T 16 N, R 3 W. Fourth Principal Meridian, and I re-established said corner according to the Wisconsin Statutes as shown and described hereon.

Dated this 18th day of Sept. 19 87.

Ronald D. Parish
Registered Land Surveyor
Title

History of corner establishment since Original Government Survey

No known history since the Original Government Survey

Description of corner evidence found:

Found traces of an old fence line to the North. Set corner equi distance from NE corner & SE corner and in line with traces of old fence.

Description of corner and witness monuments, references and accessories used to perpetuate the original or re-established location of this corner:

Witnesses to corner location:

Ronald Parish
Robert Sherwood

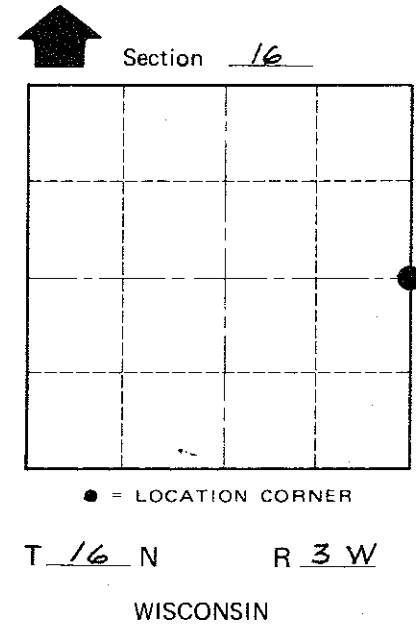
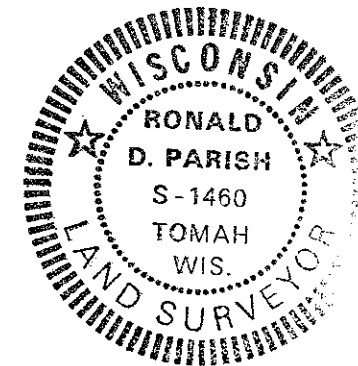
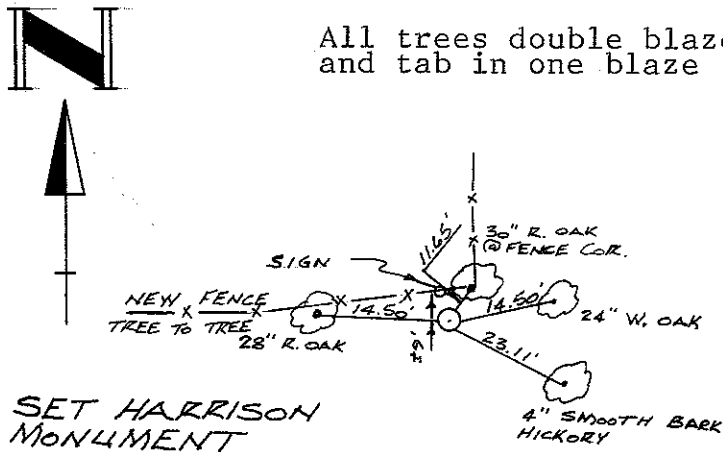

SURVEY CONTROL ORDER

Horizontal _____
Vertical _____

WISCONSIN COORDINATE SYSTEM

Corner	East (X)	North (Y)	Elevation (Z)	Zone
Control Sta. Name				

City, Village or Town Wells
County of Monroe

COUNTY SURVEYOR FORM NO. 1