

CERTIFICATE

CERTIFIED LAND CORNER

No. 64

21603140020

I, Gary L. Dechant, do hereby certify that on the 31st day of August 2000, I found (evidence) ~~(evidence)~~ of the N¹/₄ corner of Sec. 23, T 16 N, R 3 W Fourth Principal Meridian, and I re-established said corner according to the Wisconsin Statutes as shown and described hereon.

History of corner establishment since Original Government Survey

Hamilton LaRue was here in 1900 and Fred Holden in 1900.

Description of corner evidence found:

Accepted fence corner as best available evidence. Falls 7' from a straight line between section corners. Measures 2620.27 to NW section corner and 2626.78' to NE section corner.

Dated this 14th day of Sept 2000.

Gary L. Dechant

R.L.S. 1744
Title

COUNTY SURVEYOR FORM NO. 1

Description of corner and witness monuments, references and accessories used to perpetuate the original or re-established location of this corner:

Witnesses to corner location:

Zachariah P. Dechant

Gary L. Dechant

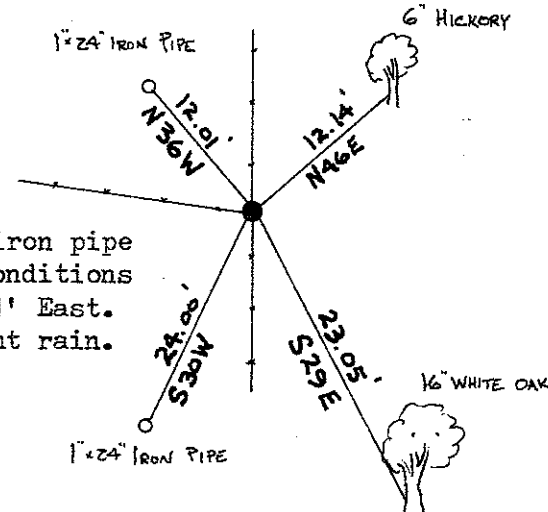

Gary L. Dechant
 WISCONSIN
 GARY L. DECHANT
 S-1744
 CAMP DOUGLAS, WI
 LAND SURVEYOR
 Spt 14, 2000

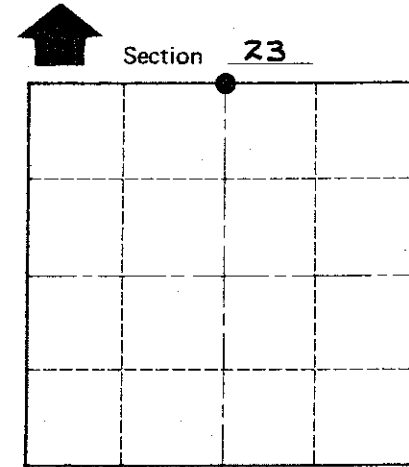

T 16 N R 3 W
WISCONSIN

Trees double blazed with 40d nails set.

SURVEY CONTROL ORDER

Horizontal	_____
Vertical	_____

WISCONSIN COORDINATE SYSTEM

Corner	East (X)	North (Y)	Elevation (Z)	Zone
Control Sta. Name				

~~City, Village or~~ Town WELLS
County of MONROE