

40

**U.S. PUBLIC LAND CORNER
MAINTENANCE**

**Corner ID : E1/4 Sec.12, T16N-R3W
21603122000**

<u>DATE</u>	<u>CREW</u>	<u>MONUMENT TYPE</u> -----
May 28, 2015	Zachariah P. Dechant Gary L. Dechant	Found Harrison intact 3' south of fence corner.

References:

	<u>Bearing</u>	<u>Distance</u>
1) Set 3/4"x24" round iron bar, down 6", 4' SW of 4" Hickory	N58E	34.02'
2) Set 3/4"x24" hex iron bar , down 6", 4' NW of 8" Red Oak	S71E	28.40'
3) Set 3/4"x24" round iron bar, down 6", 4' NE of 6" Hickory	S58W	17.15'
4) Set 3/4"x24" round iron bar 2' east of pasture fence	N57W	18.73'

Gary L. Dechant

May 28, 2015

I, Bryan H. Meyer, do hereby certify that on the 21st day of September 1984, I found (evidence) ~~_____~~ of the W¹/₄ corner of Section 7, T 16 N, R 2 W Fourth Principal Meridian, and I re-established said corner according to the Wisconsin Statutes as shown and described hereon.

Dated this 15th day of Nov. 1984.

Bryan H. Meyer

Bryan H. Meyer, Deputy County Surveyor
Title

History of corner establishment since Original Government Survey

No recorded history.

See Reverse Side For Maintenance

Description of corner evidence found:

Accepted 3-way fence corner as the best available evidence.



COUNTY SURVEYOR FORM NO. 1

Description of corner and witness monuments, references and accessories used to perpetuate the original or re-established location of this corner:

Crew: Meyer, Wilhite
Date: September 21, 1984 - 2:30 P.M.
Weather: Windy, Clear, 75°±

Witnesses to corner location:

Bryan H. Meyer

Dallas Wilhite

NOTE: Both Oak bearing trees are scribed in the upper blaze.

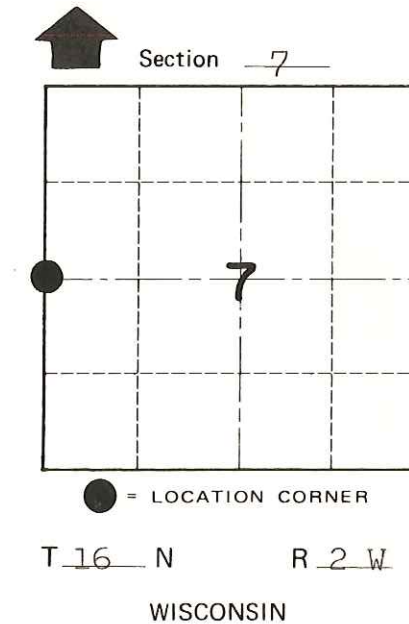
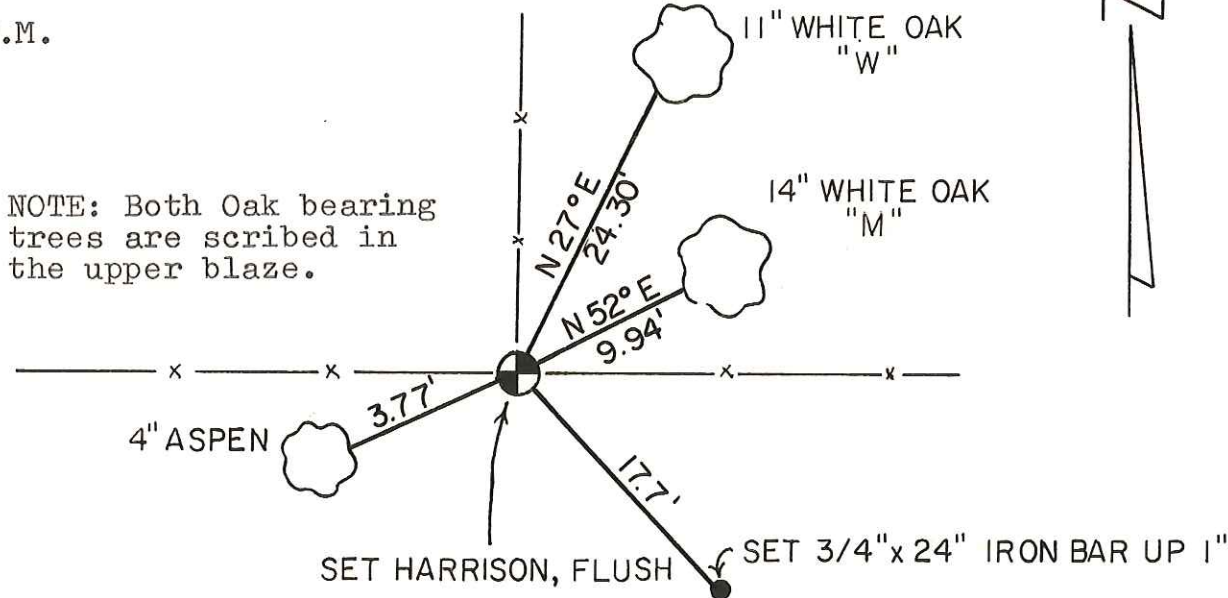

SURVEY CONTROL ORDER

Horizontal	_____
Vertical	_____

NOTE: The three bearing trees shown are double blazed; each distance shown is to a nail set in a hack in the side of each tree. The bearings shown are hand compass bearings.

WISCONSIN COORDINATE SYSTEM

Corner	East (X)	North (Y)	Elevation (Z)	Zone
Control Sta. Name				

~~City Village of~~ Town Ridgeville

County of Monroe