

21603102000

I, William C. Jung, do hereby certify that on the 8<sup>th</sup> day of May, 1979, I found ~~(evidence)~~ (no evidence) of the West 1/4 corner of Section 11, T 16 N, R 3 W Fourth Principal Meridian, and I re-established said corner according to the Wisconsin Statutes as shown and described hereon.

History of corner establishment since Original Government Survey

None recorded since the original government survey.

Description of corner evidence found:

Set a Harrison marker equidistant and on line with the section corners.

Dated this 16th day of Feb., 1981.

*William C. Jung*

William C. Jung, R.L.S. 1323

Title

COUNTY SURVEYOR FORM NO. 1

Description of corner and witness monuments, references and accessories used to perpetuate the original or re-established location of this corner:

Witnesses to corner location:

Jung

Dechant

NOTE: ALL TREES DOUBLE BLAZED WITH NAIL & CAPS SET

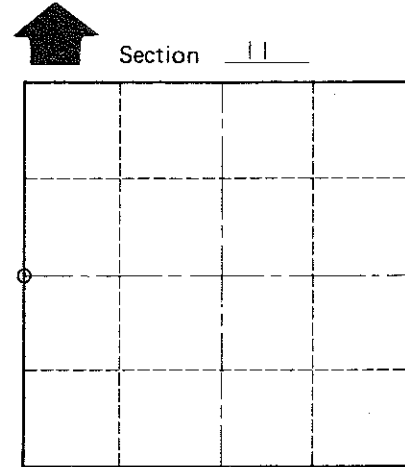
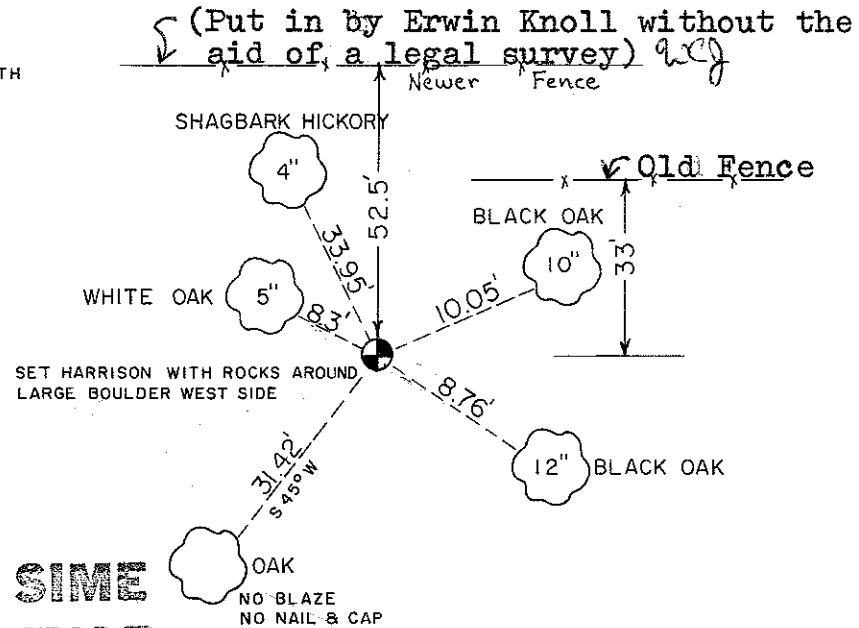
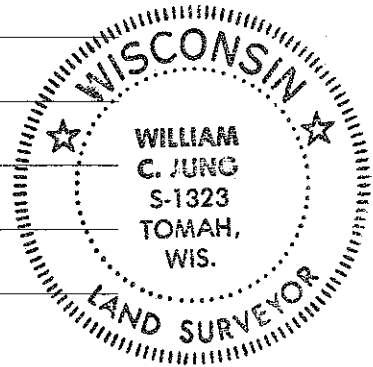

O = LOCATION CORNER

T 16 N R 3 W

WISCONSIN

Approved: **HARLEY A. SIME**  
**MONROE CO. SURVEYOR**

SURVEY CONTROL ORDER

Horizontal \_\_\_\_\_

Vertical \_\_\_\_\_

WISCONSIN COORDINATE SYSTEM

Corner	East (X)	North (Y)	Elevation (Z)	Zone
Control Sta. Name				

\_\_\_\_\_ or Town Wells  
County of Monroe