

CERTIFICATE

CERTIFIED LAND CORNER

No. 51

21603070000

I, Lawrence A. Feddersen, do hereby certify that on the 22 day of September 1981, I found (EVIDENCE) (~~XXXXXXXXXX~~) of the SE corner of Section 7, T 16 N, R 3W Fourth Principal Meridian, and I re-established said corner according to the Wisconsin Statutes as shown and described hereon.

Dated this 10 day of Feb, 1982.

Lawrence A. Feddersen

Registered Land Surveyor Title

History of corner establishment since Original Government Survey

Fred Holden, County Surveyor, found the original corner at this point in December of 1906 and September of 1908.

Description of corner evidence found:

Believe we found original bearing tree, set Harrison at Government distance and bearing as stated in notes.

COUNTY SURVEYOR FORM NO. 1

Description of corner and witness monuments, references and accessories used to perpetuate the original or re-established location of this corner:

Witnesses to corner location:

Lawrence Feddersen

Thomas Mangene

old witness tree original bearing tree a 30" white oak

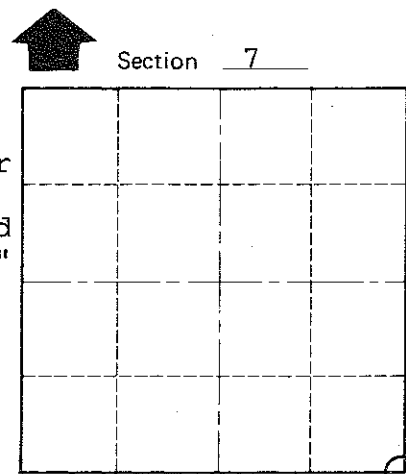
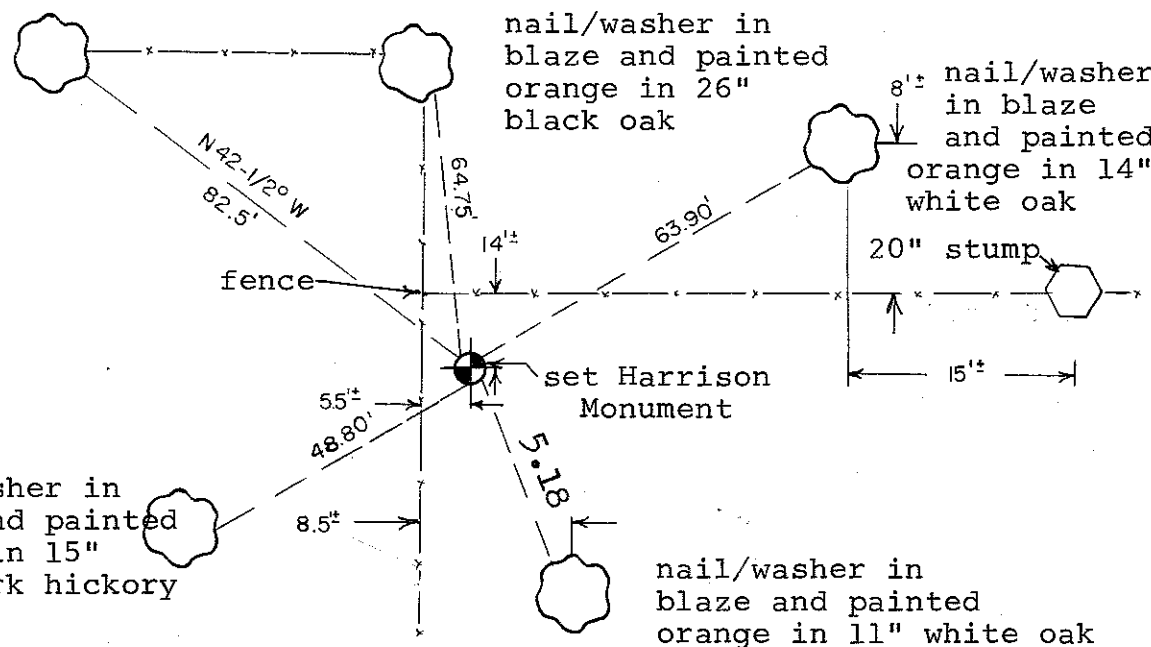

Approved: HARLEY A. SIME MONROE CO. SURVEYOR

SURVEY CONTROL ORDER

Table with 2 rows: Horizontal, Vertical

WISCONSIN COORDINATE SYSTEM

Table with 5 columns: Corner, East (X), North (Y), Elevation (Z), Zone. Includes Control Sta. Name row.

XXXXXXXXXX Town of Wells County of Monroe