

21603032000

I, Garold A. Sime, do hereby certify that on the 14th day of February 1990, I found (evidence) ~~(no evidence)~~ of the E 1/4 corner of Section 3, T 16 N, R 3 W Fourth Principal Meridian, and I re-established said corner according to the Wisconsin Statutes as shown and described hereon.

Dated this 7th day of June 1990.

Garold A. Sime

Monroe County Surveyor  
Title

History of corner establishment since Original Government Survey

Fred Holden was at this corner in May of 1905

Description of corner evidence found:

The Original Bearing Tree to the west of the corner is still standing. I established this corner at the given bearing and distance from said tree. This location lands where the old fence corner stood.

Description of corner and witness monuments, references and accessories used to perpetuate the original or re-established location of this corner:

Set cast iron Harrison Monument at the corner.  
Sign set next to Monument.

Witnesses to corner location:

Garold A. Sime, R.L.S.

John Kenworthy

Brian Forsythe

Trees are double blazed and distances shown are to nails set in a hack in the side of the tree.

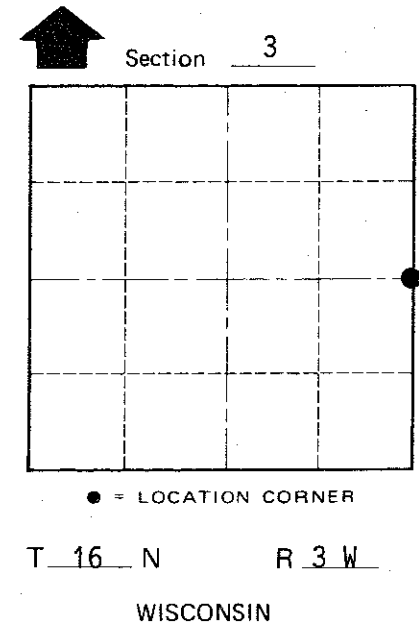
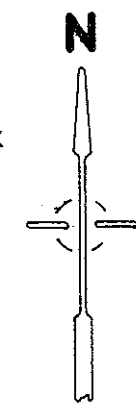
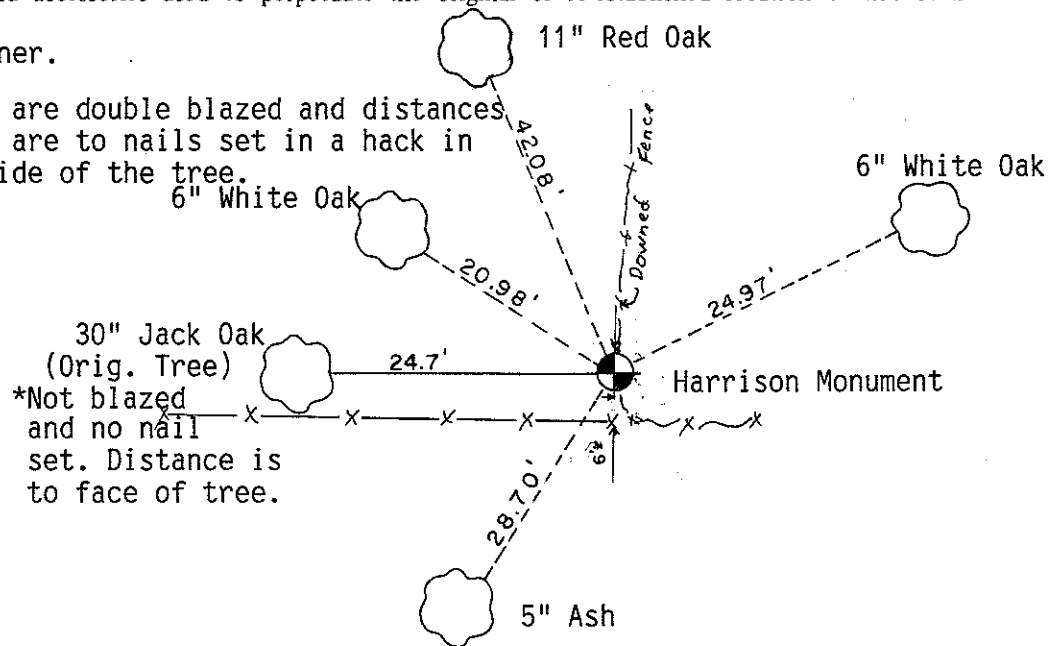

COUNTY SURVEYOR FORM NO. 1

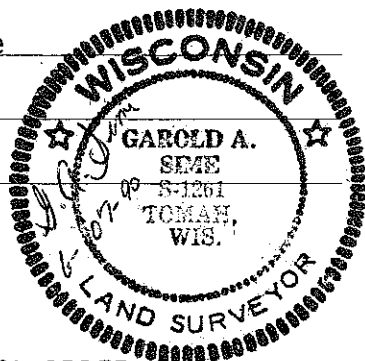

SURVEY CONTROL ORDER

Horizontal	_____
Vertical	_____

WISCONSIN COORDINATE SYSTEM

Corner	East (X)	North (Y)	Elevation (Z)	Zone
Control Sta. Name				

~~City, Village~~ or Town of Wells  
County of Monroe