

21602042000

I, Harley A. Sime, do hereby certify that on the 13th day of June 1975, I found (evidence) (~~no evidence~~) of the West 1/4 corner of Section 3, T 16 N, R 2 W, Fourth Principal Meridian, and I re-established said corner according to the Wisconsin Statutes as shown and described hereon.

History of original corner establishment:

Approved: **HARLEY A. SIME**  
**MONROE CO. SURVEYOR**

Description of corner evidence found:

Dated this 4th day of March 1976.

Accepted the occupied fence corner as the best available evidence. The Christiano brothers say this fence corner has been there for a minimum of 55 years, probably longer, at least as long as they can remember. The corner appears to be in error as the distance South is 100 ft. more or less short of the record distance, but this corner fits the occupation of Section 3. Our surveying, aerial photos, and U.S.G.S. maps show this latter point to be correct. Whether the original government corner was in error, or this corner was set in error is debatable. Not accepting the occupied 1/4 corner could increase the chances of severe title problems

County Surveyor  
Title

Description of corner and witness monuments, references and accessories used to perpetuate the original or re-established location of this corner: for local resident land owners in the future.

Set a Harrison marker at the fence corner, up 2".

Witnesses to corner location:

W.C. Jung-Crew Chief *W.C. Jung*

A. Lueck

G. Dechant

owners in the future.

Section 3

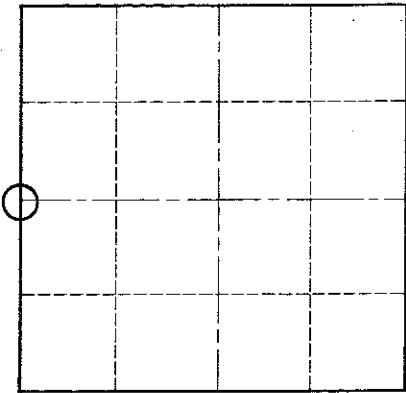
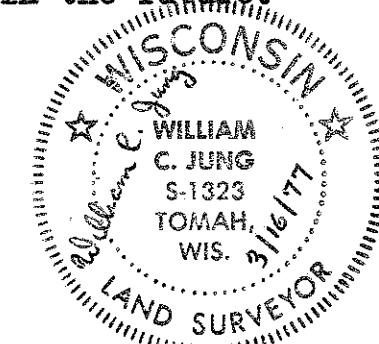

O = LOCATION CORNER

T 16 N R 2 W

WISCONSIN

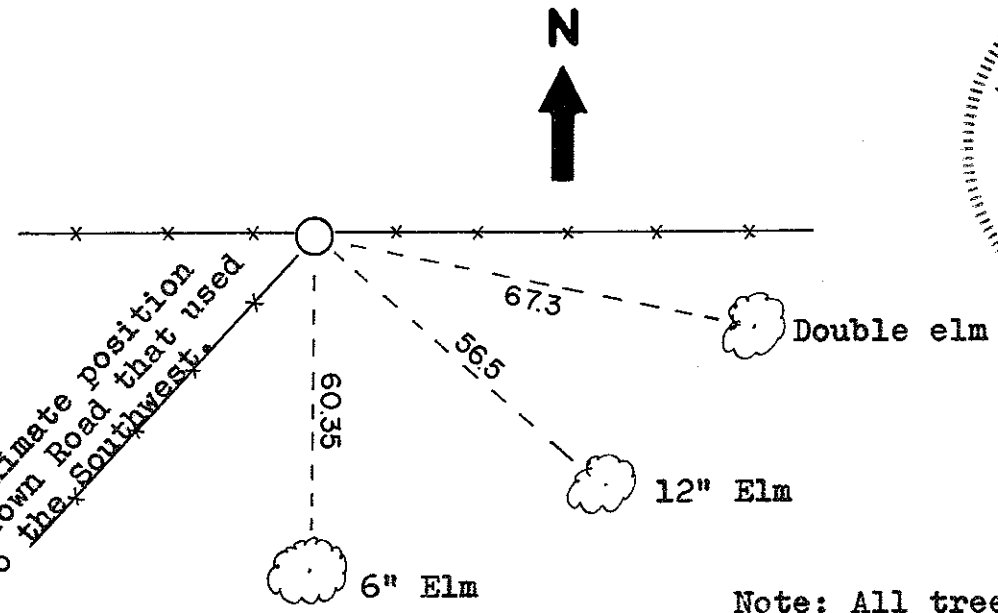

Note: All trees are blazed with nails and caps set in them.

SURVEY CONTROL ORDER

Horizontal	_____
Vertical	_____

WISCONSIN COORDINATE SYSTEM

Corner	East (X)	North (Y)	Elevation (Z)	Zone
Control Sta. Name				

City, Village or Town Ridgeville  
County of Monroe

COUNTY SURVEYOR FORM NO. 1

O.K.