

CERTIFICATE

CERTIFIED LAND CORNER

No. 14

21602012000

I, Garold A. Sime, do hereby certify that on the 22nd day of August 1983, I found (evidence) (~~was~~) of the W¹/₄ corner of Section 6, T 16 N, R 1 W Fourth Principal Meridian, and I re-established said corner according to the Wisconsin Statutes as shown and described hereon.

Dated this 19th day of Jan. 1984.

Garold A. Sime

Deputy County Surveyor
Title

History of corner establishment since Original Government Survey

Fred Holden was at this corner in April 1907

Description of corner evidence found:

Accepted existing 2-way fence corner as best available evidence

Description of corner and witness monuments, references and accessories used to perpetuate the original or re-established location of this corner:

Witnesses to corner location:

Garold A. Sime

Dallas Wilhite

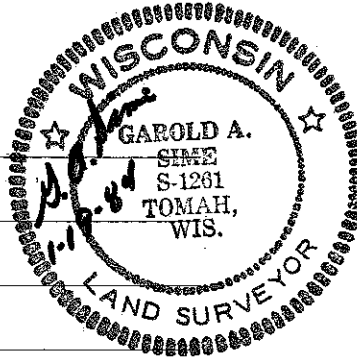

NOTE: All trees are double blazed and distances shown are slope distances to nails in hack in side of tree.

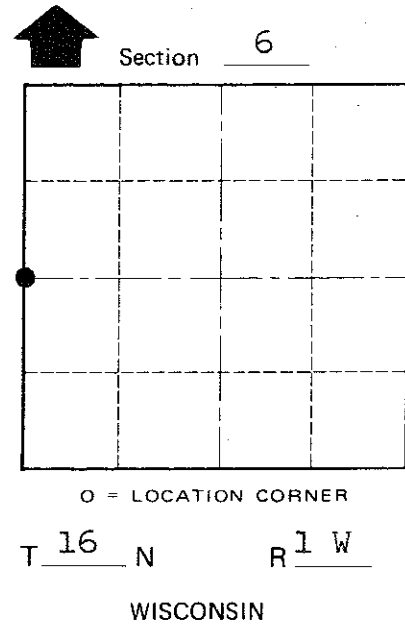
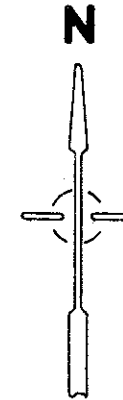
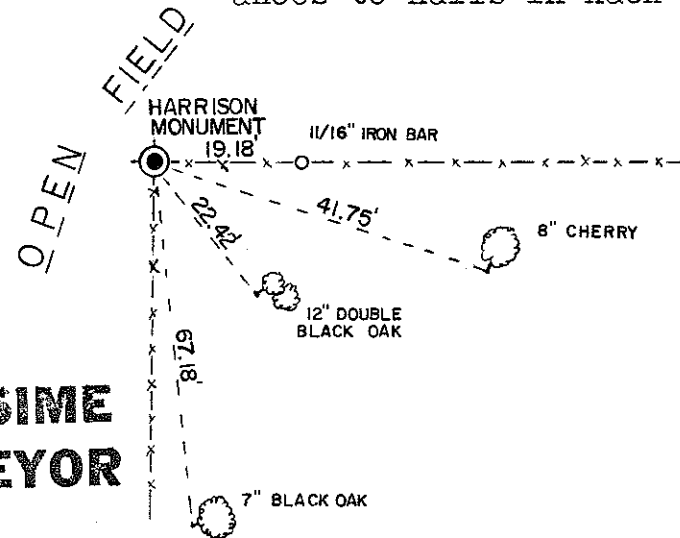

Approved: **HARLEY A. SIME**
MONROE CO. SURVEYOR

SURVEY CONTROL ORDER

Horizontal _____
Vertical _____

WISCONSIN COORDINATE SYSTEM

Corner	East (X)	North (Y)	Elevation (Z)	Zone
Control Sta. Name				

~~City, Village~~ or Town Wilton
County of Monroe

COUNTY SURVEYOR FORM NO. 1