

21602110020

I, Harley A. Sime, do hereby certify that on the twentieth day of June 1979, I found (evidence) (~~removed~~) of the South 1/4 corner of Section 11, T 16 N, R 2 W Fourth Principal Meridian, and I re-established said corner according to the Wisconsin Statutes as shown and described hereon.

Dated this Seventh day of Jan. 1981.

Harley A. Sime - R.L.S. 355

County Surveyor-Monroe County, Wisconsin
Title

History of corner establishment since Original Government Survey

Owen-Ayers set a 1" iron Pipe here in the late 1970's

Description of corner evidence found:

Found 1" pipe set by Owen-Ayers and accepted this as the corner. Removed the pipe and set a Harrison marker.

UPDATE: Harrison Monument was destroyed. I remonumented this corner at the previously computed location after traversing from existing survey markers along the east line of the Monroe County Landfill. G. A. Sime 5-03-90
Monroe County Surveyor

COUNTY SURVEYOR FORM NO. 1

Description of corner and witness monuments, references and accessories used to perpetuate the original or re-established location of this corner:

Witnesses to corner location:

Ron Hayden

Tim Webb

**Approved: HARLEY A. SIME
MONROE CO. SURVEYOR**

SURVEY CONTROL ORDER

Horizontal	_____
Vertical	_____

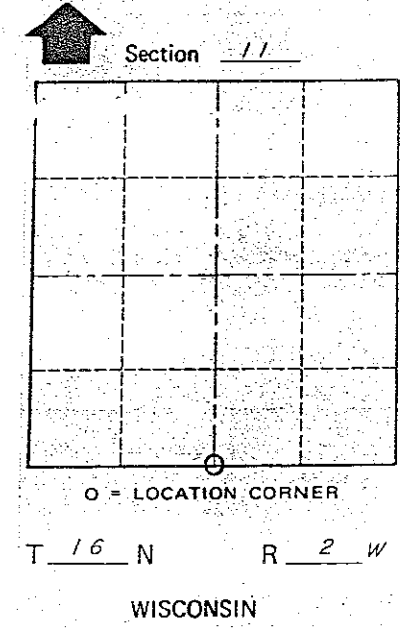
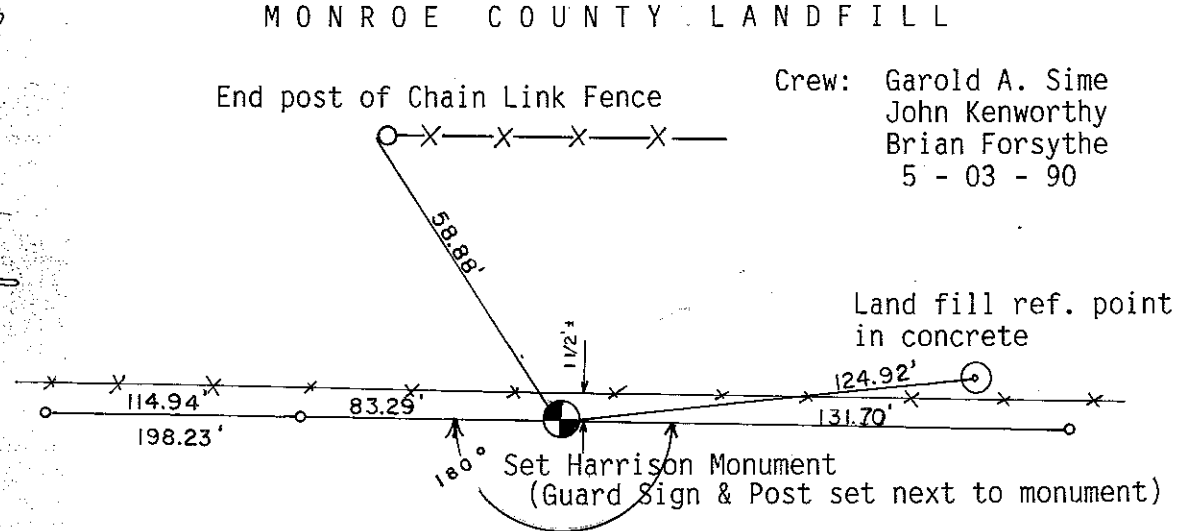
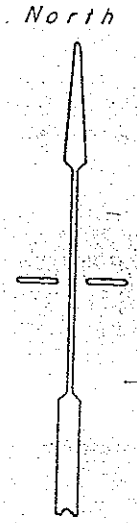

WISCONSIN COORDINATE SYSTEM

Corner	East (X)	North (Y)	Elevation (Z)	Zone
Control Sta. Name				

~~City, Village or Town~~ of Ridgeville

County of Monroe
Wisconsin

I, Harley A. Sime, do hereby certify that on the twentieth day of June 1979, I found (evidence) ~~(evidence)~~ of the South 1/4 corner of Section 11, T 16 N, R 2 W Fourth Principal Meridian, and I re-established said corner according to the Wisconsin Statutes as shown and described hereon.

Dated this seventh day of Jan. 1981.

Harley A. Sime - R.L.S. 355

County Surveyor-Monroe County, Wisconsin
Title

History of corner establishment since Original Government Survey

Owen-Ayers set a 1" iron Pipe here in the late 1970's

Description of corner evidence found:

Found 1" pipe set by Owen-Ayers and accepted this as the corner. Removed the pipe and set a Harrison marker.

COUNTY SURVEYOR FORM NO. 1

Description of corner and witness monuments, references and accessories used to perpetuate the original or re-established location of this corner:

Witnesses to corner location:

Ron Hayden

Tim Webb

North

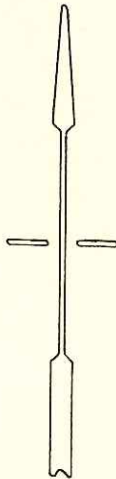

CULTIVATED FIELD

** See New Tie Sheet H. Sime 8-21-80*

BRUSH

CULTIVATED FIELD

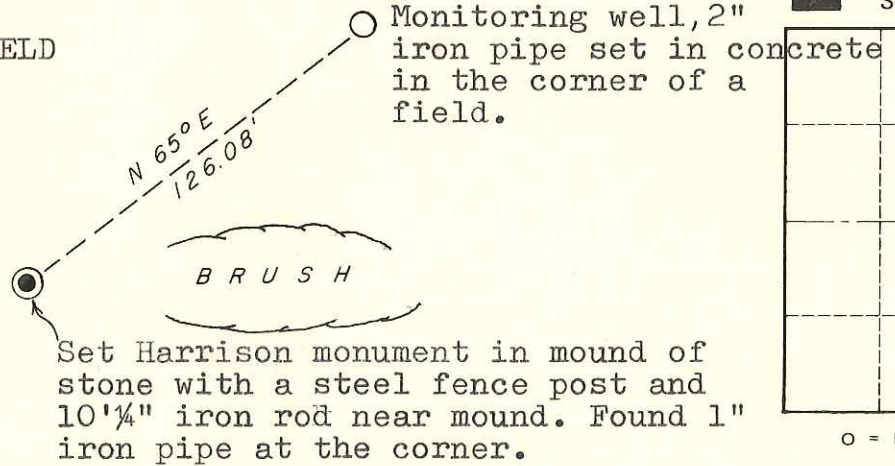

Section 11

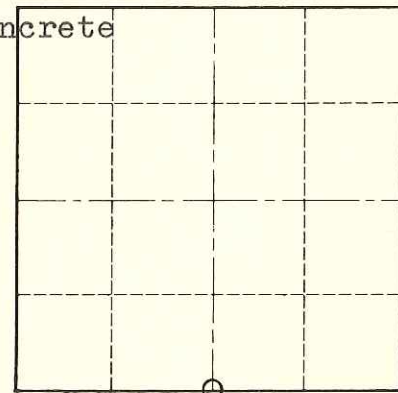

O = LOCATION CORNER

T 16 N R 2 W

WISCONSIN

**Approved: HARLEY A. SIME
MONROE CO. SURVEYOR**

SURVEY CONTROL ORDER

Horizontal	_____
Vertical	_____

NOTE: No trees or permanent markers near.

WISCONSIN COORDINATE SYSTEM

Corner	East (X)	North (Y)	Elevation (Z)	Zone
Control Sta. Name				

~~City, Village or Town~~ of Ridgeville

County of Monroe
Wisconsin