

CERTIFICATE

CERTIFIED LAND CORNER

No. 43

**21602110000**

I, Harley A. Sime do hereby certify that on the twenty-sixth day of June 1979, I found (evidence) ~~(no evidence)~~ of the Southeast corner of Section 11, T16 N, R 2W Fourth Principal Meridian, and I re-established said corner according to the Wisconsin Statutes as shown and described hereon.

History of corner establishment since Original Government Survey

No Recorded history since O.G.S.

Description of corner evidence found:

Found original bearing tree stump and set Harrison at proper distance and bearing.

Dated this eighth day of Jan. 1981.

Harley A. Sime - R.L.S. 355

County Surveyor - Monroe County, Wisconsin  
Title

COUNTY SURVEYOR FORM NO. 1

Description of corner and witness monuments, references and accessories used to perpetuate the original or re-established location of this corner:

Witnesses to corner location:

Ron Hayden

Bryan Meyer

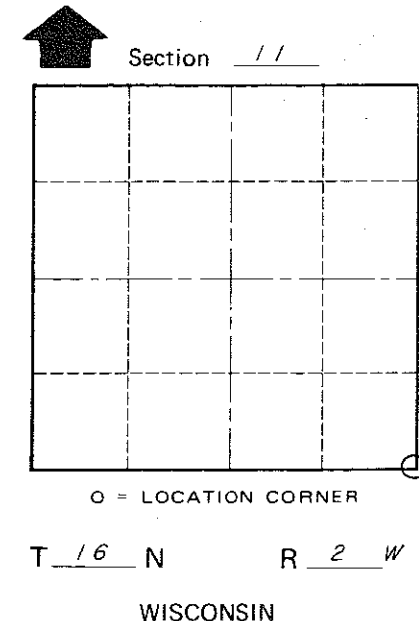
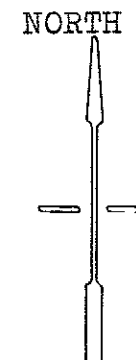
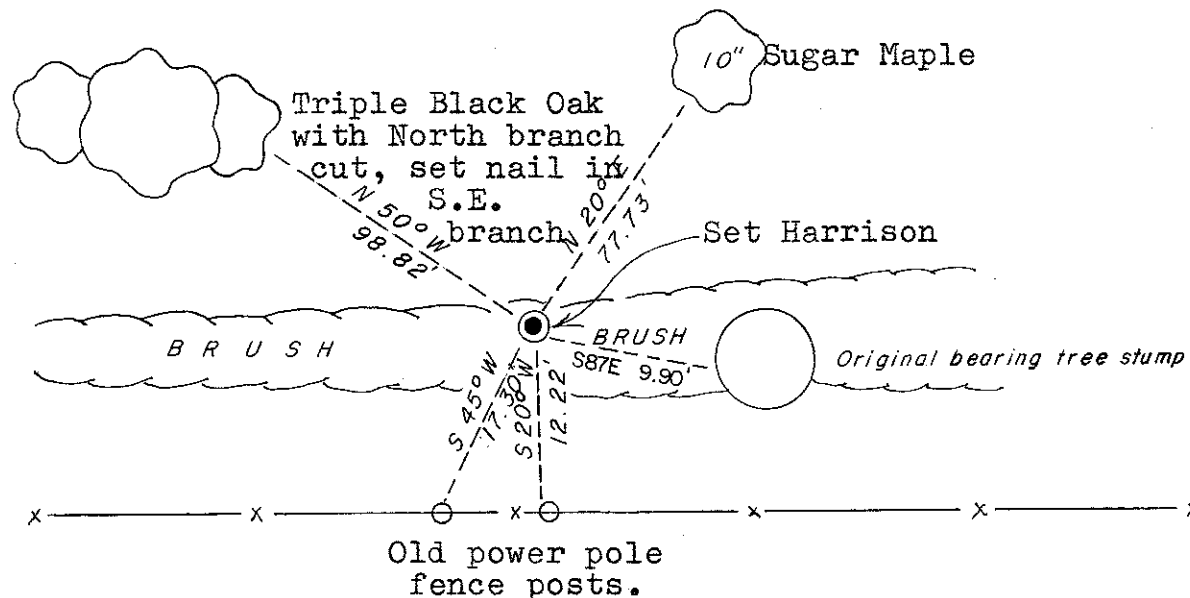

**Approved: HARLEY A. SIME**  
**MONROE CO. SURVEYOR**

SURVEY CONTROL ORDER

Horizontal	_____
Vertical	_____

NOTE: Set corner from original bearing tree stump.

WISCONSIN COORDINATE SYSTEM

Corner	East (X)	North (Y)	Elevation (Z)	Zone
Control Sta. Name				

~~City, Village or~~ Town of Ridgeville  
County of Monroe  
Wisconsin