

21602100020

I, Harley A. Sime, do hereby certify that on the 20th day of June 1979, I found (evidence) (~~no evidence~~) of the South 1/4 corner of Section 10, T 16 N, R 2 W Fourth Principal Meridian, and I re-established said corner according to the Wisconsin Statutes as shown and described hereon.

Dated this 7th day of Jan. 1981.

Harley A. Sime - R.L.S. 355

County Surveyor-Monroe County, Wisconsin

Title

History of corner establishment since Original Government Survey

D. Marten was here in November of 1974 and set a 3/4" iron bar.

Description of corner evidence found:

Found Marten's iron bar. Removed this bar and set a Harrison Monument. Accepted the iron bar at the occupied fence corner as the best available evidence of the original government corner.

COUNTY SURVEYOR FORM NO. 1

Description of corner and witness monuments, references and accessories used to perpetuate the original or re-established location of this corner:

Witnesses to corner location:

Ron Hayden

Tim Webb

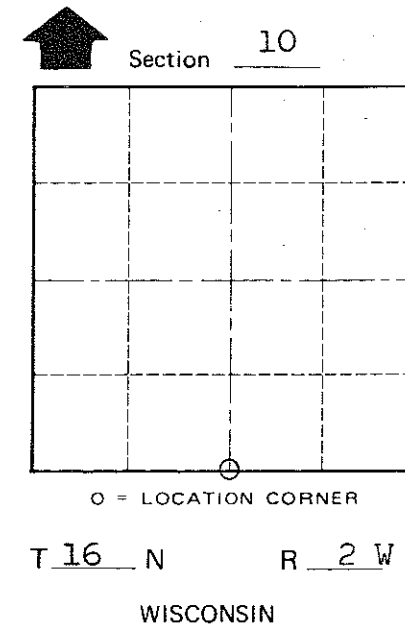
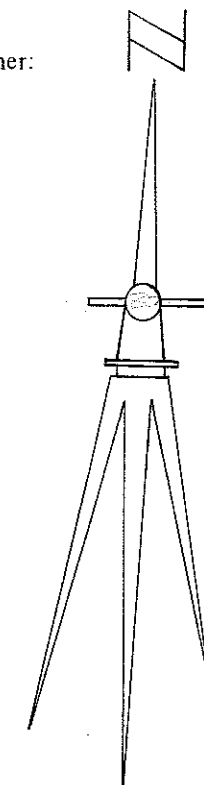
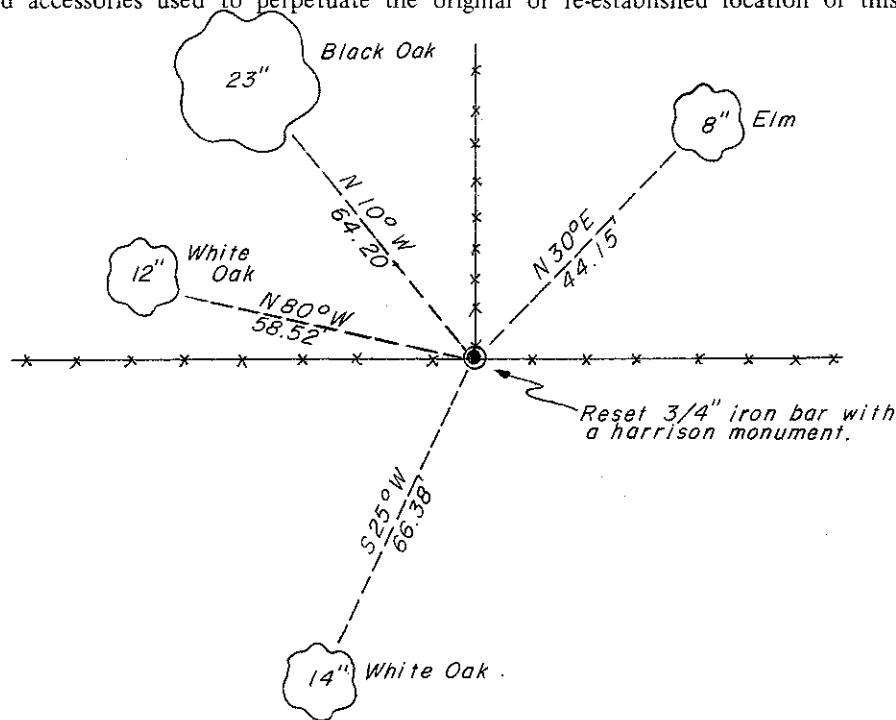

Approved: **HARLEY A. SIME**
MONROE CO. SURVEYOR

SURVEY CONTROL ORDER

Horizontal	_____
Vertical	_____

WISCONSIN COORDINATE SYSTEM

Corner	East (X)	North (Y)	Elevation (Z)	Zone
Control Sta. Name				

~~City, Village or Town~~ of Ridgeville
County of Monroe
Wisconsin