

32

**U.S. PUBLIC LAND CORNER
MAINTENANCE**

**Corner ID : S1/4 Sec.6, T16N-R2W
21602060020**

<u>DATE</u>	<u>CREW</u>	<u>MONUMENT TYPE</u> -----
May 28, 2015	Zachariah P. Dechant Gary L. Dechant	Found Harrison intact on SE side of large Bl. Oak used as fence corner.

References:

	<u>Bearing</u>	<u>Distance</u>
1) Set 3/4"x24" round iron bar, down 6", 6' west of 5" Black Cherry	N73E	49.93'
2) Set 3/4"x24" round iron bar, down 6", 4' south of 18" Black Oak Black Oak is in east-west fence	S82E	27.08'
3) Set 3/4"x24" round iron bar, down 6"	S18W	27.52'
4) Set 3/4"x24" round iron bar in leveled out area, 12' SE of 16" White Oak (BT)	N18W	77.15'

Harrison and reference markers 3 and 4 are on straight line.

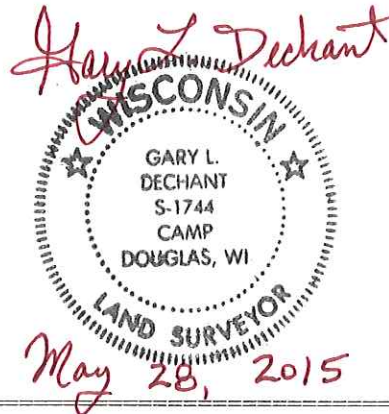

I, Bryan H. Meyer, do hereby certify that on the 20th day of September 1984, I found (evidence) ~~(no evidence)~~ of the N¹/₄ corner of Section 7, T 16 N, R 2 W Fourth Principal Meridian, and I re-established said corner according to the Wisconsin Statutes as shown and described hereon.

Dated this 15th day of Nov. 1984.

Bryan H. Meyer

Bryan H. Meyer, Deputy County Surveyor
Title

History of corner establishment since Original Government Survey

Nothing Recorded.

Description of corner evidence found:

I accepted a four-way fence corner as the best available evidence.

See Reverse Side For Maintenance



COUNTY SURVEYOR FORM NO. 1

Description of corner and witness monuments, references and accessories used to perpetuate the original or re-established location of this corner:

Crew: Meyer, Wilhite
Date: September 20, 1984 - 2:00 P.M.
Weather: Clear, 75°±
Witnesses to corner location:

Bryan Meyer

Dallas Wilhite

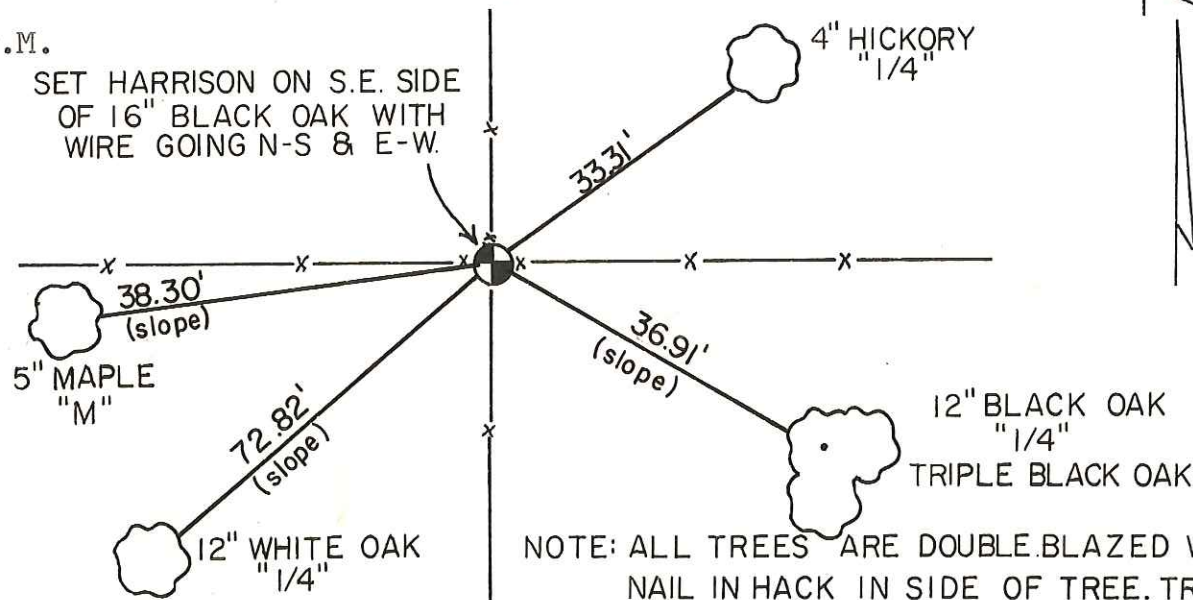

NOTE: ALL TREES ARE DOUBLE BLAZED WITH NAIL IN HACK IN SIDE OF TREE. TREES ARE ALSO SCRIBED IN UPPER BLAZE WITH SYMBOLS SHOWN IN " ".

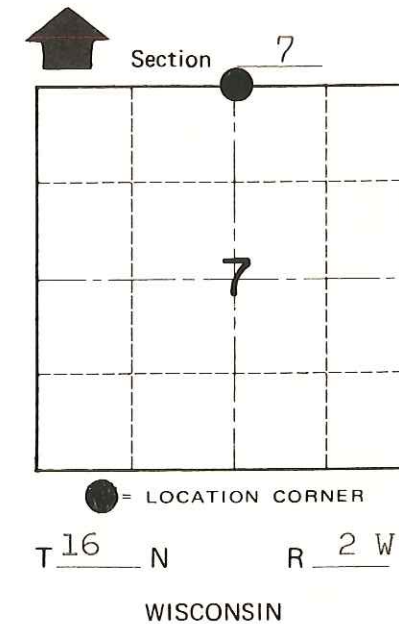

SURVEY CONTROL ORDER

Horizontal	_____
Vertical	_____

WISCONSIN COORDINATE SYSTEM

Corner	East (X)	North (Y)	Elevation (Z)	Zone
Control Sta. Name				

City, Village or Town Ridgeville

County of Monroe