

# 57

**U.S. PUBLIC LAND CORNER  
MAINTENANCE**

**Corner ID : E1/4 Sec.16, T16N-R2W  
21602162000**

<u>DATE</u>	<u>CREW</u>	<u>MONUMENT TYPE -----</u>
May 12, 2016	Zachariah P.Dechant Gary L. Dechant	Existing Harrison intact, 160' west of berm along west edge of field Set sign 1' east

References:

	<u>Bearing</u>	<u>Distance</u>
1) Set 3/4"x24" iron bar, down 6", 4' west of 12" Ash	N9E	30.56'
2) Set 3/4"x24" iron bar, down 6", 6' NW of 14" Ash	S58E	37.62'
3) Set 3/4"x24" iron bar, down 6", 4' NW of 34" Maple	S23W	33.67'
4) Set 3/4"x24" iron bar, down 6"	N70W	23.24'

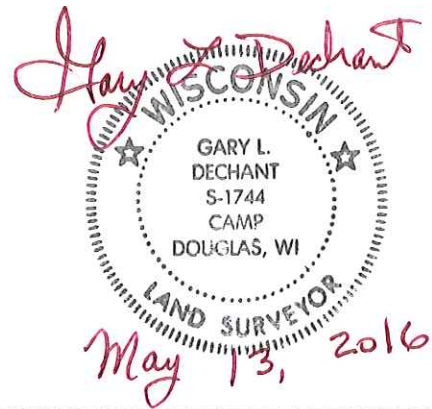

I, Harley A. Sime, do hereby certify that on the 11th day of November 19 74, I found (evidence) (~~no evidence~~) of the W 1/4 corner of Section 15, T 16 N, R 2 W, Fourth Principal Meridian, and I re-established said corner according to the Wisconsin Statutes as shown and described hereon.

History of original corner establishment:

**Approved: HARLEY A. SIME  
MONROE CO. SURVEYOR**

Description of corner evidence found:

**See Reverse Side  
For Maintenance**

Dated this 7th day of Feb. 1978.

Reset 3/4" iron bar with a Harrison Monument, up 2".

County Surveyor

Title

Description of corner and witness monuments, references and accessories used to perpetuate the original or re-established location of this corner:

Witnesses to corner location:

D. Marten

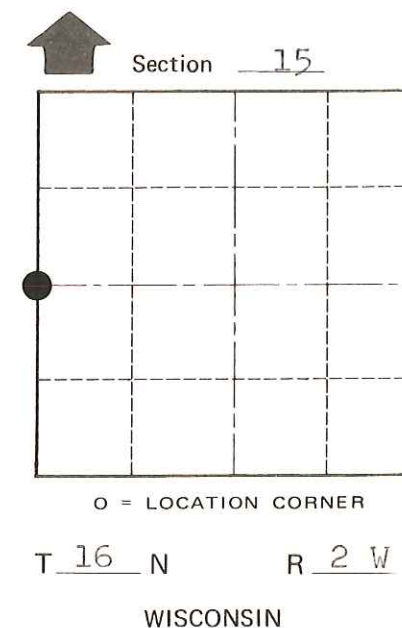
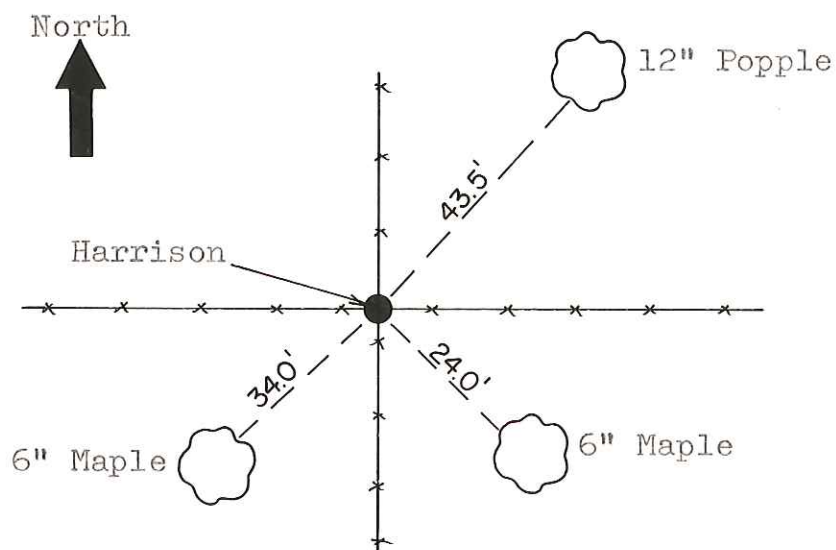

COUNTY SURVEYOR FORM NO. 1

SURVEY CONTROL ORDER

Horizontal	_____
Vertical	_____

WISCONSIN COORDINATE SYSTEM

Corner	East (X)	North (Y)	Elevation (Z)	Zone
Control Sta. Name				

City, Village or Town Ridgeville

County of Monroe