

67

**U.S. PUBLIC LAND CORNER
MAINTENANCE**

Corner ID : SE Sec. 16, T16N-R2W

21602160000

DATE	CREW	MONUMENT TYPE -----
April 27, 2016	Zachariah P.Dechant Gary L. Dechant	Found Harrison, top broke off, down 12" 15' south of centerline of Kennel Ave

References:

	<u>Bearing</u>	<u>Distance</u>
1) Existing 3/4"x24" round iron bar, lowered 6"	East	19.85' (20.00')
2) Set 3/4" x 24" round iron bar, down 6"	S24E	28.32'
3) Set 3/4" x24" round iron bar, down 6",	S56W	48.71
4) Existing 3/4" x 24" round iron bar, lowered 6"	N48W	38.41' (38.3')



=====

I, William C. Jung, do hereby certify that on the 18th day of October 1976, I found (evidence) (no evidence) of the NE corner of Section 21, T 16 N, R 2 W, Fourth Principal Meridian, and I re-established said corner according to the Wisconsin Statutes as shown and described hereon.

Dated this 7th day of Feb. 1978.

William C. Jung, R.L.S. 1323

Crew Chief, County Surveyor's Office

History of original corner establishment:

A.S. Ingalls was at this corner in May of 1873.

Description of corner evidence found:

Replaced an existing 3/4" iron bar with a Harrison Marker. The iron bar had been used by Zietlow and Marten in previous surveys. They accepted the occupied corner.

See Reverse Side For Maintenance

Description of corner and witness monuments, references and accessories used to perpetuate the original or re-established location of this corner:

Set a Harrison marker, flush, on the edge of the road. Looked for but could not find an iron pipe 33 feet to the East.

Witnesses to corner location:

- W. Jung
A. Lueck
B. Rasmussen

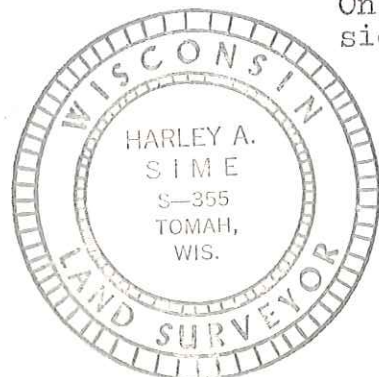

Set 3/4" iron bar On SW side of tree

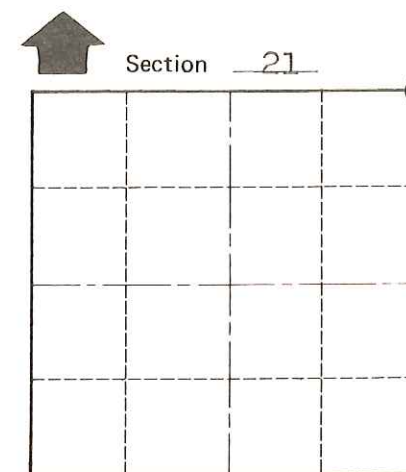
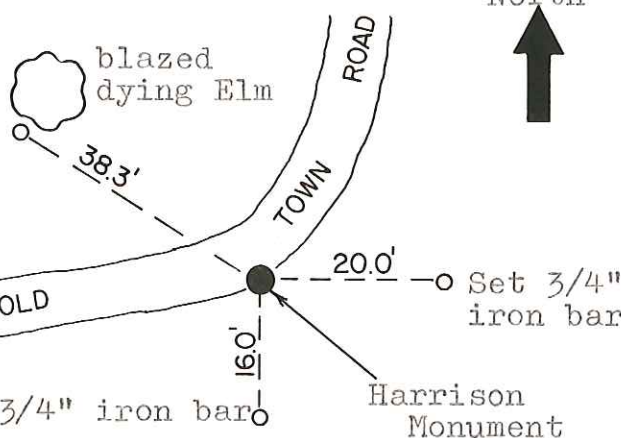

O = LOCATION CORNER
T 16 N R 2 W
WISCONSIN

SURVEY CONTROL ORDER

Horizontal
Vertical

Approved by: Harley A. Sime
County Surveyor

WISCONSIN COORDINATE SYSTEM

Table with columns: Corner, Control Sta. Name, East (X), North (Y), Elevation (Z), Zone

City, Village or Town Ridgeville

County of Monroe

COUNTY SURVEYOR FORM NO. 1