

CERTIFICATE

CERTIFIED LAND CORNER

No. 59

21602142000

I, Bryan H. Meyer, do hereby certify that on the 26th day of June 1985, I found (evidence) ~~no evidence~~ of the West 1/4 corner of Section 13, T16 N, R2 W Fourth Principal Meridian, and I re-established said corner according to the Wisconsin Statutes as shown and described hereon.

History of corner establishment since Original Government Survey

Nothing recorded.

Description of corner evidence found:

I accepted the three-way fence corner as the best available evidence.

Dated this 10th day of Feb. 1986.

Bryan H. Meyer
Deputy County Surveyor
Title

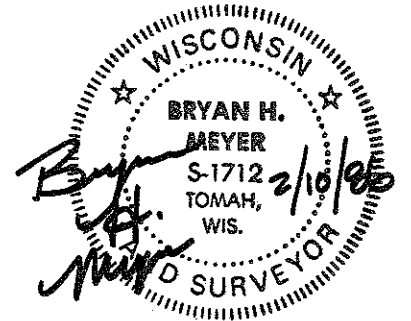

COUNTY SURVEYOR FORM NO. 1

Description of corner and witness monuments, references and accessories used to perpetuate the original or re-established location of this corner:

Crew: Wilhite, Lund
Date: June 26, 1985
Weather: Hazy, 85°±
Witnesses to corner location:

Bryan H. Meyer
Dallas Wilhite
James Lund

36" Black Oak
(not blazed
distance to
nail in hack)

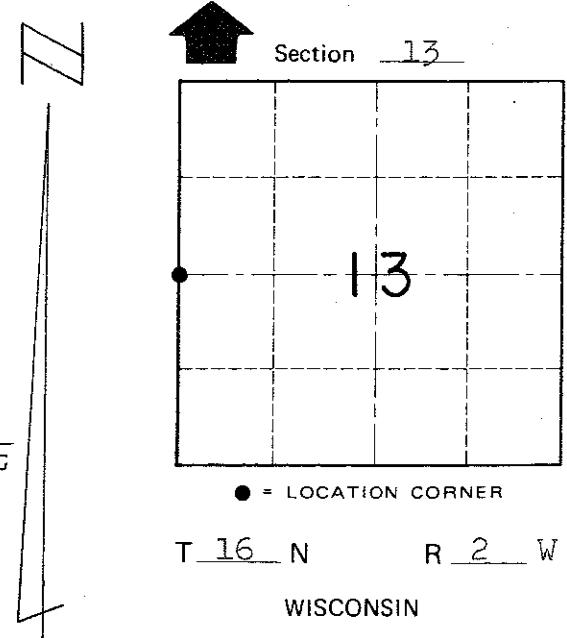
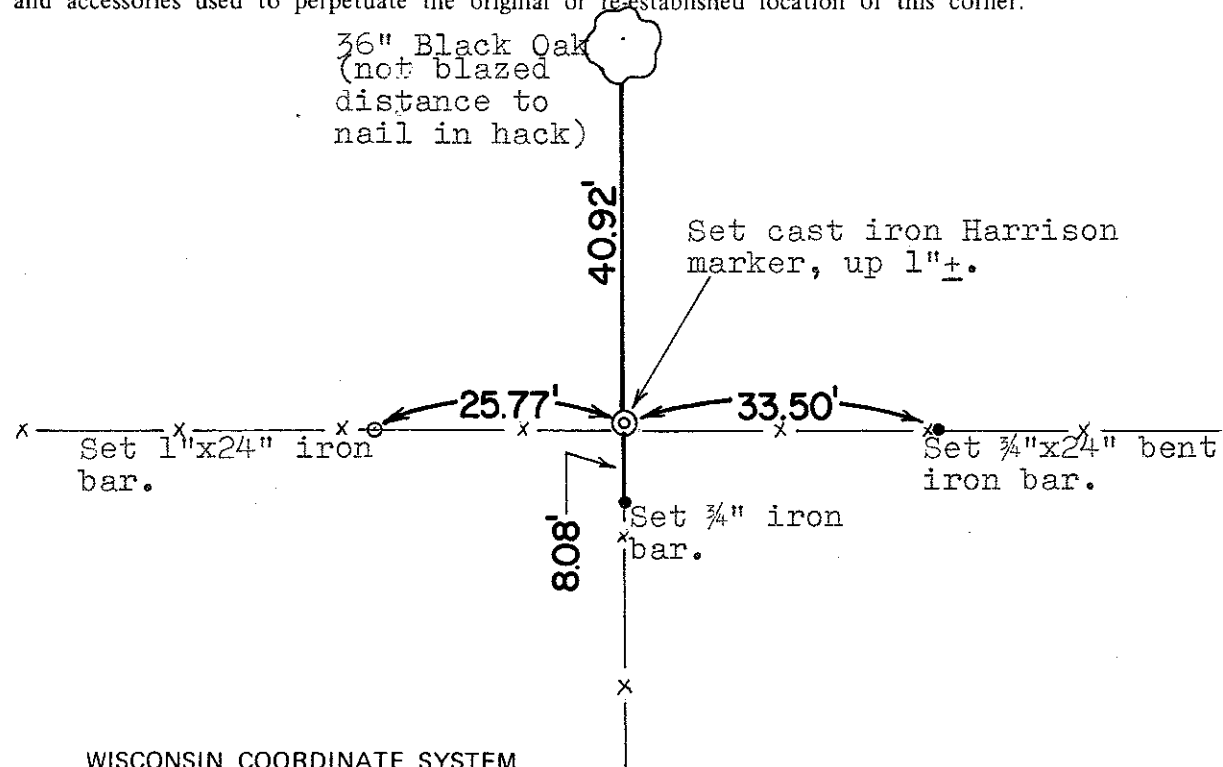

SURVEY CONTROL ORDER

Horizontal	_____
Vertical	_____

WISCONSIN COORDINATE SYSTEM

Corner	East (X)	North (Y)	Elevation (Z)	Zone
Control Sta. Name				

~~Village~~ Town of Ridgeville
County of Monroe