

CERTIFICATE

CERTIFIED LAND CORNER

No. 63

2160214000

I, Bryan H. Meyer, do hereby certify that on the 7th day of June 19 85, I found (evidence) ~~_____~~ of the Northeast corner of Section 23, T 16 N, R 2 W Fourth Principal Meridian, and I re-established said corner according to the Wisconsin Statutes as shown and described hereon.

Dated this 4th day of Feb. 19 86.

Bryan H. Meyer
Deputy County Surveyor
Title

History of corner establishment since Original Government Survey

Nothing Recorded.

Description of corner evidence found:

I accepted the intersection of the centerline of C.T.H. "U" with the fenceline projections from the North and South as the best available evidence.

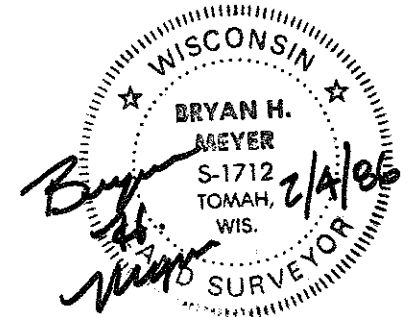

COUNTY SURVEYOR FORM NO. 1

Description of corner and witness monuments, references and accessories used to perpetuate the original or re-established location of this corner:

Crew: Meyer, Lund
Date: June 7, 1985 - 2:00 P.M.
Weather: P. Cloudy, Windy, 75°±
Witnesses to corner location:

Bryan H. Meyer

James Lund

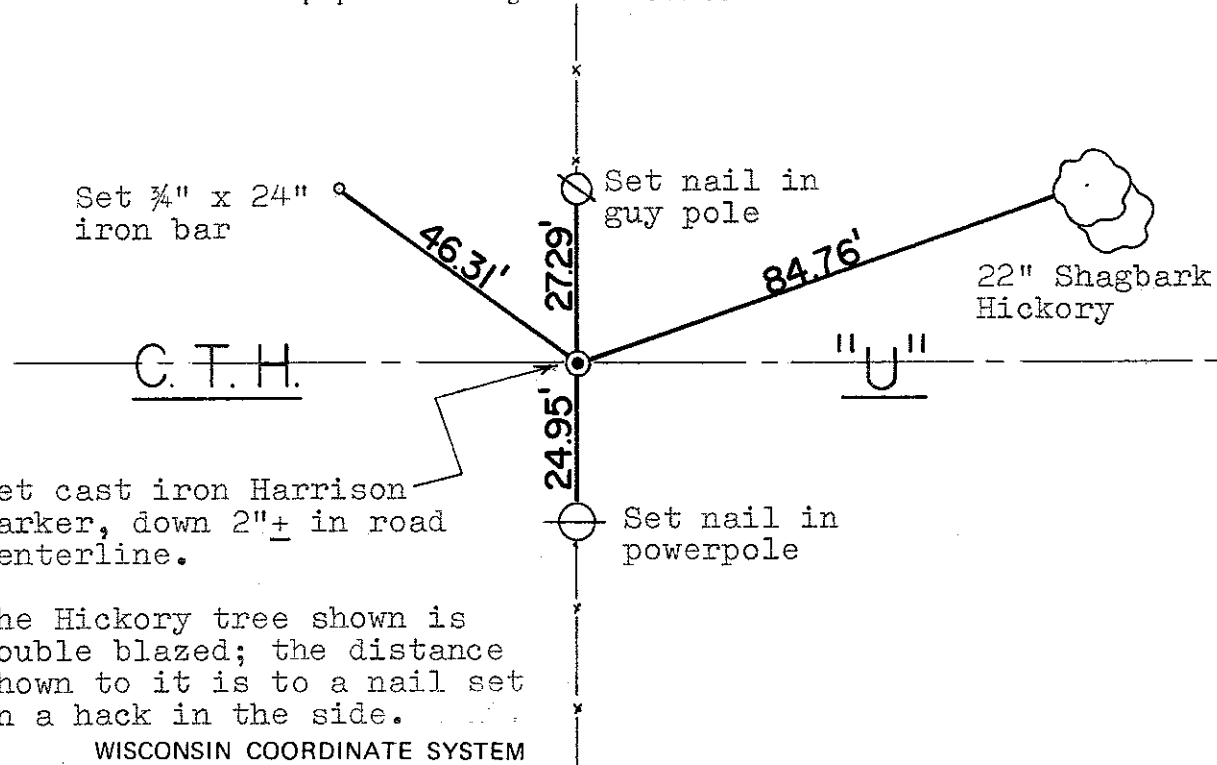

Set cast iron Harrison marker, down 2"± in road centerline.

The Hickory tree shown is double blazed; the distance shown to it is to a nail set in a hack in the side.

WISCONSIN COORDINATE SYSTEM

SURVEY CONTROL ORDER

Horizontal	_____
Vertical	_____

Corner	East (X)	North (Y)	Elevation (Z)	Zone
Control Sta. Name				

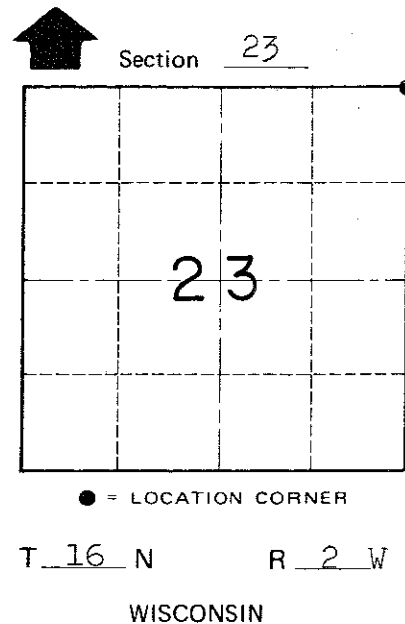

~~_____~~ Town of Ridgeville

County of Monroe