

CERTIFICATE

CERTIFIED LAND CORNER

No. 102

21602250020

I, Garold A. Sime, do hereby certify that on the 21st day of June 1976, I found (evidence) ~~(no evidence)~~ of the S/4 corner of Section 25, T16 N, R2 W Fourth Principal Meridian, and I re-established said corner according to the Wisconsin Statutes as shown and described hereon.

History of corner establishment since Original Government Survey

No known recorded history since the original government survey.

Description of corner evidence found:

Accepted fence corner as the best available evidence. Set a Harrison marker.



Dated this 12th day of March 1981.

Garold A. Sime

Garold A. Sime, R.L.S. 1261
Title

COUNTY SURVEYOR FORM NO. 1

Description of corner and witness monuments, references and accessories used to perpetuate the original or re-established location of this corner:

Witnesses to corner location:

G. Sime

B. Meyer

D. Dade

**Approved: HARLEY A. SIME
MONROE CO. SURVEYOR**

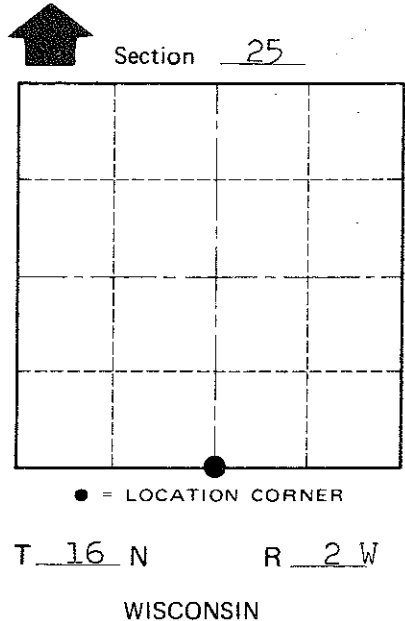
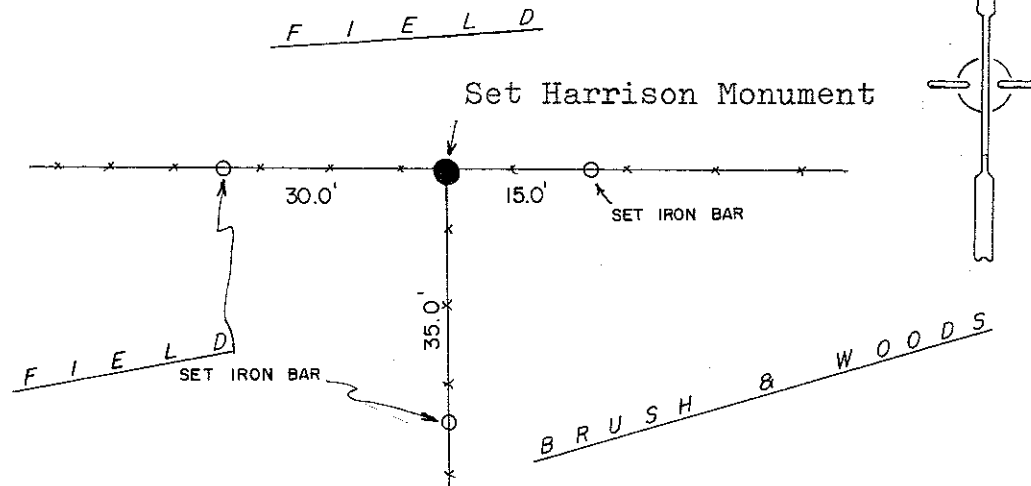

SURVEY CONTROL ORDER

Horizontal	_____
Vertical	_____

WISCONSIN COORDINATE SYSTEM

Corner	East (X)	North (Y)	Elevation (Z)	Zone
Control Sta. Name				

~~City, Village or~~ Town Ridgeville

County of Monroe