

CERTIFICATE

CERTIFIED LAND CORNER

No. 91

21602190000

I, Bryan H. Meyer, do hereby certify that on the 3rd day of January 19 84, I found (evidence) ~~the evidence~~ of the Southeast corner of Section 19, T 16 N, R 2 W Fourth Principal Meridian, and I re-established said corner according to the Wisconsin Statutes as shown and described hereon.

History of corner establishment since Original Government Survey

Nothing Recorded.

Description of corner evidence found:

Accepted 3-way fence corner as the best available evidence.

Dated this 4th day of Jan. 19 84.

Bryan H. Meyer
Deputy County Surveyor
Title

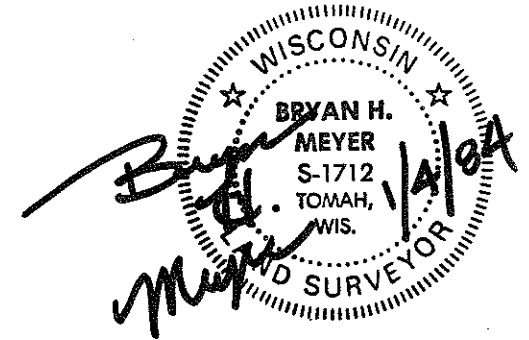

COUNTY SURVEYOR FORM NO. 1

Description of corner and witness monuments, references and accessories used to perpetuate the original or re-established location of this corner:

Crew: Meyer, Perrigo
Date: January 3, 1984 - 11:00 A.M.
Weather: Windy, Cloudy, 30°±
Witnesses to corner location:

Bryan H. Meyer

Dennis Perrigo

APPROVED: Harley A. Sime
Monroe County Surveyor

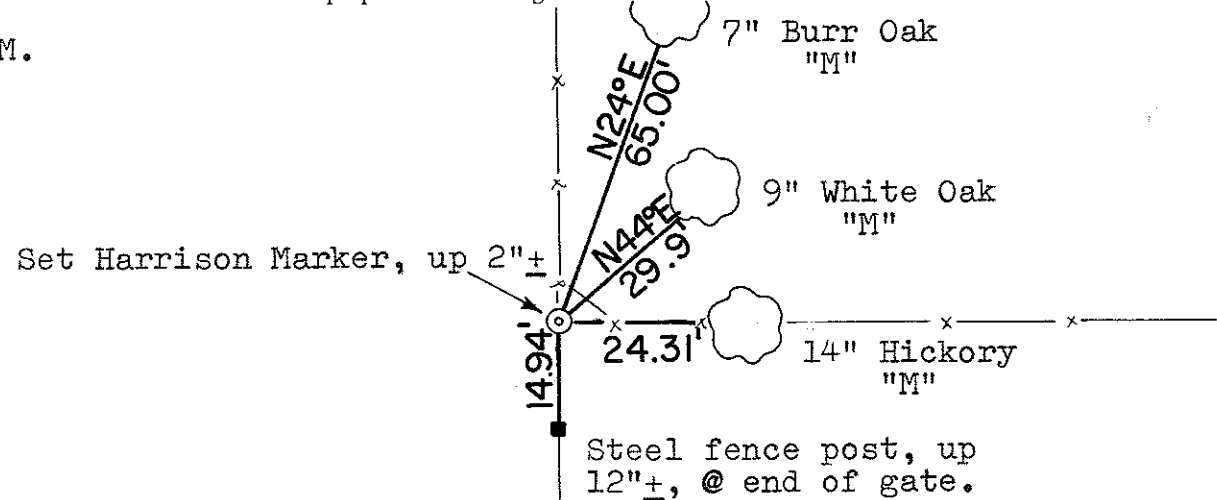

All three bearing trees are double blazed with the blazes facing the corner; each distance shown is to a nail set in a hack in the side of each tree; each tree is also scribed.

The bearings shown are hand compass bearings.

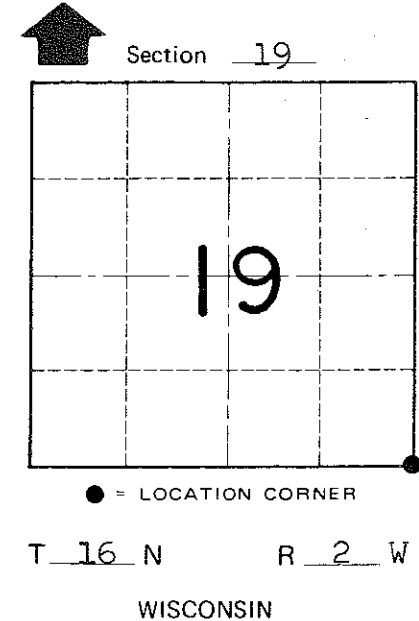

SURVEY CONTROL ORDER

Horizontal	_____
Vertical	_____

WISCONSIN COORDINATE SYSTEM

Corner	East (X)	North (Y)	Elevation (Z)	Zone
Control Sta. Name				

~~City of~~ Town of Ridgeville
County of Monroe