

21602320000

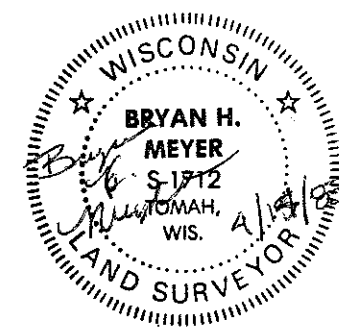

I, Bryan H. Meyer, do hereby certify that on the 14th day of April, 1983, I found (evidence) ~~no evidence~~ of the Southwest corner of Section 33, T 16 N, R 2 W Fourth Principal Meridian, and I re-established said corner according to the Wisconsin Statutes as shown and described hereon.

Dated this 14th day of April 19 83.

Bryan H. Meyer
Deputy County Surveyor
Title

History of corner establishment since Original Government Survey
Henry Schroeder was here in April of 1883. Fred Holden was here in June of 1904 and set a stone with a cross at the corner. O. O. Bergman was apparently here in September of 1936. "Duke" Marten was here in August of 1974 and found Holden's stone.

Description of corner evidence found:
Found Holden's stone with cross still clearly visable. Also found stump of original government bearing tree with scar still evident.

Approved: **HARLEY A. SIME**
MONROE CO. SURVEYOR

COUNTY SURVEYOR FORM NO. 1

Description of corner and witness monuments, references and accessories used to perpetuate the original or re-established location of this corner:

The White Oak, Basswood, and Box Elder bearing trees are double blazed with each distance to a nail in a hack on the side of the tree. They are also scribed "M" in the Witnesses to corner location: upper blaze.

Bryan H. Meyer
Bryan H. Meyer - R. L. S. 1712

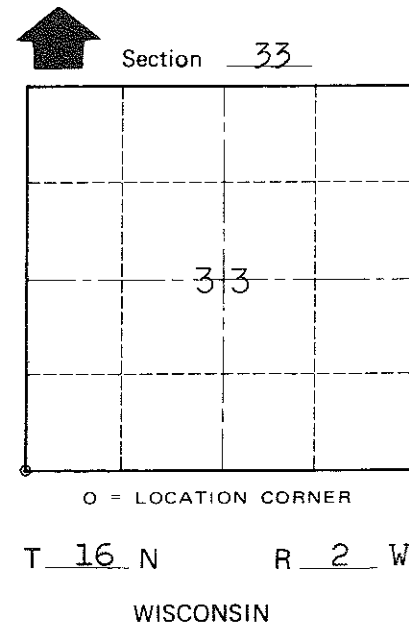
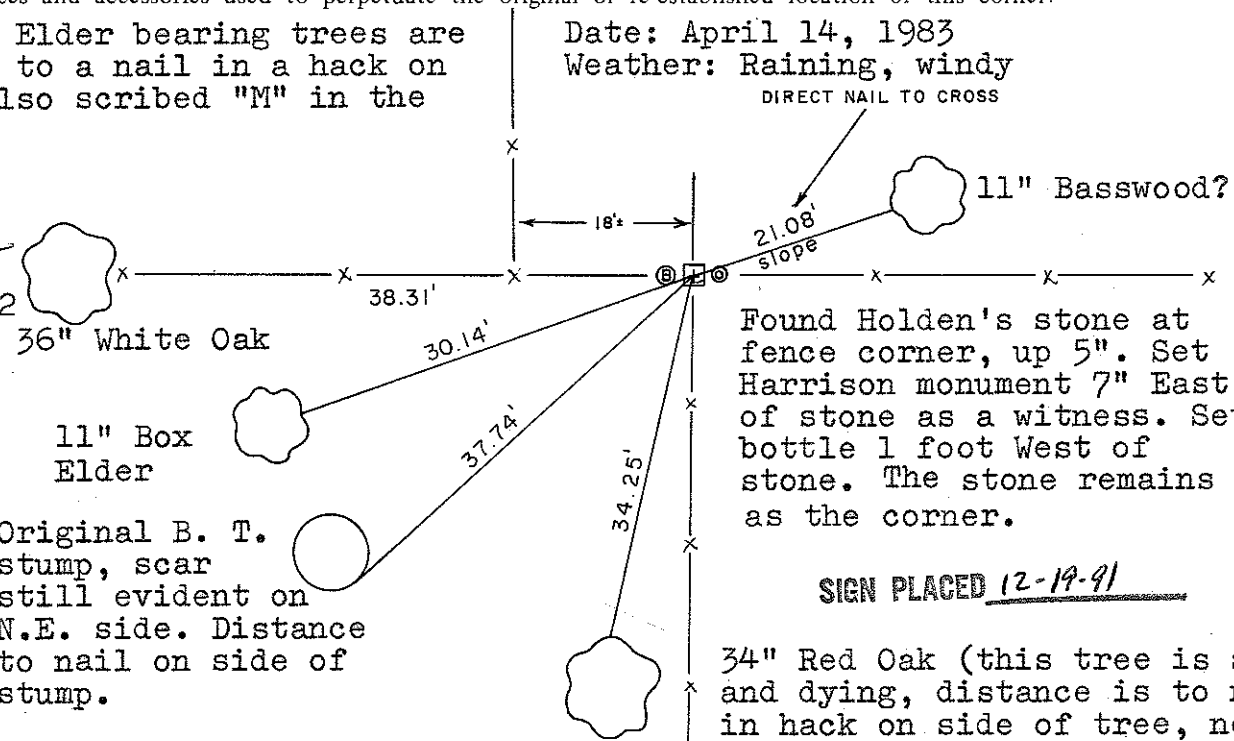

SURVEY CONTROL ORDER

| | |
|------------|-------|
| Horizontal | _____ |
| Vertical | _____ |

WISCONSIN COORDINATE SYSTEM

| Corner | East (X) | North (Y) | Elevation (Z) | Zone |
|-------------------|----------|-----------|---------------|------|
| Control Sta. Name | | | | |

~~Village of~~ Town of Ridgeville
County of Monroe