

21602310020

I, Garold A. Sime, do hereby certify that on the 11th day of December 1990, I found (evidence) (~~XXXXXXXX~~) of the S 1/4 corner of Section 31, T 16 N, R 2 W Fourth Principal Meridian, and I re-established said corner according to the Wisconsin Statutes as shown and described hereon.

Dated this 26th day of March 1991.

Garold A. Sime

Monroe County Surveyor
Title

History of corner establishment since Original Government Survey

No history of corner location recorded since the Original Government Survey.

Description of corner evidence found:

I accepted the existing fence corner as the best available evidence for corner location.

Description of corner and witness monuments, references and accessories used to perpetuate the original or re-established location of this corner:

Set cast iron Harrison Monument at corner.
Set guard sign next to corner.

Witnesses to corner location:

Bryan H. Meyer, R.L.S.

John F. Kenworthy

COUNTY SURVEYOR FORM NO. 1

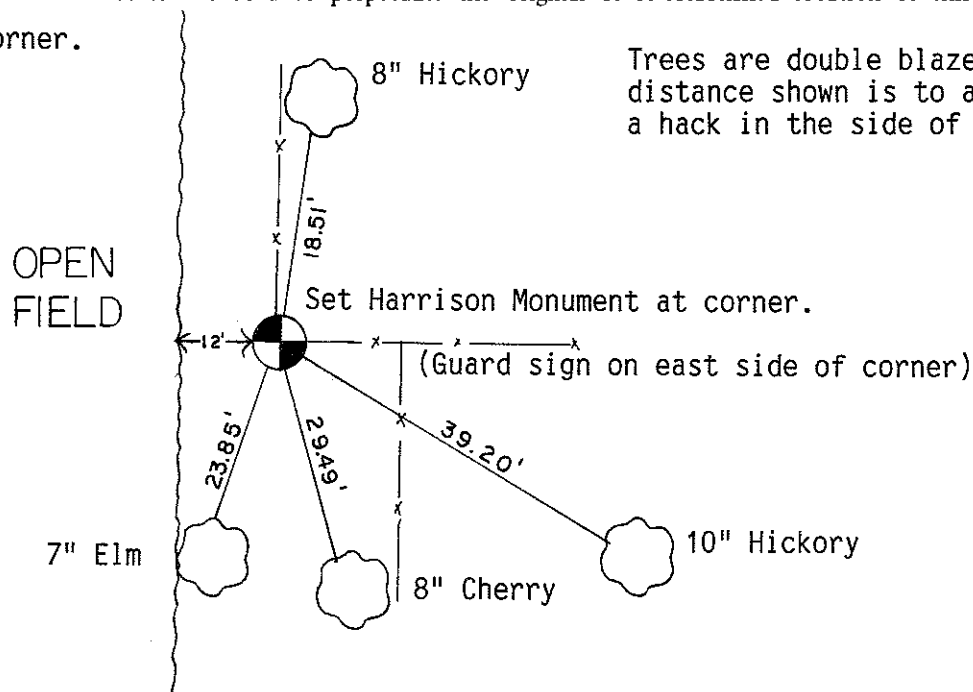
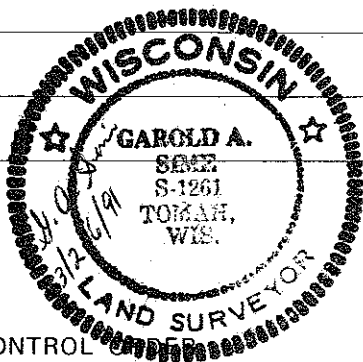

Trees are double blazed and the distance shown is to a nail set in a hack in the side of the tree.

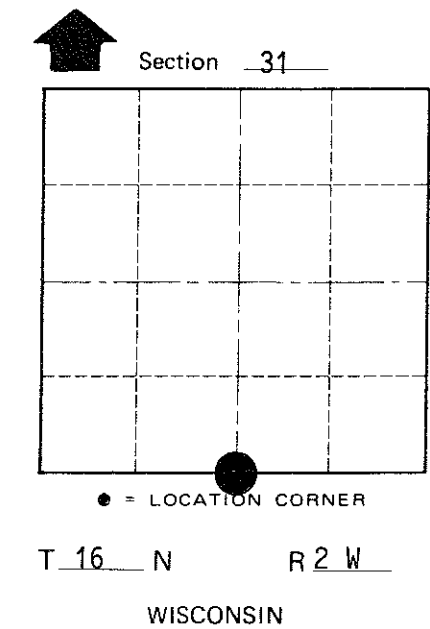
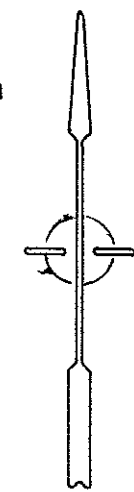

SURVEY CONTROL

Horizontal	_____
Vertical	_____

WISCONSIN COORDINATE SYSTEM

Corner	East (X)	North (Y)	Elevation (Z)	Zone
Control Sta. Name				

City, Village or Town of Ridgeville

County of Monroe