

21602262000

I, Lawrence A. Feddersen do hereby certify that on the 3rd day of June 19 80, I found ~~XXXXXX~~ (no evidence) of the East 1/4 corner of Section 26-, T 16 N, R 2 W Fourth Principal Meridian, and I re-established said corner according to the Wisconsin Statutes as shown and described hereon.

Dated this 5th day of June 19

Lawrence A. Feddersen

Registered Land Surveyor
Title

History of corner establishment since Original Government Survey

There is no subsequent history of monument perpetuation since the original U. S. Government Survey in Monroe County.

Description of corner evidence found:

A Harrison monument was set at the intersection of old fenceslines to the North and West and East.

Description of corner and witness monuments, references and accessories used to perpetuate the original or re-established location of this corner:

Witnesses to corner location:

Lawrence Feddersen
Mark Heidecke

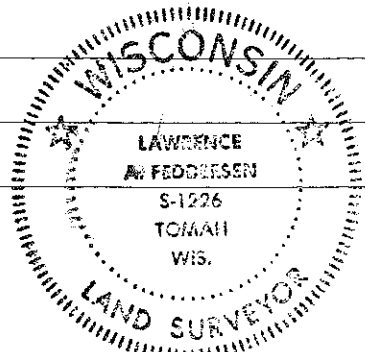

Nail and Washer in Blaze in 18" Red Oak

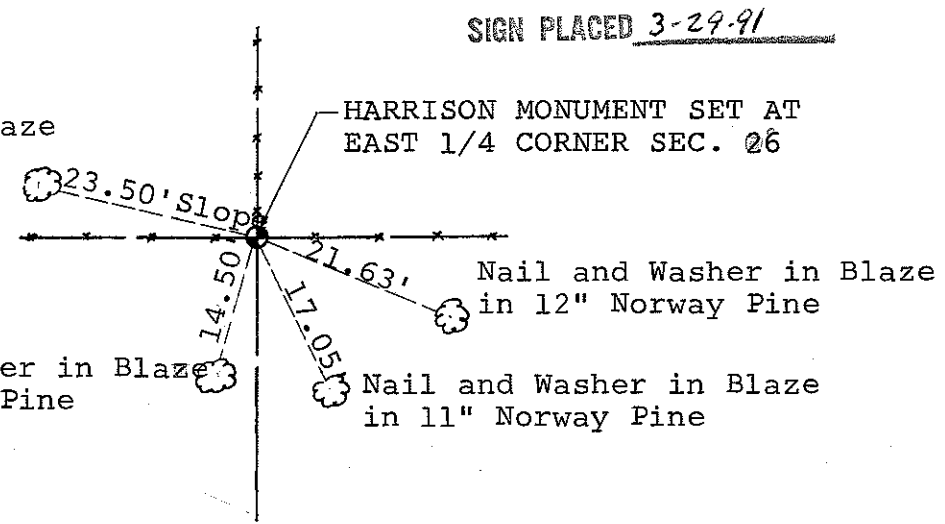

Nail and Washer in Blaze in 8" Norway Pine

Section 26

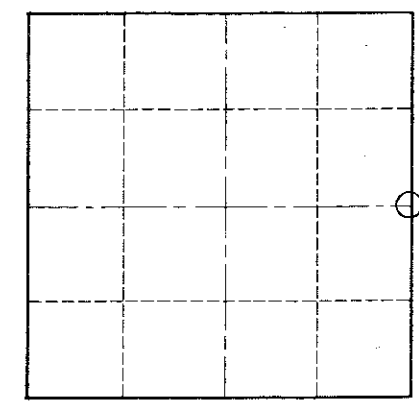

O = LOCATION CORNER

T 16 N R 2 W

WISCONSIN

COUNTY SURVEYOR FORM NO. 1

SURVEY CONTROL ORDER

Horizontal _____
Vertical _____

WISCONSIN COORDINATE SYSTEM

Corner	East (X)	North (Y)	Elevation (Z)	Zone
Control Sta. Name				

~~XXXXXX~~ Town OF RIDGEVILLE

County of MONROE