

21602362000

I, Bryan H. Meyer, do hereby certify that on the 17th day of November 1983, I found (evidence) ~~XXXXXXXXXX~~ of the East 1/4 corner of Section 36, T 16 N, R 2 W Fourth Principal Meridian, and I re-established said corner according to the Wisconsin Statutes as shown and described hereon.

Dated this 14th day of Dec. 1983.

Bryan H. Meyer
Deputy County Surveyor
Title

History of corner establishment since Original Government Survey

Nothing recorded.

Description of corner evidence found:

Accepted fence corner as the best available evidence.

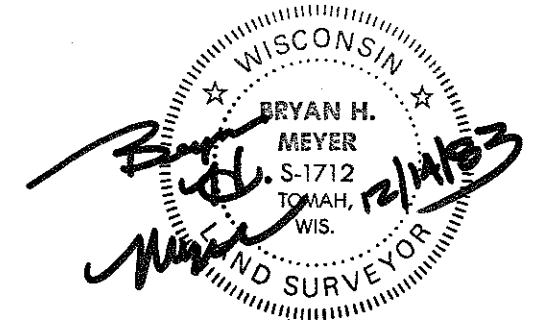

COUNTY SURVEYOR FORM NO. 1

Description of corner and witness monuments, references and accessories used to perpetuate the original or re-established location of this corner:

Crew: Meyer, Perrigo
Date: November 17, 1983
Weather: P. Cloudy, Calm, 30°±.
Witnesses to corner location:

Bryan H. Meyer

Dennis Perrigo

APPROVED: Harley A. Sime
Monroe County Surveyor

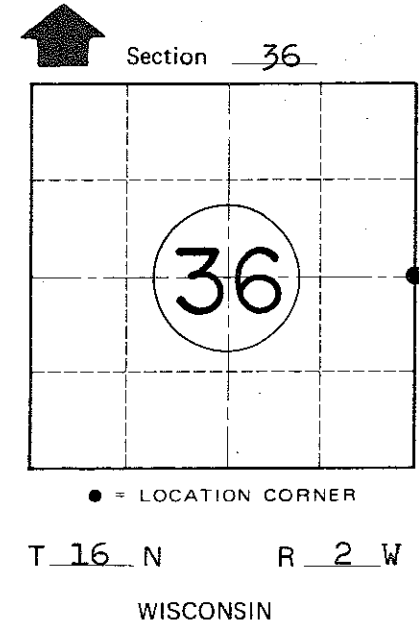
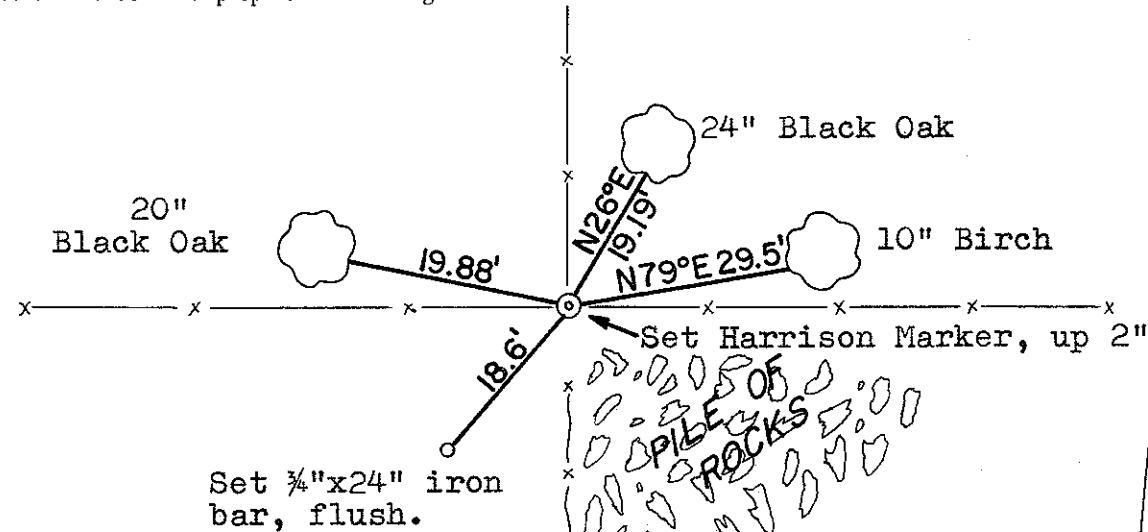

The trees shown are double blazed; distances are to nails in hacks in the sides of the trees. The bearings shown are hand compass bearings.

WISCONSIN COORDINATE SYSTEM

SURVEY CONTROL ORDER

Horizontal	_____
Vertical	_____

Corner	East (X)	North (Y)	Elevation (Z)	Zone
Control Sta. Name				

~~City, Village or~~ Town of Ridgeville

County of Monroe