

21602350020

I, Bryan H. Meyer, do hereby certify that on the 17th day of November 1983, I found (evidence) ~~(no evidence)~~ of the North 1/4 corner of Section 2, T 15 N, R 2 W Fourth Principal Meridian, and I re-established said corner according to the Wisconsin Statutes as shown and described hereon.

Dated this 14th day of Dec. 1983.
Bryan H. Meyer
Deputy County Surveyor
Title

History of corner establishment since Original Government Survey

Nothing recorded.

Description of corner evidence found:

Accepted fence corner as the best available evidence. This location fits road records very well.

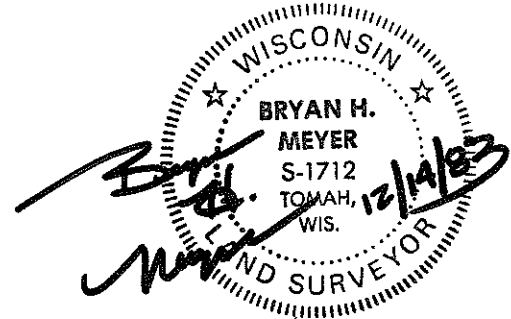

COUNTY SURVEYOR FORM NO. 1

Description of corner and witness monuments, references and accessories used to perpetuate the original or re-established location of this corner:

Crew: Meyer, Perrigo
Date: November 17, 1983 - 12:30 P.M.
Weather: P. Cloudy, Calm, 30°±
Witnesses to corner location:

Bryan H. Meyer

Dennis Perrigo

APPROVED: Harley A. Sime
Monroe County Surveyor

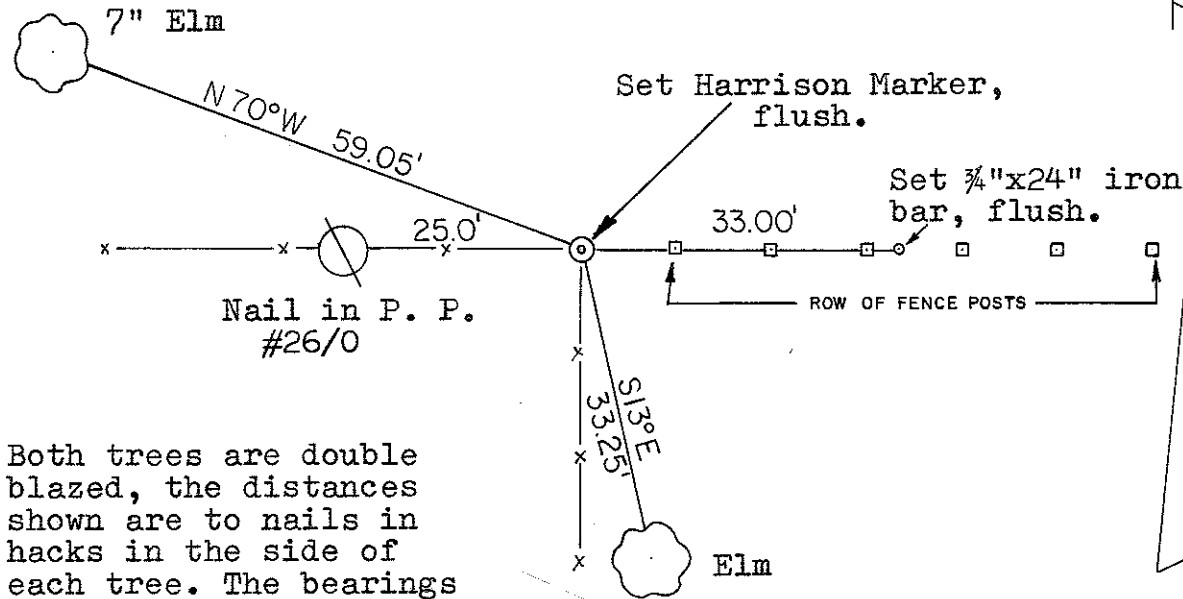

Both trees are double blazed, the distances shown are to nails in hacks in the side of each tree. The bearings shown are hand compass bearings.

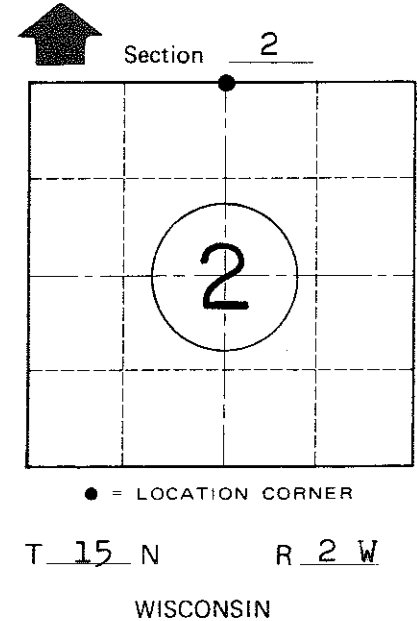

SURVEY CONTROL ORDER

Horizontal	_____
Vertical	_____

WISCONSIN COORDINATE SYSTEM

Corner	East (X)	North (Y)	Elevation (Z)	Zone
Control Sta. Name				

~~City/Village of~~ Town of Sheldon
County of Monroe