

21602340000

I, Bryan H. Meyer, do hereby certify that on the 27<sup>th</sup> day of January 1984, I found ~~evidence~~ (no evidence) of the Northeast corner of Section 3, T 15 N, R 2 W Fourth Principal Meridian, and I re-established said corner according to the Wisconsin Statutes as shown and described hereon.

History of corner establishment since Original Government Survey

Nothing Recorded.

Description of corner evidence found:

I set this corner equidistant between the North 1/4 corner Of Section 3 and the North 1/4 corner of Section 2 and in the centerline of a Town Road.

Dated this 7<sup>th</sup> day of Feb. 1984.  
Bryan H. Meyer  
Deputy County Surveyor  
Title

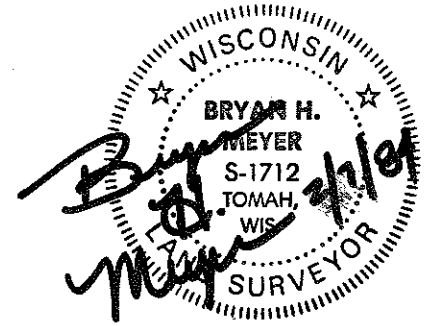

COUNTY SURVEYOR FORM NO. 1

Description of corner and witness monuments, references and accessories used to perpetuate the original or re-established location of this corner:

Crew: Meyer, Perrigo  
Date: January 27, 1984 - 2:30 P.M.  
Weather: Clear, 15°±.  
Witnesses to corner location:

Bryan H. Meyer  
Dennis Perrigo

Set drill hole in SCS 1937 erosion control device.

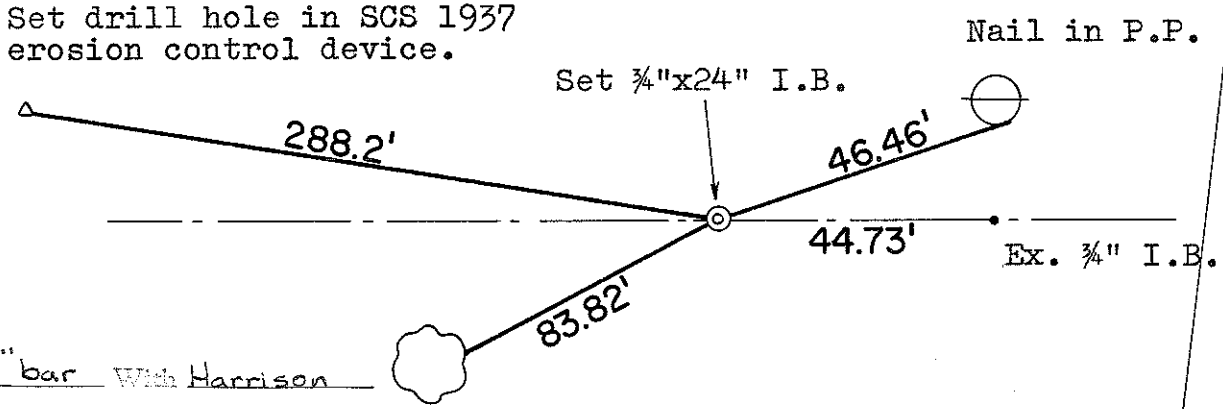

APPROVED: Harley A. Sime  
Monroe County Surveyor

Replaced 3/4" bar With Harrison  
On 9/18/84. Crew: Wilhite, Lund  
Comments: Harrison is down  
1"±  
10" poplar-double blazed; distance is to ~~the~~ a nail set in a hack in the side of the tree.

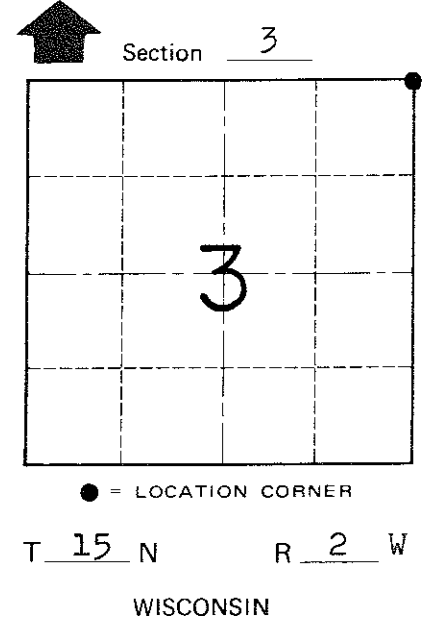

SURVEY CONTROL ORDER

Horizontal \_\_\_\_\_  
Vertical \_\_\_\_\_

WISCONSIN COORDINATE SYSTEM

Corner	East (X)	North (Y)	Elevation (Z)	Zone
Control Sta. Name				

~~City/Village~~ Town of Sheldon  
County of Monroe