

49

**U.S. PUBLIC LAND CORNER
MAINTENANCE**

Corner ID : SE Sec.8, T16N-R1W

21601080000

<u>DATE</u>	<u>CREW</u>	<u>MONUMENT TYPE</u>
July 24, 2014	Zachariah P. Dechant Gary L. Dechant	Found Harrison in tact. Placed concrete, with 6" anchor, around Harrison at fence corner. 12' north of fence corner. Sign 1' west.

References:

- 1) Set 1/2"x2"x18" flat bar, 2' east of fence
- 2) 40d penny nail in 8" Maple
- 3) 8" Apple with 40d nail
- 4) Set 3/4"x24" hex bar north side of rock
- 5) Set 18" T-post, 2' west of fence

<u>Bearing</u>	<u>Distance</u>
N5E	14.34
N35E	34.55'
East	7.17'
East	21.21'
S5W	7.39'

COORDINATES:

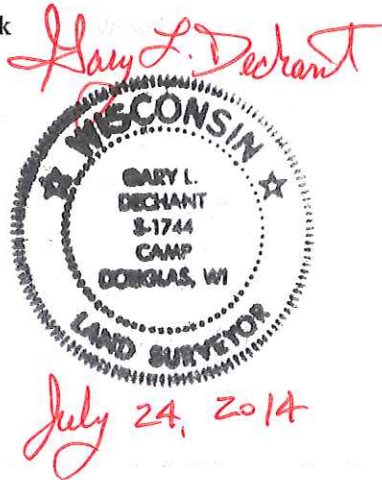

I, William C. Jung, do hereby certify that on the 19th day of April 1983, I found (evidence) ~~(no evidence)~~ of the Southwest corner of Section 9, T 16 N, R 1 W Fourth Principal Meridian, and I re-established said corner according to the Wisconsin Statutes as shown and described hereon.

Dated this 2nd day of March 1984.

William C. Jung

Deputy County Surveyor, R.L.S. 1323

Title

History of corner establishment since Original Government Survey

In Holden's notes of December, 1901, and March, 1902, Fred Holden calls for a dragtooth at this corner. One of his bearing trees was a 20" white oak, S53°E, 36 links. In December of 1895, Kenyon (or Schroeder?) was at this corner. Nothing else on record since the original survey.

Description of corner evidence found:

On the 5th of April I found Holden's dragtooth. I also found his bearing tree in the Southeast quadrant, although my distance is longer than Holden's. Holden's distance to the center would have been about 24.6'. There appeared to have been a scar on the NW side of the tree. I cut into the tree and found what appeared to me to be evidence of an overgrown scar. I removed the dragtooth and replaced it with a Harrison marker. The dragtooth measured 1"x11".

See Reverse Side For Maintenance

COUNTY SURVEYOR FORM NO. 1

Description of corner and witness monuments, references and accessories used to perpetuate the original or re-established location of this corner:

Witnesses to corner location:

William C. Jung

Bryan Meyer

Witness: Myron Pergande

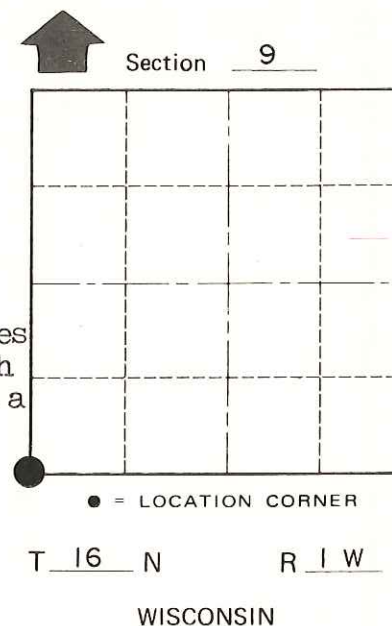
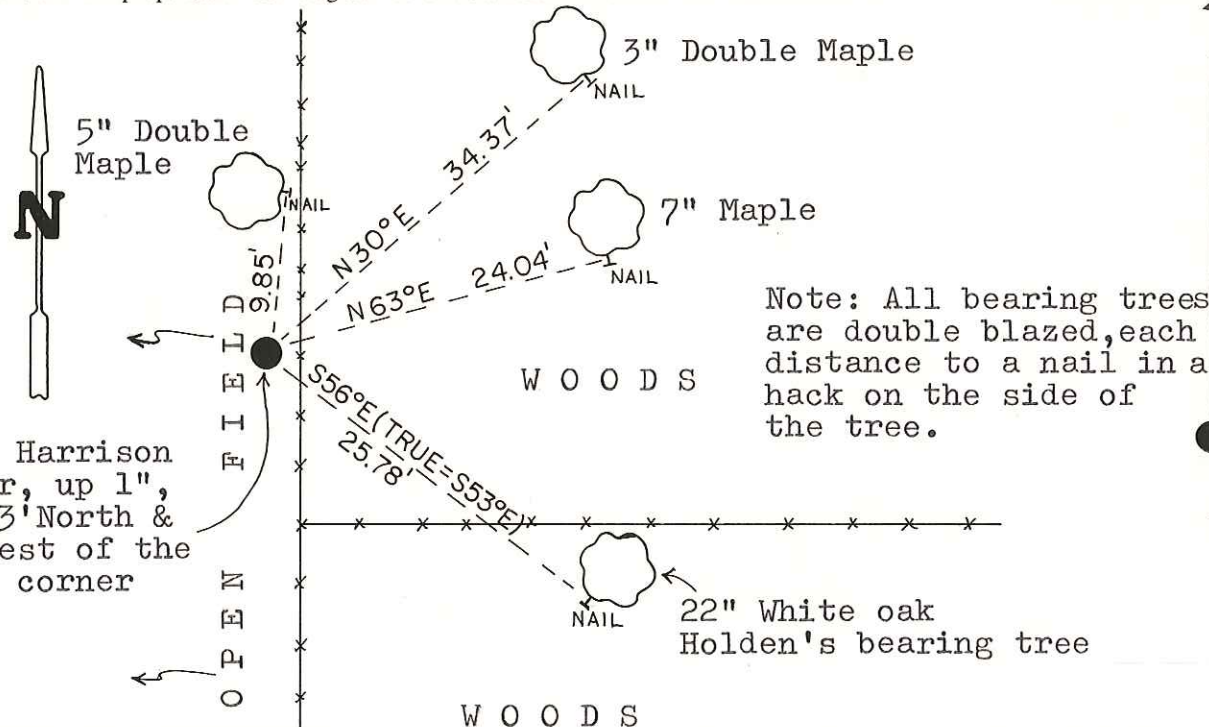
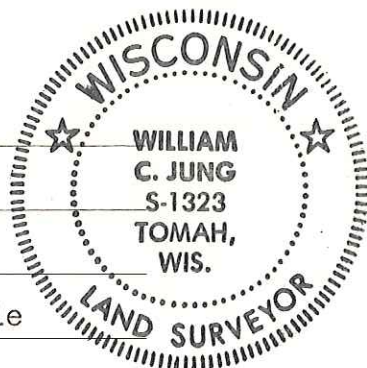

Approved: **HARLEY A. SIME**
MONROE CO. SURVEYOR

SURVEY CONTROL ORDER

Horizontal	_____
Vertical	_____

Corner	East (X)	North (Y)	Elevation (Z)	Zone
Control Sta. Name				

City, Village or Town of Wilton
County of Monroe
Wisconsin