

21601312000

I, Harley A. Sime, do hereby certify that on the 17th day of March 1978, I found (evidence) (~~no evidence~~) of the W 1/4 corner of Section 32, T 16 N, R 1 W, Fourth Principal Meridian, and I re-established said corner according to the Wisconsin Statutes as shown and described hereon.

History of original corner establishment:

No known recorded history since the original government survey.

Description of corner evidence found:

D. Marten in June of 1973 accepted a 3-way fence as the best available evidence for the corner and set a Harrison Monument.

Dated this 20th day of March 1978.

Harley Sime

County Surveyor

Title

Approved: **HARLEY A. SIME**  
**MONROE CO. SURVEYOR**

COUNTY SURVEYOR FORM NO. 1

Description of corner and witness monuments, references and accessories used to perpetuate the original or re-established location of this corner:

Witnesses to corner location:

C. Pietz, Crew Chief

G. Dechant

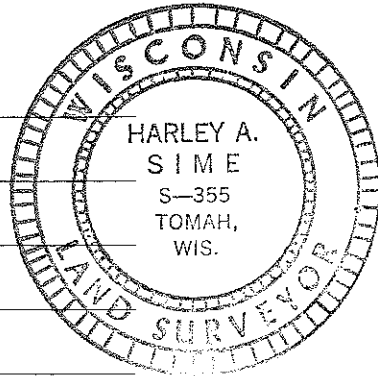

(All trees are double blazed and with nail & cap)

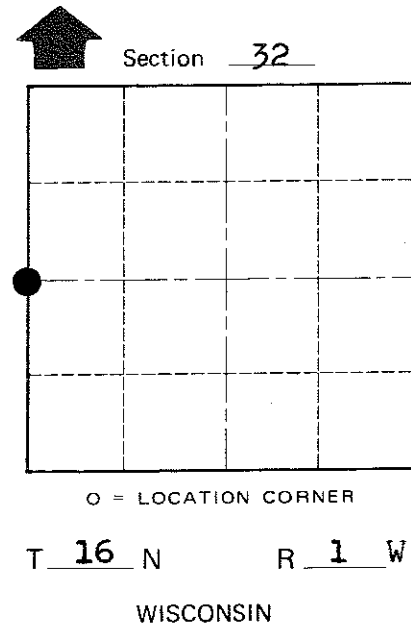
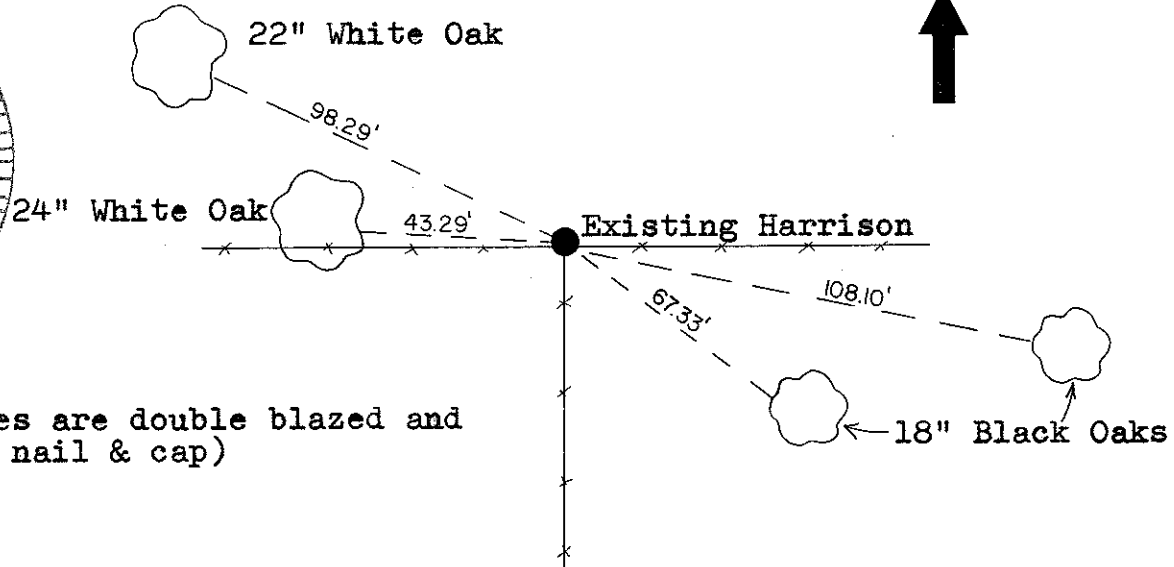

SURVEY CONTROL ORDER

Horizontal \_\_\_\_\_  
Vertical \_\_\_\_\_

WISCONSIN COORDINATE SYSTEM

Corner	East (X)	North (Y)	Elevation (Z)	Zone
Control Sta. Name				

City, Village or Town Wilton  
County of Monroe